

1792

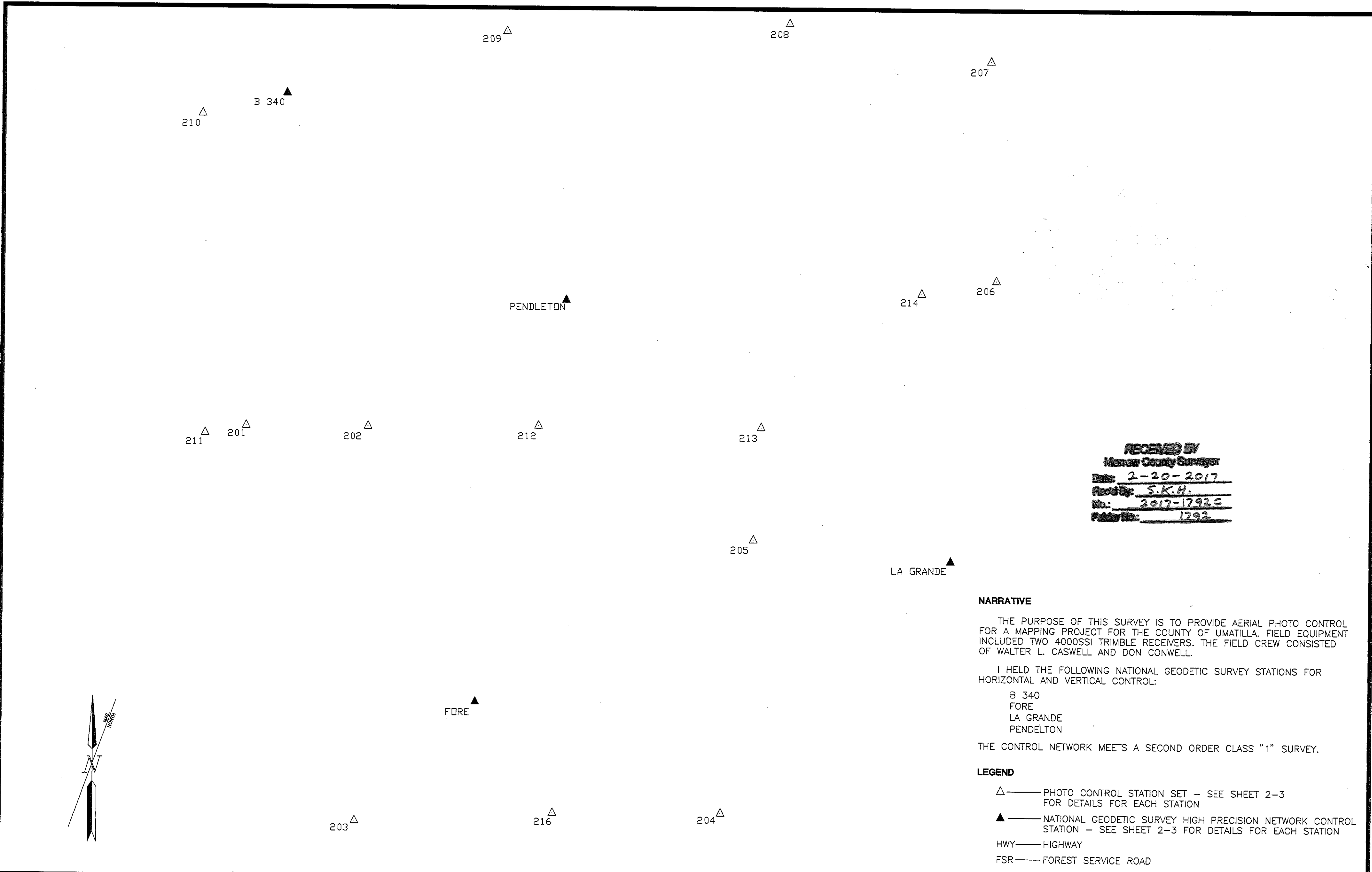

RECEIVED BY
Morrow County Surveyor
 Date: 2-20-2017
 Recd By: S.K.H.
 No.: 2017-1792C
 Folder No.: 1792

NARRATIVE

THE PURPOSE OF THIS SURVEY IS TO PROVIDE AERIAL PHOTO CONTROL FOR A MAPPING PROJECT FOR THE COUNTY OF UMATILLA. FIELD EQUIPMENT INCLUDED TWO 4000SSI TRIMBLE RECEIVERS. THE FIELD CREW CONSISTED OF WALTER L. CASWELL AND DON CONWELL.

I HELD THE FOLLOWING NATIONAL GEODETIC SURVEY STATIONS FOR HORIZONTAL AND VERTICAL CONTROL:

- B 340
- FORE
- LA GRANDE
- PENDELTON

THE CONTROL NETWORK MEETS A SECOND ORDER CLASS "1" SURVEY.

LEGEND

SURVEYOR: W.L.C.
 DRAWN BY: B.S.S.
 DATE: 11/13/98
 SCALE: 1"=30,000'
 JOB NO. 98-004
 SHEET 1 OF 3

PHOTO CONTROL SURVEY
 FOR THE COUNTY OF UMATILLA
 LOCATED IN T.1S, R.27E; T.1S, R.28E; T.1S, R.32E; T.1S, R.35E;
 T.2S, R.35E; T.2N, R.32E; T.2N, R.38E; T.2N, R.39E; T.3S, R.38E;
 T.5S, R.31E; T.5N, R.27E; T.5N, R.28E; T.6N, R.31E; T.6N, R.36E;
 T.6N, R.39E; T.7S, R.29E; T.7S, R.32E; T.7S, R.35E
 IN GRANT, MORROW, UNION, UMATILLA AND WALLOWA COUNTY, OREGON;
 WALLA WALLA AND BENTON COUNTY, WASHINGTON



EAGLE
 GPS SURVEY CORPORATION
 6110 S.W. LOMBARD AVE
 BEAVERTON, OREGON 97008
 (503) 643-1073

REGISTERED PROFESSIONAL LAND SURVEYOR
Walter L. Caswell
OREGON
JULY 6, 1966
 WALTER L. CASWELL
 737
 EXPIRES 12/31/99

NO.	REVISION	DATE	BY

1792

UMATILLA COUNTY GROUND CONTROL
 DATUM: NAD83(91) NGVD29
 ZONE : 3601 OREGON NORTH
 STATE PLANE IN: INTERNATIONAL FEET

RECEIVED BY
Morrow County Surveyor
 Date: 2-20-2017
 Recd By: S.K.H.
 No: 2017-1792C
 Folder No: 1792

LATITUDE (N)	LONGITUDE (W)	NGVD 29(47) HEIGHT (M)	NAD 83(91) (INTL FEET)		NGVD 29 HEIGHT (USft)	CONVERGENCE	SCALE FACTOR	NAME	7 1/2 MIN. QUAD	1/4	SEC	TWN	RGE	STATION DESCRIPTION-TO REACH STATEMENT
			NORTHING	EASTING										
45°30'20.571"	119°22'54.482"	514.688	672454.198	8488769.549	1688.606	0°47'34.840"	0.999911854	201	BUTTER CREEK JUNCTION-OR	NW	7	1S	28E	5/8" IRON ROD WITH YELLOW PLASTIC CAP INSCRIBED "EAGLE GPS CONTROL STA"- FROM PINE CITY GO SOUTHERLY ON LITTLE BUTTER CREEK ROAD 7.8 MILES TO HOUSE NUMBER NUMBER 65184 TO WEST. TURN EAST INTO DRIVEWAY AND PROCEED TO BARN, STATION IS LOCATED ACROSS ROAD SOUTHWESTERLY OF BARN.
45°30'11.561"	119°09'10.388"	564.568	672437.204	8547466.107	1852.254	0°57'19.276"	0.999911598	202	ECHO SW-OR	SW	1	1S	27E	5/8" IRON ROD WITH YELLOW PLASTIC CAP INSCRIBED "EAGLE GPS CONTROL STA"- FROM PINE CITY GO SOUTHEASTERLY ON BIG BUTTER CREEK ROAD TO MILE POST 18. CONTINUE ON ROAD FOR 0.7 MILES TO STATION TO THE SOUTH. STATION IS 25.0' NW OF FENCE CORNER.
44°58'55.276"	119°11'05.830"	736.421	482309.240	8542338.433	2416.075	0°55'57.406"	0.999899868	203	RITTER-OR	SE	2	7S	29E	5/8" IRON ROD WITH YELLOW PLASTIC CAP INSCRIBED "EAGLE GPS CONTROL STA"- FROM THE INTERSECTION OF HWY'S 395 & 244, GO SOUTH ON HWY 395 11.5 MILES TO ROAD TO THE WEST AT THE NORTH EDGE OF THE CAMAS CREEK BRIDGE. GO WEST 10.9 MILES TO STATION TO THE SOUTH. STATION IS LOCATED 20 FEET SOUTH OF THE ROAD BETWEEN THE STONY CREEK BRIDGE AND A CATTLE GUARD.
44°59'06.070"	118°30'11.004"	1621.766	487018.060	8718706.849	5320.744	1°24'58.335"	0.999899699	204	SILVER BUTTE-OR	SE	4	7S	35E	5/8" IRON ROD WITH YELLOW PLASTIC CAP INSCRIBED "EAGLE GPS CONTROL STA"- FROM HWY 244, NEAR STARKEY, TAKE PRIMARY FOREST ROAD 51 SOUTH FOR 25.45 MILES TO THE INTERSECTION WITH PRIMARY FOREST ROAD 52. GO WEST ON FOREST ROAD 52 FOR 8.25 MILES TO THE STATION TO THE SOUTH OF A GRAVELED PARKING AREA, 0.1 MILES EAST OF A TRAILHEAD.
45°20'41.770"	118°25'58.456"	1339.346	618649.445	8733494.333	4394.171	1°27'57.438"	0.999899300	205	McINTYER CREEK-OR	SE	33	2S	35E	5/8" IRON ROD WITH YELLOW PLASTIC CAP INSCRIBED "EAGLE GPS CONTROL STA"- FROM I84 AND HWY 244, GO SOUTH ON HWY 244 13.5 MILES TO McINTYER CREEK ROAD. GO NORTHERLY ON McINTYER CREEK ROAD, TO FSR 21. TURN EAST AND GO 1.5 MILES± TO A SHARP TURN TO THE LEFT (NORTH) AND THE STATION TO THE SOUTH.
45°40'46.015"	117°57'57.473"	1136.142	743973.049	8849671.312	3727.493	1°47'49.568"	0.999934296	206	PARTRIDGE CREEK-OR	SW	5	2N	39E	5/8" IRON ROD WITH YELLOW PLASTIC CAP INSCRIBED "EAGLE GPS CONTROL STA"- FROM ELGIN HEAD WEST ON HWY 204 FOR 0.2 MILES TO 10TH ST., TURN NORTH AND GO 0.5 MILES TO HARTFORD LANE, TURN WEST AND GO 0.6 MILES TO MIDDLE ROAD, TURN NORTH AND GO 1.9 MILES TO GORDON CREEK ROAD, TURN WEST AND GO 0.6 MILES TO DARR ROAD, TURN AND GO NORTH FOR 2.7 MILES TO FORK IN ROAD, STAY TO LEFT, GO 1.25 MILES TO FORK, STAY RIGHT, GO 0.35 MILES TO FORK, STAY LEFT, GO 0.3 MILES TO FORK, STAY RIGHT, GO 0.2 MILES TO FORK, STAY RIGHT, GO 0.4 MILES TO FORK, STAY RIGHT, GO 0.15 MILES TO FORK, STAY TO LEFT, GO 0.45 MILES TO STATION ON LEFT, 30± FEET SOUTH OF ROAD.
45°58'10.226"	117°57'56.815"	1649.720	849690.718	8846400.870	5412.456	1°47'50.034"	0.999992389	207	BONE SPRING-OR	SW	29	6N	39E	5/8" IRON ROD WITH YELLOW PLASTIC CAP INSCRIBED "EAGLE GPS CONTROL STA"- FROM WALLA WALLA, WA GO EAST ON ROSE (ISAACS) AVE 3.8± MILES TO MILL CREEK ROAD TO RIGHT, TURN RIGHT (CROSSING RAILROAD TRACKS) AND GO 26 MILES ALONG MILL CREEK ROAD AND FSR 65, TO A SMALL CUT BANK TO THE WEST, NEAR THE CENTER OF SECTION 29 AND THE STATION.
46°01'32.724"	118°20'46.204"	266.226	867389.985	8749169.517	873.443	1°31'38.883"	1.000006652	208	WALLA WALLA-WA	SE	6	6N	36E	ROAD CENTERLINE STRIP AT SOUTH END OF BRIDGE (NO ADDITIONAL MONUMENT SET)- FROM NEAR WALLA WALLA, WA AT THE INTERSECTION OF HWY 125 AND THE OLD MILTON HWY, PROCEED EAST ON OLD MILTON HWY 2± MILES TO THE INTERSECTION WITH BRANDEN ROAD. TURN NORTH ON BRANDEN ROAD AND GO 1000± FT TO A CONCRETE BRIDGE OVER COTTONWOOD CREEK.
46°01'21.222"	118°52'55.513"	463.279	863047.531	8613091.480	1519.941	1°08'50.644"	1.000005816	209	WALLULA WA-OR	NW	12	6N	31E	5/8" IRON ROD WITH YELLOW PLASTIC CAP INSCRIBED "EAGLE GPS CONTROL STA"- FROM THE INTERSECTION OF HWY 730 AND HWY 12, LOCATED IN WALLA WALLA COUNTY, WA, GO SOUTH ON HATCH GRADE ROAD 2.5 MILES TO BRADEN RANCH ROAD TO THE RIGHT. TURN ON BRADEN RANCH ROAD AND PROCEED 1.0 MILES TO THE STATION ON LEFT, 4 FEET OFF OF EDGE OF ROAD.
45°55'08.184"	119°27'36.273"	85.742	822848.239	8466764.043	281.305	0°44'14.998"	0.999980400	210	IRRIGON WA-OR	NW	17	5N	27E	2" ALUMINUM CAP INSCRIBED "USCEC 92H-04-11 1992"- FROM THE INTERSECTION OF I-82 AND SR-14 IN WASHINGTON, GO WESTERLY ON SR-14 TO MILE POST 174, CONTINUE WESTERLY 0.15 MILES TO CHRISTY ROAD. TURN AND GO SOUTH AND EAST, ON CHRISTY ROAD, TO A RAILROAD CROSSING. TURN RIGHT, JUST AFTER TRACKS, AND FOLLOW GRAVEL ROAD, WHICH PARALLELS THE TRACKS, WEST 1.7 MILES TO STATION TO THE SOUTH. STATION IS 3' SOUTH OF ROAD, 3' EAST OF WITNESS POST AND 400' WEST OF NAVIGATION LIGHT.

SURVEYOR: W.L.C.
 DRAWN BY: B.S.S
 DATE: 11/13/98
 JOB NO. 98-004
 SHEET 2 OF 3

PHOTO CONTROL SURVEY
 FOR THE COUNTY OF UMATILLA
 LOCATED IN T.1S, R.27E; T.1S, R.28E; T.1S, R.32E; T.1S, R.35E;
 T.2S, R.35E; T.2N, R.32E; T.2N, R.38E; T.2N, R.39E; T.3S, R.38E;
 T.5S, R.31E; T.5N, R.27E; T.5N, R.28E; T.6N, R.31E; T.6N, R.36E;
 T.6N, R.39E; T.7S, R.29E; T.7S, R.32E; T.7S, R.35E
 IN GRANT, MORROW, UNION, UMATILLA AND WALLA COUNTY, OREGON;
 WALLA WALLA AND BENTON COUNTY, WASHINGTON

EAGLE
 GPS SURVEY CORPORATION
 6110 S.W. LOMBARD AVE
 BEAVERTON, OREGON 97008
 (503) 643-1073

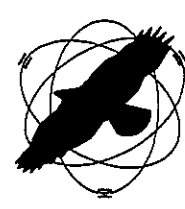

REGISTERED PROFESSIONAL LAND SURVEYOR
Walter L. Caswell
OREGON
 JULY 8, 1988
 WALTER L. CASWELL
 737
 EXPIRES 12/31/99

NO.	REVISION	DATE	BY

UMATILLA COUNTY GROUND CONTROL
 DATUM: NAD83(91) NGVD29
 ZONE : 3601 OREGON NORTH
 STATE PLANE IN: INTERNATIONAL FEET

RECEIVED BY
Morrow County Surveyor
 Date: 2-20-2017
 Recd By: S.K.H.
 No: 2017-1792C
 Folder No: 1792

LATITUDE (N)	LONGITUDE (W)	NGVD 29(47) HEIGHT (M)	NAD 83(91) (INTL FEET)		NGVD 29 HEIGHT (USft)	CONVERGENCE	SCALE FACTOR	NAME	7 1/2 MIN. QUAD	1/4	SEC	TWN	RGE	STATION DESCRIPTION-TO REACH STATEMENT
			NORTHING	EASTING										
45°29'47.033"	119°27'33.086"	790.892	668792.717	8468974.158	2594.785	0°44'17.258"	0.999910912	211	GLEASON BUTTE-OR	NE	9	1S	27E	12" STEEL SPIKE WITH WASHER INSCRIBED "EAGLE GPS SURVEY"-FROM PINE CITY, GO SOUTHWESTERLY ON LITTLE BUTTER CR. RD, 2.3 MILES, TO FORK. TAKE RIGHT FORK AND GO 2.25 MILES TO ROCK ROAD ON LEFT. GO SOUTHEASTERLY ON ROCK ROAD, 3.6 MILES, TO THE STATION ON SW EDGE OF ROAD.
45°30'03.219"	118°49'57.696"	518.754	673123.966	8629562.312	1701.945	1°10'56.749"	0.999911363	212	MAKAY RESERVOIR OR	SE	5	1S	32E	5/8" IRON ROD WITH YELLOW PLASTIC CAP INSCRIBED "EAGLE GPS CONTROL STA"- FROM PILOT ROCK, GO NORTH ON MILL ROAD TO MILE POST 1. PROCEED 0.20 MILES TO STATION TO THE NORTH. STATION IS 35' WEST AND 18' SOUTH OF GATE TO PILOT ROCK GUN CLUB.
45°29'34.852"	118°24'52.034"	1156.383	672742.337	8736842.871	3793.900	1°28'44.544"	0.999910576	213	MEACHAM LAKE-OR	SW	11	1S	35E	5/8" IRON ROD WITH YELLOW PLASTIC CAP INSCRIBED "EAGLE GPS CONTROL STA"- TAKE EXIT #238 OFF OF I-84 SOUTHBOUND. AT THE STOP SIGN THE STATION IS LOCATED 100' EAST OF OFF-RAMP AND 100' NORTHERLY OF ROAD UNDER I-84 IN THE NW QUADRANT OF THE INTERCHANGE.
45°39'55.164"	118°06'26.289"	1406.665	737723.670	8813715.913	4615.033	1°41'48.723"	0.999932126	214	ANDIES PRAIRIE-OR	SW	7	2N	38E	5/8" IRON ROD WITH YELLOW PLASTIC CAP INSCRIBED "EAGLE GPS CONTROL STA"- FROM ELGIN AT THE INTERSECTION OF HWY'S 82 AND 204, GO WESTERLY ON HWY 204 FOR 12.9 MILES TO FSR 31. TAKE FSR 31 WESTERLY 5.3 MILES TO A FOUR WAY INTERSECTION OF FSR 31, 3155 AND 3728. CONTINUE WESTERLY OF FSR 31 FOR 0.35 MILES TO ROAD ON LEFT. TURN LEFT AND PROCEED 0.05 MILES TO STATION ON RIGHT.
44°59'21.531"	118°48'58.328"	1204.361	486738.107	8637676.611	3951.308	1°11'38.852"	0.999899463	216	COCKSCOMB OR	SW	1	7S	32E	5/8" IRON ROD WITH YELLOW PLASTIC CAP INSCRIBED "EAGLE GPS CONTROL STA"- NEAR DALE, OR, FROM THE INTERSECTION OF HWY 395 AND QUIMBY ROAD, GO EAST ON QUIMBY (FSR 55) ROAD 4± MILES TO FSR 5505 AND BRIDGE OVER THE NORTH FORK OF THE JOHN DAY RIVER. TURN RIGHT ON FR 5505 AND GO 3.6± MILES TO QUARRY ACCESS ROAD. PARK AT GATE AND WALK 100 YARDS TO CENTER OF QUARRY AND STATION.
45°18'39.415"	118°03'52.259"	835.460	608902.454	8828543.953	2741.005	1°43'37.959"	0.999897655	LA GRANDE CBL 0 PT	LA GRANDE, SE-OR	NE	16	3S	38E	2" BRASS PLSD DISK-FROM EXIT #265 OFF OF I-84 GO WESTERLY ON HWY 30 1.65 MILES TO A FARM LANE NEAR GEKELER LANE. TURN LEFT ONTO FARM LANE AND STATION. SEE THE NATIONAL GEODETIC SURVEY DESCRIPTION FOR PRECISE LOCATION.
45°56'40.234"	119°18'01.317"	110.046	832734.764	8507269.580	361.043	0°51'02.749"	0.999986364	B 340	UMATILLA OR	SW	3	5N	28E	3 1/2" BRASS DISC STAMPED "B 340 1951"- FROM PLYMOUTH, WA, GO EASTERLY ON SR-14 0.8 MILE TO OVERPASS OF I-82. CONTINUE EASTERLY 1.4 MILES TO RAILROAD OVERPASS. CONTINUE EASTERLY 0.4 MILES TO BOAT LAUNCH PARKING AREA. TURN LEFT AND GO NORTH ON TRACK ROAD 0.1 MILES TO RAILROAD TRACK AND STATION. SEE THE NATIONAL GEODETIC SURVEY DESCRIPTION FOR PRECISE LOCATION.
45°08'15.863"	118°57'27.865"	1010.000	540108.994	8600034.257	3313.642	1°05'37.496"	0.999894728	FORE	UKIAH OR	NW	15	5S	31E	3 1/2" BRASS DISC STAMPED "FORE 1989"- STATION IS LOCATED IN THE SW QUADRANT OF THE INTERSECTION OF HWY 395 AND HWY 244, 1.3 MILES EAST OF UKIAH. SEE THE NATIONAL GEODETIC SURVEY DESCRIPTION FOR PRECISE LOCATION.
45°40'01.475"	118°46'38.960"	402.900	733999.514	8642421.693	1321.848	1°13'17.690"	0.999932392	PENDLETON	PENDLETON OR	NE	9	2N	32E	3 1/2" BRASS DISC STAMPED "PENDLETON 1963"- AT EXIT #210 OFF OF I-84, GO NORTH ON THIRD STREET FOR 0.3 MILES TO CROSS ROAD. TURN EAST ON GOODWIN STREET FOR 0.1 MILES TO INTERSECTION. TURN RIGHT ON SE 8TH STREET GO 0.4 MILES TO THE INTERSECTION OF SE 6TH STREET AND E. ISAAC STREET. CONTINUE ON 6TH STREET 0.2 MILES TO END OF ROAD AND THE STATION. SEE THE NATIONAL GEODETIC SURVEY DESCRIPTION FOR PRECISE LOCATION.

SURVEYOR: W.L.C.
 DRAWN BY: B.S.S.
 DATE: 11/13/98
 JOB NO. 98-004
 SHEET 3 OF 3

PHOTO CONTROL SURVEY
 FOR THE COUNTY OF UMATILLA
 LOCATED IN T.1S, R.27E; T.1S, R.28E; T.1S, R.32E; T.1S, R.35E;
 T.2S, R.35E; T.2N, R.32E; T.2N, R.38E; T.2N, R.39E; T.3S, R.38E;
 T.5S, R.31E; T.5N, R.27E; T.5N, R.28E; T.6N, R.31E; T.6N, R.36E;
 T.6N, R.39E; T.7S, R.29E; T.7S, R.32E; T.7S, R.35E
 IN GRANT, MORROW, UNION, UMATILLA AND WALLOWA COUNTY, OREGON;
 WALLA WALLA AND BENTON COUNTY, WASHINGTON



EAGLE
 GPS SURVEY CORPORATION
 6110 S.W. LOMBARD AVE
 BEAVERTON, OREGON 97008
 (503) 643-1073

REGISTERED PROFESSIONAL LAND SURVEYOR
Walter L. Caswell
OREGON
 JULY 8, 1966
 WALTER L. CASWELL
737
 EXPIRES 12/31/99

NO.	REVISION	DATE	BY

1792

1792