

BASIS OF BEARINGS

TRUE NORTH
BASED ON A GPS OBSERVATION TAKEN
NEAR THE SW CORNER OF SECTION 12

NARRATIVE

THIS SURVEY WAS PERFORMED AT THE REQUEST OF PAUL JOLLY ON BEHALF OF THE BLACK MOUNTAIN WATER DISTRICT IMPROVEMENT COMPANY. THE PURPOSE OF THIS SURVEY WAS TO SURVEY AND MONUMENT THE PROPOSED PROPERTY LINE ADJUSTMENT SHOWN HEREON.

THE ONE ACRE TRACT OF LAND DESCRIBED IN DEED INSTRUMENT NO. M-6668 WAS INTENDED TO ENCOMPASS SEVERAL SPRINGS THAT PROVIDE WATER TO BLAKE RANCH. A PRELIMINARY SURVEY DISCLOSED THAT NOT ALL OF THE SPRINGS WERE ON THE WATER DISTRICT PROPERTY. THE ADJUSTED TRACT SHOWN HEREON, INCLUDES THE SPRINGS. THERE IS NO NET CHANGE IN THE AREA OF EITHER THE GILLIAM TRACT OR THE BLACK MOUNTAIN WATER DISTRICT IMPROVEMENT COMPANY TRACT AS A RESULT OF THIS SURVEY.

A SEARCH WAS MADE OF THE AVAILABLE RECORDS PERTAINING TO THIS SURVEY. EDWARD SANDERSON CONDUCTED THE ORIGINAL GLO SURVEY OF THE SOUTH LINE OF SECTION 12 UNDER CONTRACT NO. 417 IN 1881.

DAVID KRUMBEIN, PLS, FOUND ORIGINAL EVIDENCE AT THE SOUTHWEST CORNER AND THE S1/4 CORNER OF SECTION 12 IN 1983. MR. KRUMBEIN REMONUMENTED THE CORNER POSITIONS WITH BRASS CAPPED MONUMENTS, AS SHOWN HEREON.

I ACCEPT THE FOUND MONUMENTS SHOWN HEREON AND SET NEW MONUMENTS AT POSITIONS APPROVED BY MR. JOLLY AND ACCORDING TO THE EVIDENCE FOUND.

LEGEND

- FOUND 2 1/2" GALV. IRON PIPE WITH ATTACHED 2 1/2" BRASS CAP WITH CORNER MARKINGS AND PLS 933 1983
- SET 5/8"x30" IRON PIN WITH ATTACHED YELLOW PLASTIC CAP MARKED BENCHMARK SURVEYING
- G() GLO RECORD BEARING AND DISTANCE
- () DEED RECORD BEARING AND DISTANCE
- 6 SPRING
- BMWDIC BLACK MOUNTAIN WATER DISTRICT IMPROVEMENT COMPANY
- PROPOSED ADJUSTED PROPERTY LINE

REFERENCES

GENERAL LAND OFFICE FIELD NOTES
DEED RECORD INSTRUMENT NO.'S M-6668 & M-29014
MORROW COUNTY CORNER RESTORATION RECORDS

REGISTERED
PROFESSIONAL
LAND SURVEYOR

MCS

OREGON
JULY 9, 2002
MICHAEL C. SPRINGER
#70918
EXPIRES: 6/30/2014

RECEIVED BY
Morrow County Surveyor

Date: 5-31-2014

Rec'd By: S.K.H.

No.: 2014-1707C

Folder No.: 1707

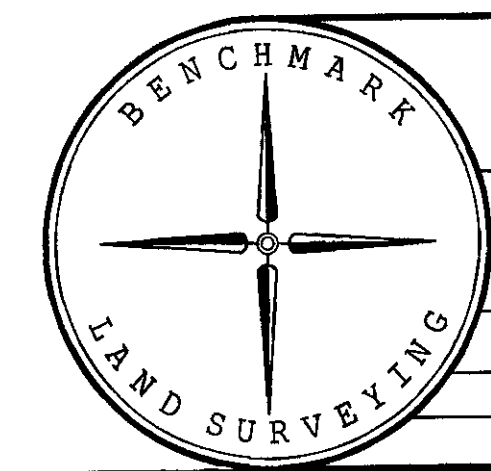

BENCHMARK LAND SURVEYING
217 N. CANYON BLVD. JOHN DAY, OREGON
2101 MAIN STREET, STE 223 BAKER CITY, OREGON
541-575-1251 ~ 800-699-0516

MAP OF SURVEY
PROPOSED PROPERTY LINE ADJUSTMENT
SITUATED IN THE SW1/4SW1/4 SECTION 12,
T.4S., R.28E., W.M.
MORROW COUNTY, OREGON

SURVEYED FOR	BLACK MOUNTAIN WATER DISTRICT IMPROVEMENT COMPANY	
SURVEYED BY	MCS	5/22/2014
Scale: 1"=100'	Drawn by:	MCS