

LINE	DIRECTION	DISTANCE
L3	S00°25'10"E	113.14' (sewer esm't.)
L4	S22°23'30"W	255.77' (sewer esm't.)
L5	S00°20'24"W	113.18' (water esm't.)
L6	S21°39'41"W	199.84' (water esm't.)

PARTITION PLAT NO. 8

REPLAT OF PARCEL 1, PARTITION PLAT 2008-9
 IN THE WEST 1/2, SW 1/4, NW 1/4, SECTION 16
 TOWNSHIP 4 NORTH, RANGE 25 EAST, W.M.
 CITY OF BOARDMAN, MORROW COUNTY, OREGON

RECORD LEGAL DESCRIPTION
 (REFERENCE: STATUTORY WARRANTY DEED FILED IN MORROW CO. DEED RECORD 2008-22692) RECORDED SEPTEMBER 17, 2008)
 PARCEL 1 OF PARTITION PLAT 2008-9, IN THE CITY OF BOARDMAN, COUNTY OF MORROW AND STATE OF OREGON. (TAX LOT 1901 MAP 4N 25 16BC)

OWNER'S DECLARATION
 WE, THE UNDERSIGNED, OWNERS OF THE LAND DESCRIBED HEREON, HAVE CAUSED THIS LAND TO BE SURVEYED AND PARTITIONED AS SHOWN HEREON AND HEREBY DEDICATE THE UTILITY EASEMENTS FOR THE USES SHOWN ON THIS PLAT.

Melinda Bick
 AUTHORIZED REPRESENTATIVE OF
 COLUMBIA RIVER COMMUNITY HEALTH SERVICES

ACKNOWLEDGMENT
 STATE OF OREGON } s.s.
 COUNTY OF MORROW }
 THIS IS TO CERTIFY THAT ON THIS 10 DAY OF MARCH, 2011, PERSONALLY APPEARED BEFORE ME, MELINDA BICK, AUTHORIZED REPRESENTATIVE OF COLUMBIA RIVER COMMUNITY HEALTH SERVICES, TO ME KNOWN TO BE THE INDIVIDUAL IN AND WHO EXECUTED THE FOREGOING "OWNER'S DECLARATION", AND ACKNOWLEDGED TO ME THAT THEY SIGNED THE SAME AS THEIR VOLUNTARY ACT AND DEED. IN WITNESS THEREOF, I HAVE SET MY HAND OFFICIAL SEAL THE DAY AND YEAR FIRST ABOVE WRITTEN.

Kathleen M. Close
 NOTARY PUBLIC IN AND FOR THE STATE OF OREGON
 RESIDING AT Irrigon
 MY COMMISSION EXPIRES: 06/27/13



APPROVALS

Melissa R. Baker 3/16/2011
 CITY OF BOARDMAN PLANNING COMMISSION DATE

Quincy L. Cooper 25 March 2011
 MORROW COUNTY SURVEYOR DATE

My Saal 3-25-11
 MORROW COUNTY ASSESSOR DATE

- NOTES:**
1. BASIS OF BEARING: THE SOUTH LINE OF THE NORTHWEST QUARTER OF SECTION 16 AS SHOWN ON PARTITION PLAT 2008-9.
 2. (M) = MEASURED BEARING & DISTANCE PER THIS SURVEY
 (C) = COMPUTED (R) = RECORD BEARING & DISTANCE PER PARTITION PLAT 1992-3
 [] = RECORD BEARING & DIST. PER PARTITION PLAT 1995-3
 3. ● = DENOTES FOUND 5/8"x30" STEEL REBAR WITH YELLOW PLASTIC CAP STAMPED "GBW 02817LS".
 4. ⊙ = DENOTES FOUND 5/8" REBAR & CAP BY MCKINNIS PER P.P. #1995-3 & 1999-6
 5. ○ = DENOTES SET 5/8"x30" STEEL REBAR WITH YELLOW PLASTIC CAP STAMPED "GBW 02817LS".
 6. ⊕ = DENOTES COMPUTED POSITION ONLY, NOT FOUND OR SET

SURVEY NARRATIVE
 THE PURPOSE OF THIS SURVEY IS TO PARTITION PARCEL 1, PARTITION PLAT NO. 2008-9 INTO TWO SEPARATE PARCELS IN ORDER TO CREATE TWO NEW PARCELS FOR DEVELOPMENT.
 THE BASIS OF BEARING FOR THIS SURVEY IS PARTITION PLAT NO. 2008-9.

SURVEYOR'S CERTIFICATION
 I, GARY B. WAGNER, A PROFESSIONAL LAND SURVEYOR IN THE STATE OF OREGON (LS #02817) HEREBY CERTIFY THAT THIS PARTITION PLAT CORRECTLY REPRESENTS A SURVEY CONDUCTED BY ME OR UNDER MY DIRECT SUPERVISION IN DECEMBER 2010, AND FURTHER CERTIFY THAT ALL PARCELS HAVE BEEN SURVEYED AND MONUMENTED AS REQUIRED BY ORS 92.

March 8, 2011
 DATE

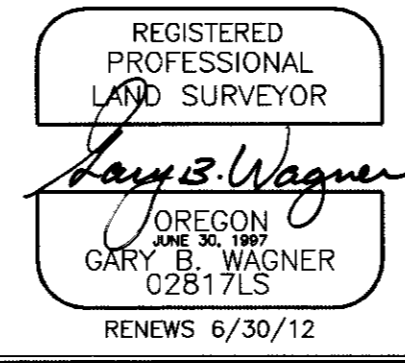

Gary B. Wagner
 THIS IS AN EXACT DUPLICATE

ROGERS SURVEYING INC., P.S.
 1455 COLUMBIA PARK TRAIL
 RICHLAND, WA. 99352
 PHONE (509) 783-4141
 FAX: (509) 783-8994
 www.rogerssurveying.com

CLIENT	COLUMBIA RIVER COMMUNITY HEALTH	JOB	21210
PROJECT	PARTITION PLAT	DRN. BY	GBW
	REPLAT PARCEL 1 PARTITION PLAT 2008-9	SCALE	1"=100'
		F. B. NO. TRIMBLE	SDPROJ- 21210
APPROVED	GBW	DATE	12-06-10
		FILE:	21210.DWG
		SHEET	1 OF 1

SURVEY REFERENCES
 PARTITION PLAT 2008-9
 PARTITION PLAT 1992-7
 PARTITION PLAT 1995-3
 PARTITION PLAT 1999-6
 SANDZ STONE SUBDIVISION PHASE I AND II

