

SURVEY FOR PROPOSED RIGHT OF WAY
 Located in the SW1/4, Section 12 and the NW1/4, Section 13
 T.1S., R.25E., W.M., Morrow County, Oregon
 Survey Performed in April, 2001

NARRATIVE

This survey was performed at the request of the Morrow County Public Works Department, the purpose of which is to locate and monument the proposed right of way at the intersection of Morrow County Road No. 504 and Oregon Highway 207. The proposed right of way is located to provide for future improvements to that intersection.

In order to perform this survey, the Morrow County records for the pertinent roads are researched. The book titled 'RECORD OF ROADS, MORROW COUNTY' indicate that the 1/4 corner common to Sections 12 and 13 is at the intersection of said County Road No. 504 (Record road No. 230) and County Road No. 509 (Record Road No. 17). The centerline of Road No. 509 is recorded along the N-S Center of Section Line for Section 13 and the centerline for Road #504 is recorded along the South Section Line, Section 12. Both Road No. 509 and 504 are tied for 3000+ ft. and a best fit centerline of each road is established. The intersection of these two roads is the best available evidence of the record location of the said 1/4 and at the intersections of these centerlines, a monument for the 1/4 corner is set. The proposed right of way is monumented as shown.

Ferguson Surveying

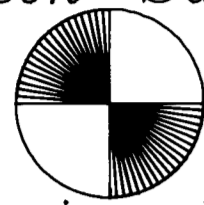

Engineering

P.O. Box 519, 210 E. Main
 MT. VERNON, OR 97865
 PHONE (541)932-4520
 FAX (541)932-4430
 EMAIL dfse@highdesertnet.com

TURNER LN MORROW CO.
 Proposed Right of Way

APPROXIMATE HIGHWAY
 RIGHT OF WAY

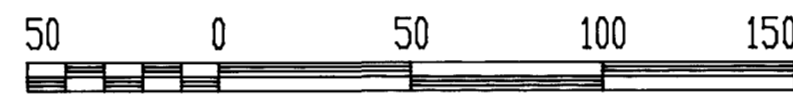

Scale: 1"=50'

BASIS OF BEARING: Assumed Bearing
 as shown along the South Line of Section 12

Deed Record M-7116
 W W & D Farms, Inc.

ENGINEER'S STATION 0+00.00
 POINT BEING 116.18 FT. NORTH
 & 925.51 FT. WEST OF THE
 SOUTH 1/4 CORNER, SECTION 12

ENGINEER'S STATION 0+00.00
 POINT BEING 0.00 FT. NORTH
 & 636.54 FT. WEST OF THE
 SOUTH 1/4 CORNER, SECTION 12

SE1/4

Set 2-1/2" Dia. Aluminum Monument
 with a 3-1/4" Dia. Aluminum cap
 stamped as shown.

T1S R25E
 1/4 S12
 1/4 S13
 2001
 PLS 49865

SW1/4

NE1/4

NW1/4

OR HIGHWAY 207
 APPROXIMATE HIGHWAY
 RIGHT OF WAY

EXISTING 40 FT. RIGHT OF WAY

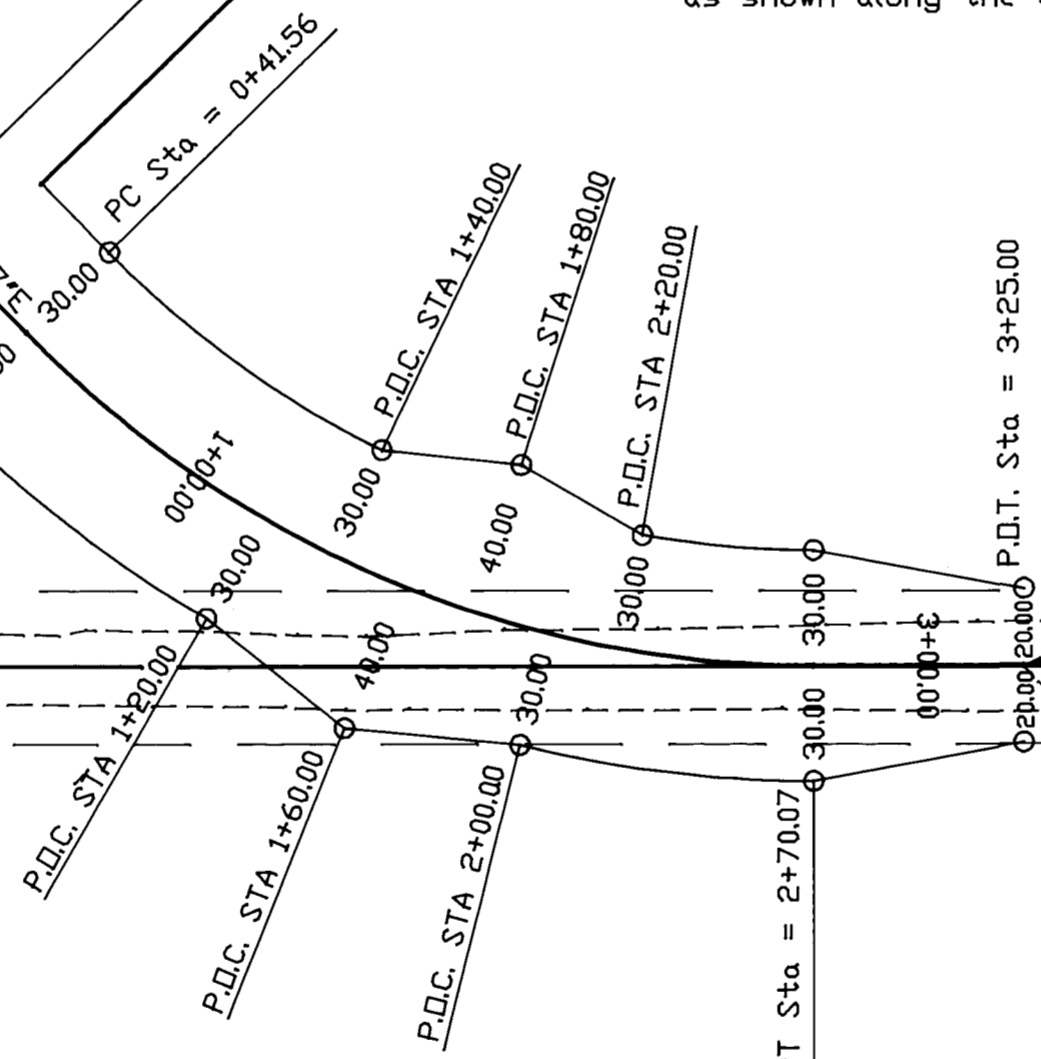

Deed Record M-45347
 Jeffrey Cutsforth

CENTERLINE CURVE DATA
 PI Sta = 1+62.28
 I = 45°42'53"L
 Radius = 286.40
 Arc Length = 228.51
 Chord Length = 222.50
 Chord Bearing = S67°08'34"E

REGISTERED
 PROFESSIONAL
 LAND SURVEYOR
 OREGON
 JULY 13, 1999
 KENNETH H. DELANO JR.
 49865
 RENEWAL DATE:
 12/31/01

RECEIVED BY
 Morrow County Surveyor
 Date FEB 17 2011
 Rec'd By SKB
 No. 1594-C

1594