

LOT 14

LOT 7

LOT 6

LOT 6

LOT 5

LOT 5

LOT 15

LOT 4

LOT 3

KINKADE ROAD

LEGEND:

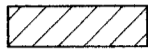
- SET 5/8" X 30" STEEL REBAR WITH A PLASTIC CAP MARKED COPPOCK LS 2850.
- FOUND 5/8" STEEL REBAR SET BY LS 933 FOR ORIGINAL PLAT OF "COLUMBIA TERRACE".
-  10 FOOT WIDE STRIP THE OWNERSHIP OF WHICH IS TO BE TRANSFERRED TO THE OWNER OF LOT 5, BLOCK 5, "COLUMBIA TERRACE ADDITION TO THE CITY OF BOARDMAN, MORROW COUNTY, OREGON".

SURVEYORS NARRATIVE:

The purpose of this survey and Boundary Line Adjustment is to locate and monument a tract of land lying in Lot 6, Block 5, "Columbia Terrace Addition" to the City of Boardman, Morrow County, Oregon which is 10 feet wide and being parallel to the North line of Lot 5, Block 5, "Columbia Terrace Addition" to the City of Boardman, Morrow County, Oregon, the ownership of is to be transferred to the owner of Lot 5, block 5, "Columbia Terrace Addition" to the City of Boardman, Morrow County, Oregon

This Boundary Line Adjustment only changes ownership lines and does not change or vacate any Platted Lot Lines or easements for streets or utilities.

I found the monuments noted and found them to be a good match of the record. I used the found monuments and record Bearings and Distances to set the three 5/8" X 30" steel rebar with plastic caps marked "COPPOCK, LS 2850" as shown on this record of Survey.

The Bearing Base for this Survey is the common line between Lots 5 and 6, Block 5, "Columbia Terrace Addition" To the City of Boardman.

The New Descriptions required for the Boundary Line Adjustment are shown on this Record of Survey and on Separate Sheets provided to the Estates Builders Inc. for their use in Deed Preparation for the Land Exchange as required for this Boundary Line Adjustment.

SCALE 1"=20'

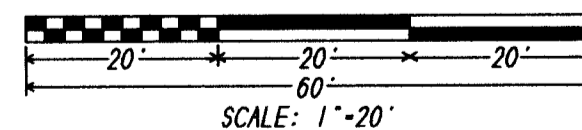

REGISTERED
PROFESSIONAL
LAND SURVEYOR

Judson L. Copcock
OREGON
JANUARY 20 1998
JUDSON L. COPPOCK
2850

RENEWAL DATE: DEC. 31, 2005

RECEIVED BY
Morrow County Surveyor
Date OCT 16, 2005
Rec'd By SKB
No. 1446-C

BOUNDARY LINE ADJUSTMENT FOR:
ESTATES BUILDERS INC.
1524 NE 40th AVE.
PORTLAND, OR 97832

COPPOCK SURVEYING 5 OCTOBER 2005
P.O. BOX 495 541-676-8750
HEPPNER, OR 97836 FAX 676-8753
Job No. 0905354