

**SURVEYOR'S NARRATIVE & CERTIFICATE:**

THE PURPOSE OF THIS SURVEY IS TO ADD A PORTION OF PARCEL 1 OF PARTITION PLAT 1998-13 TO THAT TRACT OF LAND DEEDED TO RHONDA J. RILEY ON M-2002-3827 MORROW COUNTY DEED RECORDS SO A SUBDIVISION CAN BE SURVEYED TO THE SOUTH AND WEST OF IT.

THIS SURVEY IS BASED ON MY 2000 SURVEY FOR RILEY WHICH WAS A BOUNDARY LINE ADJUSTMENT DONE TO CREATE THE TRACT DESCRIBED IN DEED M-2002-3827.

REGISTERED PROFESSIONAL LAND SURVEYOR  
*G. Dennis Edwards*  
 OREGON  
 JULY 16, 1971  
 G. DENNIS EDWARDS  
 9 5 1  
 RENEWS 12/31/2005

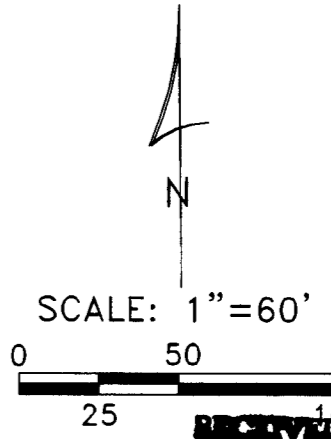

RECEIVED BY  
 Morrow County Surveyor  
 Date 04/12/05  
 Rec'd By JLC  
 No. 1423 C

- LEGEND:**
- MONUMENTS FOUND AS NOTED
  - Ⓐ 5/8" IRON REBAR SET BY ME IN FEB. 1998 FOR CARL RILEY
  - Ⓑ 5/8" IRON REBAR SET BY ME IN PARTITION PLAT 1998-13
  - Ⓒ 3/4" IRON PIPE, NO RECORD
  - SET 5/8"X30" IRON REBAR WITH PLASTIC CAP #951
  - (000) OF RECORD TAMBLYN'S 1935 PLAT OF SUBDIVISION OF SEC. 24

BOUNDARY LINE ADJUSTMENT FOR RILEY  
 IN PARTITION PLAT 1998-13  
 IN THE SW 1/4 OF SECTION 24, T 5 N,  
 R 26 E, W.M., MORROW CO, OR.  
 IN BLOCK 13W OF THE SUBDIVISION OF SECTION 24  
 4/12/05 JOB# S0111313C  
 EDWARDS SURVEYING P.O. BOX 763  
 541-567-3336 HERMISTON, OREGON 97838  
 DRAWN BY NJF

1423

1423 C