

at at

Thursday Jan 22 1920.

Being in Sec. Co. 9 T. 9 N. R. 25 E

Being for R. Crawford

price

C. E. Ewin

Ben Bellamy

Ed. Hill

See further

Stone

Ewin & Bellamy acted as

chain carriers

18

post

19

post

post  
post

17

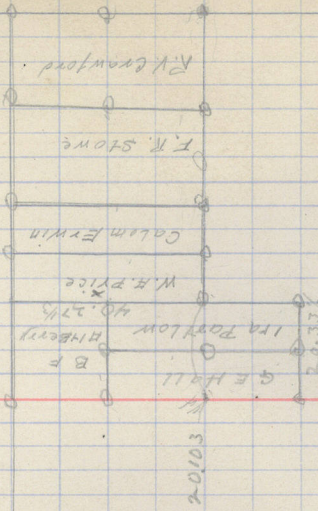

X 1/4 mi. west of south side of river.

46
135
325

325
66
1950
1950
21450

Set up on N.E. corner to Sta. 21  
TP 4 N. R 25 E 27 N 1/4

Sum of st. 4 south

20.00 W. 4' set a stake.

find stake 2x2' and look for top.

25' link set a R. 0° 40' E

40.00' set the end up and wood up

A 00480 E.

Set up on N.E. cor of Sta. 20.

run West 4' flagged 1/4 on

Feb. Dec. 17 x 20

21.75 W. set temp 1/4 x 1/4 on

40.135 ch. the 1/4 corner

Set up on 1/4 corner and

continue line west

10.00 ch. set temp on D tract

20.00 ch. set temp 1/4 1/4 corner

set a found 3 ft south of corner

found of wire on which

40.46 ch. to corner of N.W. 1/4 of Sta. 20.

20.06 3/4 stake set on 1/4 x 1/4 corner 1/4 on corner  
\* on top found 3 ft under surface  
thin Galv. pipe 3" set south of 1/4 1/4 corner

Set stake at corner point and 1/4 on pipe set on D tract.  
set stake concrete about mid 1/4 1/4 corner 1/4 on D tract  
corner point.

11,43' 00.

Set in on NW corner Dec 20.  
86.31d to NW cor of Dec. 19, on top line

Stop on corner to Dec

17-18. 19-20. Top of R 25 E. 200

Run South parallel with  
and 20 ft east of bottom of 44.  
1320 ft set top of corner

2613.6 The 1/4 corner, a stone 6x10  
with 1/4 C.S. 20 ft east of  
center

Antenna South and set

1320.1 set corner 1/4 corner  
a stone 5 x 5 x 8 with 1/4 x 1/4 x C.S.  
character in bottom of hole  
also small rock 7' above top

Return to 1/4 corner set Dec. 19 x 20  
and run on the line north

1331.8 ft set 1/4 corner, drive character 2' high  
stone at west corner point  
Place small rock near the stake  
project a stone 4 x 6 x 12 with 1/4 x 1/4 x  
16 ft east of west wall of post 1920

Set Jan, 24, 1901

Stapa 1/4 corner section

Dec. 20 x 21 TP 471 R 25

Ran Braden Lane

A. 89° 30' N.

20,00 ch set temp 1/4 cor

Set on 1.5 ch with 2 1/2 lbs wet

40,00 set temp 1/4 corner

Set on 2.0 ch with 4.5 lbs wet

50,00 set temp 1/4 cor of corner

Set on 2.5 ch with 5.33 lbs wet

60,00 set temp 1/4 cor of corner

Set on 3.0 ch with 6.75 lbs wet

40,01 set temp cor 700 Parton & Feb

Set on 3.5 ch. with

7.5 lbs wet

80,00 The <sup>line</sup> ~~line~~ 28 Dec. 1901, 7400 2.50

Set on 4 wet 40 lbs wet of corner

2186 24  
1901  
7 8 11

Set on 5 x 6 x 15 wet 1/4 cor C.S.

Set on 5 x 6 x 15 wet 1/4 cor C.S.

Set on 5 x 6 x 15 wet 1/4 cor C.S.

Set on 5 x 6 x 15 wet 1/4 cor C.S.