

NARRATIVE:

THE PURPOSE OF THIS SURVEY IS TO DO A BOUNDARY LINE ADJUSTMENT TO INCREASE THE SIZE OF THAT TRACT OF LAND DEEDED TO STEVE AND LOUISE RILEY ON M-35309. THE INCREASE COMES FROM PARCEL 1 OF PARTITION PLAT 1998-13 AND FROM ANY LAND LYING IN LOT 3 OF BLOCK 13W WHICH IS NOT INCLUDED IN SAID PARCEL 1. I SURVEYED SAID PARCEL IN 1998 FOR CARL RILEY. THE BEARINGS AND THIS SURVEY ARE BASED ON THAT 1998 SURVEY.

CURVE TABLE

#	RADIUS	DELTA	LENGTH	CHORD
C1	50.00'	92°31'00"	80.74'	N74°04'19" W 72.25'
C2	50.00'	57°27'04"	50.17'	S30°55'40"W 48.09'
C3	50.00'	150°00'04"	130.90'	S72°48'54"E 96.59'

LINE TABLE

#	BEARING	DISTANCE
L1	N 87°48'52" W	20.79'
L2	N 0°23'16" W	10.01'

LEGEND:

- FND. 5/8" IRON REBAR SET BY ME IN 1998 UNLESS NOTED OTHERWISE
- SET 5/8"X30" IRON REBAR WITH PLASTIC CAP #951
- (000) OF RECORD TAMBLYN'S 1935 PLAT OF SUBDIVISION OF SEC. 24

RECEIVED BY
Morrow County Surveyor
Date 7/2000
Rec'd By DE
No. B-1270-E (1043)

REGISTERED
PROFESSIONAL
LAND SURVEYOR

G. Dennis Edwards

OREGON
JULY 16, 1971
G. DENNIS EDWARDS
9 5 1
RENEWS 12/31/2001

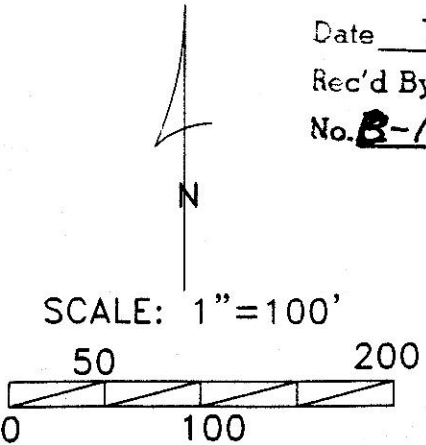

SURVEY FOR CARL RILEY
IN BLK. 13W, IN SW 1/4 OF SEC. 24,
T 5 N, R 26 E, W.M.,
CITY OF IRRIGON, MORROW COUNTY, OREGON
6/10/2000 JOB# S9810267-A
EDWARDS SURVEYING P.O. BOX 763
541-567-3336 HERMISTON, OREGON 97838
DRAWN BY NJF