

**DEDICATION**

STATE OF OREGON S.S.  
COUNTY OF MORROW

**KNOW ALL MEN BY THESE PRESENTS :**

That We, the undersigned, do hereby certify that we are the owners of the land as shown and described on this plat and have caused the tract of land to be Surveyed, Subdivided and Platted as the **HAYDEN HILLS SUBDIVISION No. 2** in the City of Boardman, Morrow County, Oregon.

**DESCRIPTION :**

A replat of Lot 25 of Hayden Hills Subdivision No. 1, within the Northeast Quarter of the Southeast Quarter of Section 17, Township 4 North, Range 25 East, W.M., City of Boardman,

County of Morrow, State of Oregon, and being more particularly described as follows:

Commencing at the CE 1/16 corner of said Section, Township, and Range, also being the northwesterly corner of Hayden Hills Subdivision No. 1;

Thence S 00°18'52" E, along the westerly boundary of said subdivision a distance of 425.00 feet to a found 5/8 inch rebar and cap (LS 2316), also being the southwesterly corner of lot 24 in said subdivision, the northwesterly corner of Lot 25, and also being the POINT OF BEGINNING;

Thence N 89°49'50" E, along the northerly boundary of said Lot 25, a distance of 629.35 feet, to a found 5/8 inch rebar and cap (LS 2316) also being the southeasterly corner of lot 21 in said Subdivision;

Thence S 00°18'32" E, 287.21 feet to a 5/8" rebar set this survey;

Thence N 89°49'50" E, a distance of 692.21 feet, to a point on the East Line of said Section 17;

Thence along said East Line, S 00°18'32" E, a distance of 617.34 feet, to the S1/16 Corner common Sections 16 and 17, T4N, R25E, W.M.;

Thence along the South Line of said NE1/4SE1/4, S 89°53'37" W, a distance of 1321.48 feet, to the SE1/16 Corner of said Section 17;

Thence, along the West Line of said NE1/4SE1/4, N 00°18'52" W, a distance of 903.09 feet, to the POINT OF BEGINNING.

Containing 22.86 acres, more or less.

**WE HEREBY CERTIFY :**

That the streets or portions thereof within the limits of the plat are dedicated to the public use forever, the utility easements shown on this plat are not dedicated to the public but the right to use said easements is hereby perpetually reserved for public utilities, and no structure other than for utility purposes shall be erected within the limits of said easements.

[Signature] 11-8-99  
SAGEBRUSH DEVELOPMENT, L.L.C., RANDALL S. AVERY MEMBER DATE

**ACKNOWLEDGMENT**

STATE OF OREGON S.S.  
COUNTY OF Deschutes

On this 8 day of November, 1999, A.D., before me, a Notary Public in and for said County and State, the foregoing instrument was acknowledged before me by the above named Officer of SAGEBRUSH DEVELOPMENTS, L.L.C., on behalf of the Company.

Kimberly Guthrie Deschutes County  
NOTARY PUBLIC RESIDING AT SEAL

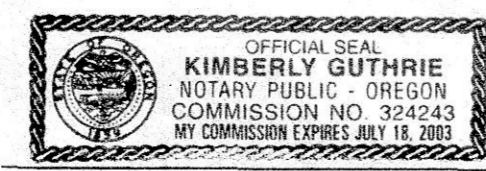

**SURVEYOR'S CERTIFICATE & NARRATIVE**

STATE OF OREGON S.S.  
COUNTY OF MORROW

I, DANNY K. CUMMINGS, a Registered Professional Land Surveyor, in and for said County and State do hereby certify that the survey of **HAYDEN HILLS SUBDIVISION No.2** in Morrow County, Oregon, as shown and described on this Plat was made by me and this Plat correctly shows the survey as made. I furthermore certify that monuments have been established as indicated hereon. In witness thereof I hereunto set my hand and seal this 10th day of Sept., 1999 A.D..  
Control for this Plat is based on the Plat of **HAYDEN HILLS SUBDIVISION No.1** filed under County Survey Instrument No. C-1168-E. Basis of Bearings are based on said Recorded Plat.

I, DANNY K. CUMMINGS, HEREBY CERTIFY THAT THIS IS AN EXACT REPRODUCTION OF THE ORIGINAL.

[Signature] 9-10-99

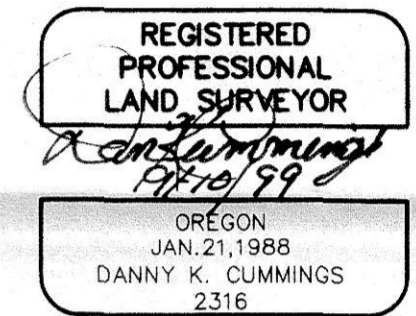

CERTIFICATE EXPIRES : 12-31-99

**APPROVALS**

WE THE UNDERSIGNED, HEREBY CERTIFY THAT THIS PLAT OF **HAYDEN HILLS SUBDIVISION No. 2** HAS BEEN APPROVED BY EACH OF US AND THAT IT CONFORMS TO THE REQUIREMENTS OF OUR RESPECTIVE OFFICES AND HEREUNTO SET OUR HANDS.

Kathy L. Moore, City Manager 11-16-99  
CITY OF BOARDMAN PLANNING COMMISSION MORROW COUNTY, OREGON DATE  
[Signature] 12/22-99  
COUNTY COMMISSIONER MORROW COUNTY, OREGON DATE

[Signature] 12-21-99  
COUNTY ASSESSOR MORROW COUNTY, OREGON DATE  
[Signature] 12/22/99  
COUNTY COMMISSIONER MORROW COUNTY, OREGON DATE

[Signature] 12-21-99  
TAX COLLECTOR MORROW COUNTY, OREGON DATE  
[Signature] 12/22/99  
COUNTY JUDGE MORROW COUNTY, OREGON DATE  
TAXES ARE PAID IN FULL AS OF THIS DATE

[Signature] 12/14/99  
COUNTY SURVEYOR MORROW COUNTY, OREGON DATE

**RECORDING**

I, HEREBY CERTIFY:

That this instrument was filed at the request of \_\_\_\_\_ at 9:45 A.m., this 28th day of December, 1999 A.D.

FEE: \_\_\_\_\_, INSTRUMENT No. M-60200, SLIDE \_\_\_\_\_

[Signature]  
COUNTY RECORDER DEPUTY

AFFIDAVIT OF VENDOR, MORTGAGE OR TRUST DEED HOLDER, INSTRUMENT No. \_\_\_\_\_

RECEIVED BY  
Morrow County Surveyor  
11/2000  
DE  
C-1247-E (1021)

