

**RIGHT OF WAY**  
 PLANS PREPARED BY  
**U.S. DEPARTMENT OF TRANSPORTATION**  
**FEDERAL HIGHWAY ADMINISTRATION**  
**WESTERN DIRECT FEDERAL DIVISION**  
 FOR  
**OREGON, FOREST HIGHWAY PROJECT F.H. 109-1(I)**  
**WILLOW CREEK ROAD**  
 LENGTH 7.903 MILES  
**UMATILLA NATIONAL FOREST**  
**MORROW COUNTY**  
**OREGON**

INDEX TO SHEETS	
SHEET NO.	DESCRIPTION
1	TITLE SHEET
2-4	VICINITY MAP
5-18	RIGHT OF WAY PLAN

PLANS REVIEWED BY	DATE
DESIGN C. Borstad	9-83
DRAFTING M. Standley	9-83
AREA DES. ENGR.	
DESIGN CHIEF	

**CONVENTIONAL SYMBOLS**

COUNTY LINE	---
TOWNSHIP OR RANGE LINE	----
SECTION LINE	-----
QUARTER SECTION LINE	-----
SIXTEENTH LINE	-----
NATIONAL PARK OR FOREST BOUNDARY	////
LINE TO BE CONSTRUCTED	---
LIMIT OF SLOPE LINE TOP OF CUT	~
LIMIT OF SLOPE LINE TOE OF FILL	~
PROPOSED RIGHT OF WAY LINE	---
EXISTING RIGHT OF WAY LINE	---
LIMITED ACCESS RIGHT OF WAY	•••
TRAVELED WAY	---
RAILROAD	+
EXISTING FENCE	+
EXISTING CULVERT	+
CULVERT TO BE CONSTRUCTED	+
EXISTING BRIDGE	+
PROPOSED BRIDGE	+
POWER POLES (EXISTING & PROPOSED)	+
TELEPHONE/TELEGRAPH POLES (EXIST. & PROP.)	+
JOINT USE POLES (EXISTING & PROPOSED)	+
ROAD APPROACH	+

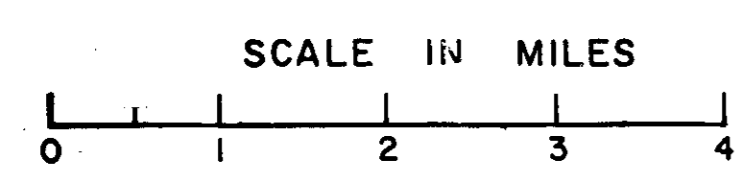
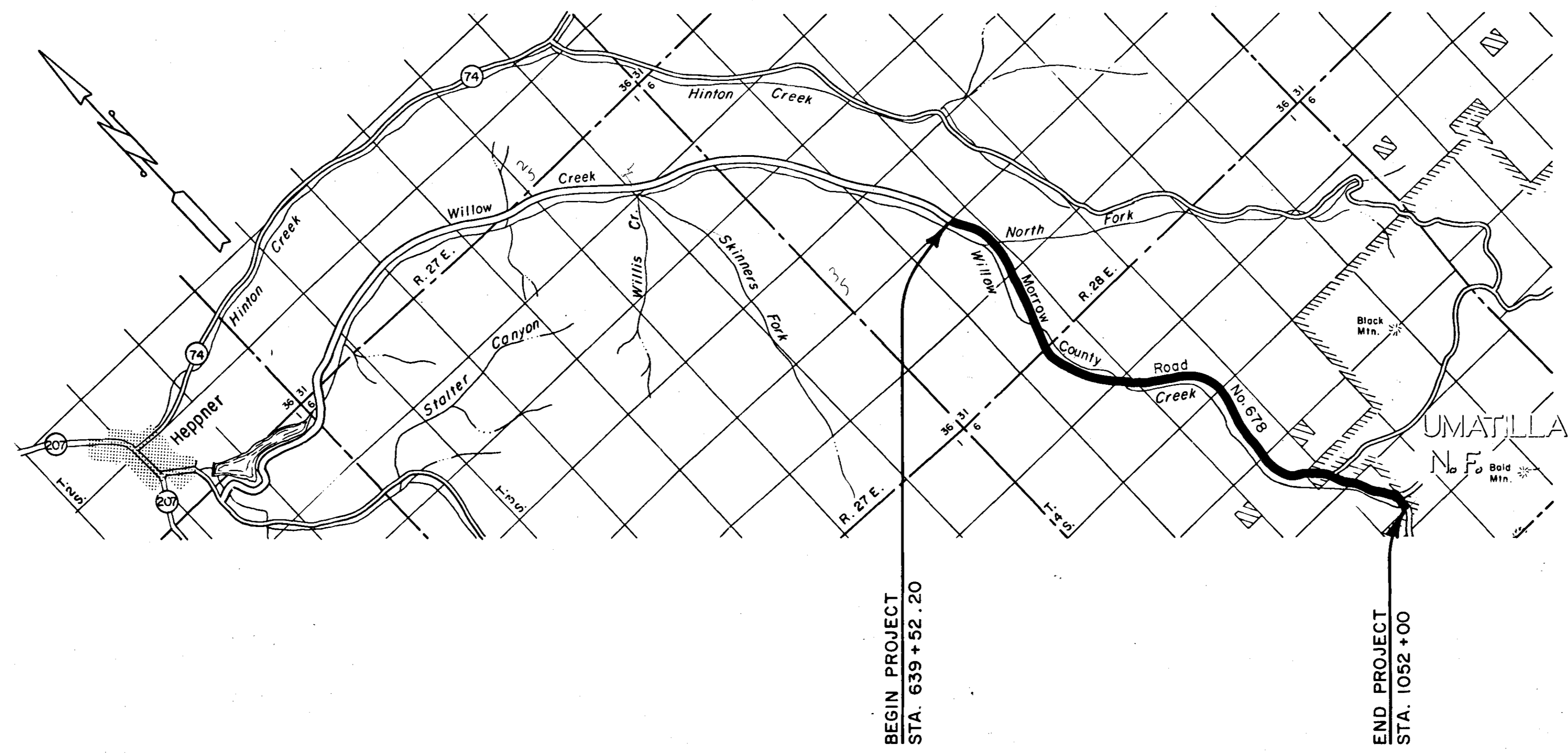

D-634-K-635

P-1-C

D-634