

10 11 Fence Cor Fd.  
15 14

S. 89°-51'-00" W.  
5335.17'  
(N. 89°-58' W. 5299.8')

B.P.A. McNary-Alvey Power  
Grid S. 84°-49'-40" W.  
True S. 85°-20'-40" W.

11 12 Gov't brass cap fd.  
14 13 300' Tower #2 Mile Point 25  
E. 1/4 Set I.R.

N. 89°-49'-10" W.  
1334.00'

Existing l.c. on line 7  
Set Nail

Grid 10:31:00"  
True

S.E. 1/4 of S.E. 1/4  
Section 14, T. 4 N., R. 24 E., W.M.  
Morrow County, Ore.

~ NOTES ~  
Bearings are based on Oregon Lambert Grid system, North zone. (From B.P.A. Centerline.)  
(North 5280) denotes original Gov't measure

No records have been found, giving the official widths of the two County roads, Tom's Camp Road and Ed Kunze Road. All fence lines along these roads indicate the widths to be 40 feet. Points indicated were therefor set 20 feet from the Section lines.

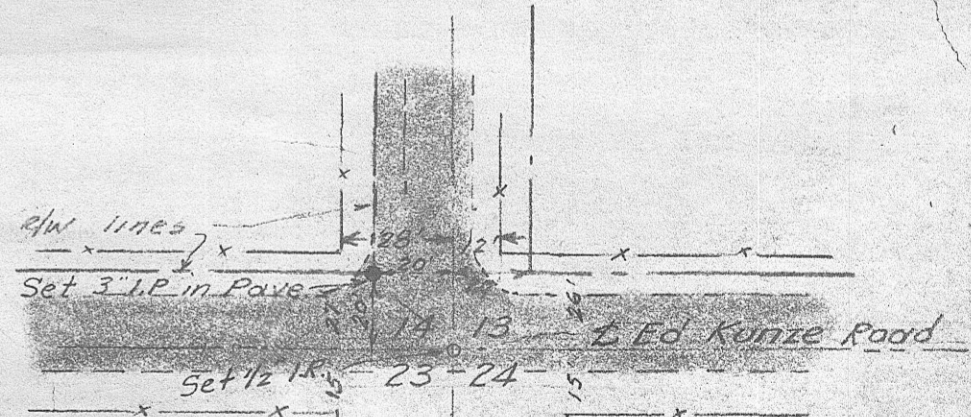

RECEIVED BY  
Morrow County Surveyor  
Date March 10, 1981  
Rec'd By M. Hughes  
No. C-198K

Fd. Spike in Center of Roads

Date	No.	Revisions	By	App.
SURVEY of S.E. 1/4 of S.E. 1/4 of Section 14, T. 4 N., R. 24 E., W.M. Morrow County, Oregon.				
Design	TENNESON ENGINEERING CORP. Consulting Engineers			Scale: 1"=100'
Survey	412 West Second Place, The Dalles, Oregon			Date: 5-10-61
Drawn	Checked	Approved	Work Order No.	Sheet
V.F.	V.F.	<i>[Signature]</i>	2578	1 of 1

REGISTERED OREGON LAND SURVEYOR

Verl R. Fraley

SEPT. 6, 1946  
VERL R. FRALEY  
183

C-198-K-376

S. line N.E. 1/4 of N.E. 1/4  
Fence