

N.W. SEC. COR.
FND. RR. SPIKE

N 89° 41' 30" E

5344.00'

N.E. SEC. COR.
FND. IRON SPIKE

N 00° 11' 30" W

500° 09' 00" E

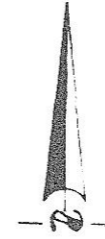

SECTION 24
T. 4 N. R. 24 E. W.M.

MORROW COUNTY, OREGON

CERTIFICATION

I, James J. Owens, hereby certify that this plan represents a survey conducted under my supervision in Dec. 1969, that the corners are set and the dimensions are correct and accurately reflect the intent of the legal description.

James J. Owens
James J. Owens
Oregon P.L.S. No. 884

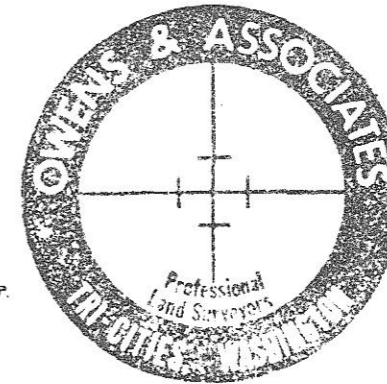

REGISTERED
OREGON
LAND SURVEYOR

James J. Owens
12/2/69
NOVEMBER 2, 1968
JAMES J. OWENS
884

NOTE: Hor. Datum- Harris & Assoc., Pendleton, Oregon

3968.03

3971.40

SET 3/4" I.P.

N 89° 43' 46" E
2671.38

5342.76
2671.38

SET 3/4" I.P.

TELEPHONE LINE

SET 3/4" I.P.
FOR FUTURE FENCE LINE

1024.7
1322.67

1323.80
1068.5

N 89° 44' 30" E
2670.90

5341.80
2670.90

S.E. SEC. COR.
SET 3/4" I.P.

SW SEC. COR.
SET 3/4" I.P.

ROY SMITH

SCALE	REVISIONS		BY	DATE
1" = 600'				
DATE				
12/2/69				
DR'N.	CKD.			
B.T.				
APVD.				
TITLE	NO.			
LEGAL SURVEY	10269			