

Record of Land Corner Monumentation

Section 32 Township 06S Range 26E Code T6S R26E Z07

County Morrow Date August 18, 2013

**History of Original Corner Establishment:**

The Original Monument was established in 1881 by E.W. Sanderson in an Original GLO Survey of Township 6 South Range, 26 East under Contract No. 368. A. F. York completed the North boundary of Township 7 South, Range 26 East in 1878. Sanderson retraced York's line and set the South monuments for this township on York's line.

Sanderson's Notes: Set 12x12x10 Stone in Stone Mound from which

A Pine 26" Ø bears South 30 lks

A Pine 9" Ø bears N 10° E 104 lks

**Description of evidence found:**

Found 2 of 2 Original Bearing trees as decribed in Sanderson's notes for this Section Corner. Used distances in Sanderson's notes to reestablish the location of the corner.

No other evidence found. Sanderson's notes for this corner are actually on his Page 2 (332) for the 1/4 set 80 CH to the West, S 1/4 of Section 31

Found Original BT, 6" Ø x 18" Rotten & Fallen Stump W/scribes  
N 13° 55' E 68.6 feet of set Monument

W/ Unmarked Bearing Object Placard on 6" Ø Pine 2.5 Ft. NE of BT

Found Original BT, 20" Ø x 30" Rotten Stump W/ Kinzua Placard,  
Ax marks, and scribe - S 06° 30' W 19.8 feet of set Monument

**Description of monumentation and accessories established to perpetuate the location of this Section Corner:**

Used the distances in Sanderson's notes to reestablish the location of the corner. Set 2 1/2" Brass Cap on 1" Iron Pipe in mound of stones located just to the southeast 2.5' of the base of a 12" Ø Ponderosa Pine tree.

In addition the following Bearing Trees were Blazed, Scribed, and tagged with placards as follows:

1 - A 16" Ø Ponderosa Pine bears N 54° 23' E 48.9 feet. Scribed "1/4 S32 BT"

2 - A 11" Ø Ponderosa Pine bears S 54° 12' E 66.2 feet. Scribed "1/4 S32 BT"

3 - A 18" Ø Ponderosa Pine bears S 44° 03' W 37.7 feet. Scribed "1/4 S32 BT"

4 - A 20" Ø Ponderosa Pine bears N 58° 21' W 41.9 feet. Scribed "1/4 S32 BT"

All directions on placards are given to the set monument.

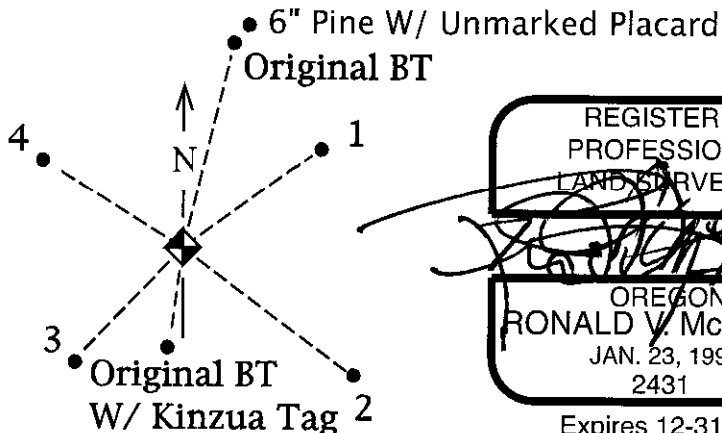
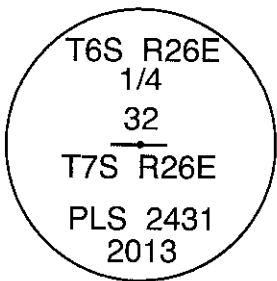

Expires 12-31-14

Office of Surveyor County of Morrow  
State of Oregon I hereby certify that the within instrument was  
filed in this office for record on the 15<sup>th</sup> day of April, 2014  
[Signature] by \_\_\_\_\_  
COUNTY OFFICIAL DEPUTY

Survey Number 2014-1697D