

# RECORD OF LAND CORNER MONUMENTATION

EAST 1/4 CORNER SECTION 17, T. 5 S., R. 28 E., W.M.

ORIGINALLY ESTABLISHED BY: Edward W. Sanderson, U.S. Deputy Surveyor

CONTRACT NUMBER: 417

CONTRACT DATE: August 24, 1881

**SUBSEQUENT SURVEYS:**

- ▶ 1938/1939 Dependant Resurvey by Leonard Carter, Public Land Surveyor for the General Land Office, under Group No. 228 approved May 2, 1938
- ▶ Remonumentation performed by Thomas F. Upton, PLS 1024, see corner certificate filed January 12, 1982 in the Morrow County Surveyor's records

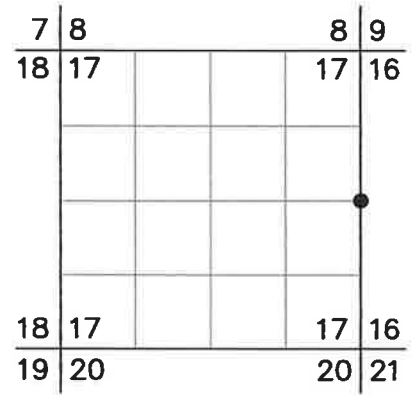

**1881 GLO DESCRIPTION:** Set a sandstone 18x12x10 ins 12 ins in ground for 1/4 Sec. Cor. marked 1/4 on w. face from which  
 A black pine 8 in dia bears N.65°W 35 lks dist. marked 1/4S.B.T.  
 A black pine 9 in dia bears S.70°E 26 lks dist. marked 1/4S.B.T.

**1938 GLO DESCRIPTION:** Proportionate measurement, Set an iron post, 3 ft. long, 1 in. diam., 28 ins. in the ground, for 1/4 sec. cor., with brass cap mkd. (diagram shown) from which  
 A tamarack, 18 ins. diam., bears N.55°E., 25 lks. dist., mkd. 1/4 S 16 B T.  
 A tamarack, 12 ins. diam., bears S.18°W., 48 lks. dist., mkd. 1/4 S 17 B T.

**UPTON'S DESCRIPTION:** 1 inch iron pipe, with 2 1/2 inch brass cap marked as shown above, from which—  
 20" Tamarack, dead and down, bears easterly 20', scribing 1/4 S 16 BT legible.  
 No evidence of original Bearing Tree for Section 17 found.  
 From Corner location as found and described above,  
 New Bearing Tree, 11" White Fir, bears N 42° E a distance of 26.3 feet, which I marked "1/4 S 16 BT".  
 New Bearing Tree, 11" White Fir, bears N 82° W a distance of 12.6 feet, which I marked 1/4 S 17 BT.

**EVIDENCE FOUND:** Found 1" iron pipe with attached 2 1/2" GLO brass cap (marked as shown below), projecting 10" above ground with no visible mound of stone. From which:  
 ▶ A white fir snag, 7 feet tall, bears N.82°W., 12.6 ft. with scribing "1/4 S17 BT" visible in upper blaze and scribing "BT" visible in lower blaze  
 ▶ No remains of Upton's NE bearing tree could be found, as the position falls in a skid trail

**DESCRIPTION OF MONUMENTS AND ACCESSORIES SET AND METHODS USED:**  
 I accept the found brass-capped monument for the true corner position.

**I SET THE FOLLOWING REFERENCE POINTS:**

- ▶ A 5/8"x30" iron pin driven flush with the ground bears N.66°E., 15.03 ft., with attached 2" aluminum cap marked "RP 1 2021 PLS 69454"
- ▶ A 5/8"x30" iron pin driven flush with the ground bears S.54°E., 16.70 ft., with attached 2" aluminum cap marked "RP 2 2021 PLS 69454"
- ▶ A 5/8"x30" iron pin driven flush with the ground bears S.43°W., 16.85 ft., with attached 2" aluminum cap marked "RP 3 2021 PLS 69454"
- ▶ A 5/8"x30" iron pin driven flush with the ground bears N.42°W., 22.1 ft., with attached 2" aluminum cap marked "RP 4 2021 PLS 69454"

Painted a 6 inch red band around the found bearing tree, and also painted the blazes red, and attached USFS signs 54-3 and 54-9. Distances to accessories measured with a steel tape. Bearings were measured with a magnetic compass with 14° East declination.

MONUMENT MARKED:

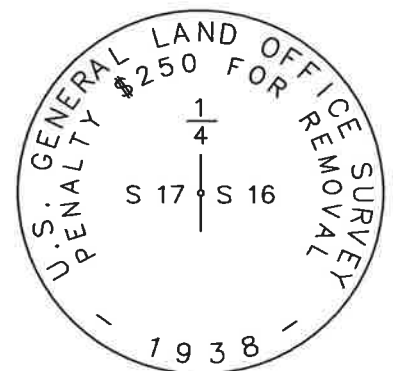

**RESTORATION BY, STAMP AND DATE:**

Work Performed September 29, 2021 by:

Jason L. Hatfield, PLS  
 Reid Kelly

USDA FOREST SERVICE  
 NORTHEAST OREGON LAND ZONE  
 1550 Dewey Avenue, Suite A  
 Baker City, OR 97814  
 (541) 523-1337

**RECEIVED BY**  
 Morrow County Surveyor

Date: 1-5-2022  
 Rec'd By: MPK  
 No.: 5528L9  
~~Folder No.:~~ \_\_\_\_\_



EXPIRES: 6/30/2023