

CERTIFIED RECORD OF LAND CORNER MONUMENTATION

K-17

History of original corner establishment:

Unsurveyed - subdivided Section.

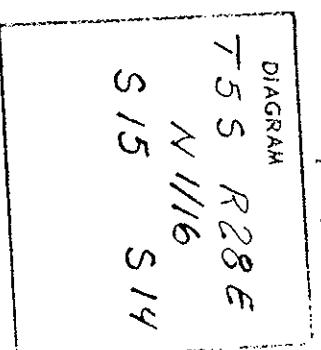

No record of subsequent remonumentation found in County Records.

Description of corner evidence found:

No evidence found.

I set the monument described below at the midpoint between the found W 1/2 and the NE corner of Section 15.

REGISTERED  
PROFESSIONAL  
LAND SURVEYOR

*Terry E. Hamby*  
OREGON  
JULY 14, 1978  
TERRY E. HAMBY  
1638

Description of monument and accessories established to perpetuate the original location of this corner

At the position described above, I set a 2 1/2" x 30" iron pipe 23" in the ground, with a brass cap marked as shown:

From which I scribed BTs:

A tamarack 10" in diam. bears S 36° E 12.55' marked N 1/16 S 1/4 BT with signs.  
A fir 9" in diam. bears S 77° W 25.3' marked N 1/16 S 15 BT with signs.

I nailed a brass washer marked PLS 1638 to the BT blazes.

I set a steel fence post 5' North and 5' West.

I painted a red band around the BTs and face of scribe.

I used a steel tape and a magnetic compass with 21° East variation and measured a horizontal distance to the center of BTs.

This corner was set October 23, 1979.

Witness by W. Keith Sands.

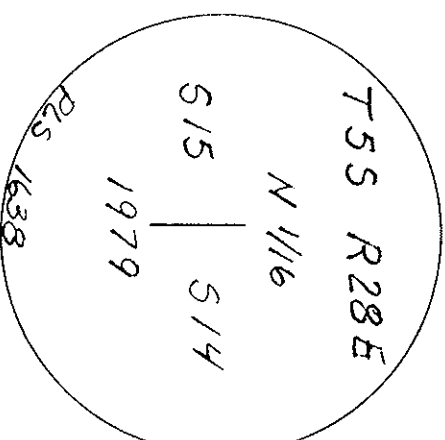

Office of ..... County Surveyor ..... County of ..... Morrow  
State of Oregon ..... I hereby certify that the within instrument was filed in this office  
for record on the ..... day of ..... 1979  
*David H. Peden* by .....  
(COUNTY OFFICIAL) (DEPUTY)

RECEIVED BY  
Morrow County Surveyor  
Date 10-10-79  
Rec'd By *WAT*