

# RECORD OF LAND CORNER MONUMENTATION

SOUTHEAST CORNER SECTION 9, T. 5 S., R. 28 E., W.M.

ORIGINALLY ESTABLISHED BY: Edward W. Sanderson, U.S. Deputy Surveyor

CONTRACT NUMBER: 417

CONTRACT DATE: August 24, 1881

**SUBSEQUENT SURVEYS:**

- ▶ 1938/1939 Dependant Resurvey by Leonard Carter, Public Land Surveyor for the General Land Office, under Group No. 228 approved May 2, 1938
- ▶ Remonumentation performed by David L. Haddock, PLS 852, see corner certificate filed 11/92 in the Morrow County Surveyor's records

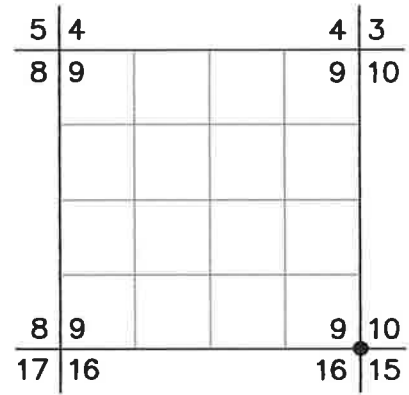

**SANDERSON'S 1881 DESCRIPTION:** Set sandstone 18x12x10 ins 12 ins in ground for Cor. to Secs. 9, 10, 15 and 16 marked with 4 notches on South and 3 notches on E. edges. from which  
 A Fir 12 in dia bears N15°E, 35 lks dist, marked T.5S. R.28E. Sec. 10 B.T.  
 A Fir 10 in dia bears N35°W, 18 lks dist, marked T.5S. R.28E. Sec. 9 B.T.  
 A Black pine 8 in dia bears S40°W, 24 lks dist, marked T.5S. R.28E. Sec. 16 B.T.  
 A Black pine 6 in dia bears S50°E, 16 lks dist, marked T.5S. R.28E. Sec. 15 B.T.

**CARTER'S 1939 DESCRIPTION:** Proportionate measurement, set an iron post, 3 ft. long, 2 ins. diam., 28 ins. in the ground, for cor. of Secs. 9, 10, 15 and 16, with brass cap mkd. (diagram shown), from which:  
 A spruce, 12 ins. diam., bears N.16°E., 142 lks. dist., mkd. T 5 S R 28 E S 10 B T  
 A Douglas fir, 13 ins. diam., bears S.54½°E., 51 lks. dist., mkd. T 5 S R 28 E S 15 B T  
 A tamarack, 5 ins. diam., bears S.52°W., 39 lks. dist., mkd. T 5 S R 28 E S 16 B T  
 A tamarack, 5 ins. diam., bears N.9½°W., 34 lks. dist., mkd. T 5 S R 28 E S 9 B T

**HADDOCK'S 1992 DESCRIPTION:** Found the iron pipe with standard GLO brass cap stamped as shown in the diagram. From which:  
 A 19" dbh Douglas Fir bears S.52°22'E., 33.2' with healed blaze.  
 A 9" Tamarack bears N9°23'W, 22.1' with healed blaze.  
 A 17" Engleman Spruce, dead and down, bears N16°E, 93.7' with healed blaze.  
 I set the following new witness tree:  
 A 11" dbh Tamarack bears N71°46'E, 20.7' scribed T5SR28ES10BT;  
 A 13" dbh Tamarack bears S74°13'W, 53.8' scribed T5SR28ES16BT

**EVIDENCE FOUND:** Found a 2" iron pipe with attached 2½" GLO brass cap (marked as shown below) projecting 6" above ground with no visible mound of stone. From which, I found the following bearing trees:  
 ▶ A western larch, dead and down, bears N.71°46'E (1992 BT).  
 ▶ A western larch, 20" dbh, bears S.74°13'W., 53.8 ft. with healed blaze (1992 BT)  
 ▶ A western larch high stump, 5.5 ft. tall, bears N.9°23'W., 22.1 ft. with healed blaze (1939 BT)

**DESCRIPTION OF MONUMENTS AND ACCESSORIES SET AND METHODS USED:**  
 I accept the found brass-capped monument for the true corner position.

MONUMENT MARKED:

**I also SET THE FOLLOWING REFERENCE POINTS:**

- ▶ A 5/8"x30" iron pin driven flush with the ground bears S.45°E., 10.30 ft., with attached 2" aluminum cap marked "RP 1 2021 PLS 69454"
- ▶ A 5/8"x24" iron pin driven flush with the ground bears N.45°W., 9.61 ft., with attached 2" aluminum cap marked "RP 2 2021 PLS 69454"

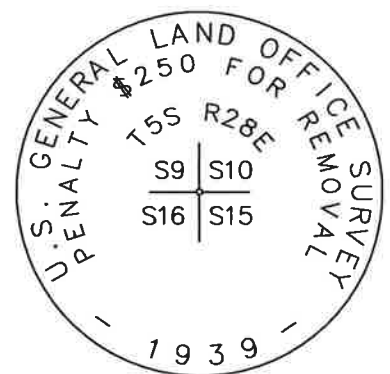

Painted a 6 inch red band around the bearing trees, and also painted the blazes red, and attached USFS signs 54-3 and 54-9. Distances measured with a steel tape. Bearings were measured with a magnetic compass with 14° East declination. A steel T post bears South 4 feet with USFS signs 54-2 and 54-9 attached.

**RESTORATION BY, STAMP AND DATE:**

Work Performed October 6, 2021 by:

Jason L. Hatfield, PLS

USDA FOREST SERVICE  
 NORTHEAST OREGON LAND ZONE  
 1550 Dewey Avenue, Suite A  
 Baker City, OR 97814  
 (541) 523-1337

**RECEIVED BY**  
 Morrow County Surveyor  
 Date: 1-5-2022  
 Rec'd By: MAK  
 No.: 5528513  
 Folder No.: \_\_\_\_\_

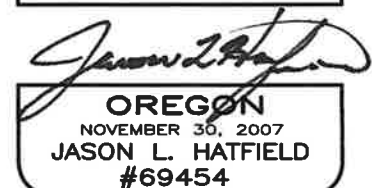

EXPIRES: 6/30/2023