

**OREGON CORNER RESTORATION FORM**

COUNTY: Morrow DATE: 05/14/04

CORNER DESIGNATION: G-9, The East Quarter Corner of Section 8, Township 5 South, Range 27 East, W.M., Morrow County, Oregon.

PREVIOUS RENEWALS/SURVEYS ETC.: Corner originally established by Edward W. Sanderson under Contract No. 417, dated August 24, 1881. Record states: Set basalt stone 12 x 10 x 6 ins 8 ins in ground for 1/4 Sec. Cor. marked 1/4 on W. face, raised mound of stone alongside.

**MONUMENT AND ACCESSORIES FOUND:**

Found 9 by 9 by 5" set basalt stone, at West side of 3 foot diameter mound of stones.

**MONUMENT MARKING DETAIL:**

T5S R27E  
1/4  
S8 | S9  
2004  
PLS 1106

MONUMENT SET: Corner falls on diced basalt rock ridge with soil depth of about 2". At the position of found original stone I set a 2 1/2" brass disk in drilled hole and cemented it with grout. The top of the brass disk is 2" below ground level. Disk is marked as shown in "Monument Marking Detail".

**New Accessories:**

- A 5/8" x 24" iron rebar with yellow plastic cap stamped "OR PLS 1106, WA PLS 17372", bears N 40° E, 61.5 feet.
- A 5/8" x 24" iron rebar with yellow plastic cap stamped "OR PLS 1106, WA PLS 17372", bears S 46° E, 74.5 feet.
- A 5/8" x 24" iron rebar with yellow plastic cap stamped "OR PLS 1106, WA PLS 17372", bears S 17° W, 58.4 feet.
- A 5/8" x 24" iron rebar with yellow plastic cap stamped "OR PLS 1106 WA PLS 17372", bears N 16° W, 48.5 feet.

Wired bearing object signs to all rebar accessories. Built small mound of stones around brass disk with original stone on West side, (soil is very poor, rocky on a plateau).

**LOCATION AND COMMENTS:** Corner is located at the West side of a bare diced rock ridge.

There is road about 800 feet East of Corner.

FIRM: William R. Wells, PLS  
P.O. Box 1696  
Pendleton, OR 97801

COMPASS DECLINATION: 18° East Surveyor's Seal

Witnesses: Jason Wells, LSIT  
Marc Hammerla

/5S27G9

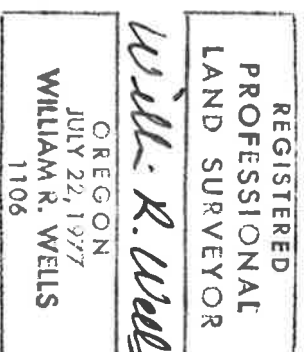

*Renews 6-30-06*

**RECEIVED BY**  
Morrow County Surveyor

Date: 1-08-05  
Rec'd By: R V M  
No.: D-1409-M  
Folder No.: \_\_\_\_\_