

OREGON CORNER RESTORATION FORM

COUNTY: Morrow DATE: 09/19/16

CORNER DESIGNATION: T4S., R26E., W.M., J-13. The Northwest corner of Section 15.

PREVIOUS RENEWALS/SURVEYS ETC.:

Corner originally established by Deputy Surveyor Z. F. Moody under Contract No. 184, dated March 29, 1873. Notes state: Set stone 14 x 10 x 6 in earth mound for cor. to Secs. 15-16-9-10. No record of subsequent remonumentation was found in County Survey Records.

MONUMENT AND ACCESSORIES FOUND:

Found a 4-way fence corner with fences North-South and East-West. There are no stones at the fence intersection but there are piles of stone 25' +- to the East from an old gate and in a fence jack 20' +- South of the corner. I looked for the corner stone in stone piles and fence jack but found no stone of near record size. The area has been previously farmed and the field in the NW quadrant is an old CRP field.

MONUMENT MARKING DETAIL:

T4S R26E
S9 | S10

S16 | S15
2016
PLS 1106

RECEIVED BY
Morrow County Surveyor
Date: 10-11-2016
Rec'd By: S.K.H.
No.: 4526J13
Folder No.: _____

MONUMENT SET:

I accepted this fence corner as the best remaining evidence of the corner location. At the Southwest side of the fence corner post, set a 2 3/8" brass cap on 1 1/4" X 30" galvanized iron pipe 23" in the ground and surrounded with a 2 foot diameter collar of stone. The monument cap is stamped as shown in Monument Marking Detail.

New Accessories:

- A 5/8" x 24" iron rebar with 1 1/4" red plastic cap marked "OR PLS 1106 WA PLS 17372" bears North, 25.3 feet, in a fence line extending North.
- A 5/8" x 24" iron rebar with 1 1/4" red plastic cap marked "OR PLS 1106 WA PLS 17372" bears South 87° East, 36.6 feet, in a fence line extending East.
- A 5/8" x 24" iron rebar with 1 1/4" red plastic cap marked "OR PLS 1106 WA PLS 17372" bears South 05° West, 37.3 feet in a fence line extending South.
- A 5/8" x 24" iron rebar with 1 1/4" red plastic cap marked "OR PLS 1106 WA PLS 17372" bears South 89° West, 29.2 feet, in a fence extending West.

Wired Bearing Object signs to all rebar accessories. Wired Witness sign to the fence corner post by the corner monument.

LOCATION AND COMMENTS: Corner is located on a North slope at 4-way fence intersection.

FIRM: Wells Surveying
P.O. Box 1696
Pendleton, OR 97801

COMPASS DECLINATION: 18° East

Surveyor's Seal

Witnesses: Dean Roy

4S26J-13

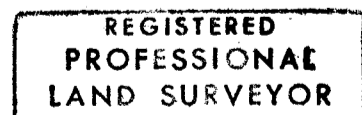

Will R. Wells

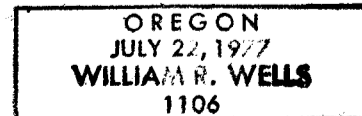

renews 6-30-18