

OREGON CORNER RESTORATION FORM

Section 18 Township 4S Range 25E
County Morrow Date: April 24, 1999

Corner Designation: 4S25L1

quarter corner to section 18, R25E, and
section 13, R24E of T4S, W.M., Morrow County, Oregon

Condition Report Only
Not found
 Remonumented
 Unrecorded
 Surveyed in
 Referenced out

Previous Renewals / Surveys, etc.

Corner originally set by Zenas F. Moody under contract No. 184 Dated March 29, 1873.
His record reads: Set stone 16x13x9 for 1/4 sec. cor.

Monument and Accessories found: (condition and source)

Found the stone plainly chisled 1/4 with one other stone set on a bare area of thin soil. The stone was firmly in place with the 1/4 on the west face.

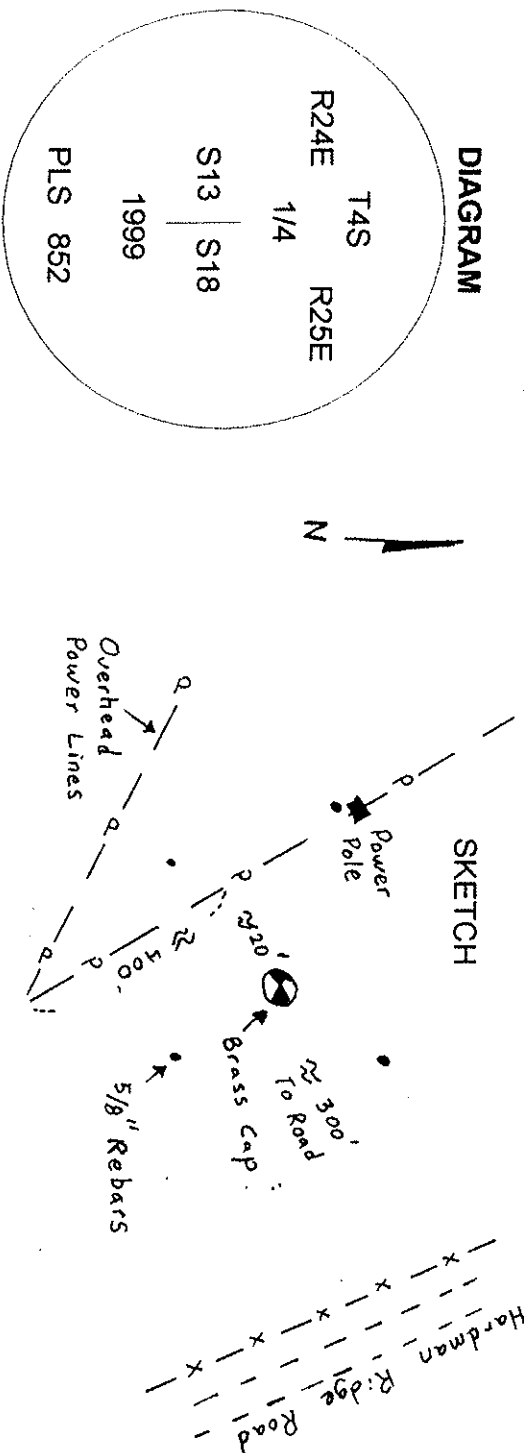

MONUMENT (S) AND ACCESSORIES SET (Procedures and Description)

Set a 1 1/4" x 30" Galvanized Iron Pipe with a 2 1/2" brass cap stamped a shown in the diagram above at the position of the stone. I set a PK nail in the bedrock approximately 1 foot below the surface and set the brass cap over the top of it and built a stone mound around the monument. The original stone was buried in the mound at the foot of the pipe.

For references, I set four 5/8" by 24" rebars with 1.25" red plastic caps stamped ORLS 852 and WALS 13922 as described below:

- an iron rebar bears N45°29'W, 93.91 feet at the foot of power pole;
- an iron rebar bears S21°48'W, 43.71 feet;
- an iron rebar bears S40°35'E, 50.69 feet;
- an iron rebar bears N28°49'E, 21.21 feet;

The monument and references were tied using a LIECA system 300 RTK GPS.

Location and comments

Compass Declination

Surveyors Seal

RECEIVED BY:
Morrow County Surveyor
Date:
Rec'd By:
No.

Firm / Agency
Haddock Surveying
Address
P.O. Box 1574
Pendleton, Or. 97801
Party Chief
Stephen K, Haddock

REGISTERED
PROFESSIONAL
LAND SURVEYOR

David L. Haddock

OREGON
JULY 12, 1966
DAVID L. HADDOCK
852