

OREGON CORNER RESTORATION FORM

SECTION: 2 TOWNSHIP: 4N RANGE: 26E C-17

COUNTY: UMATILLA DATE: 4/2014

CORNER DESIGNATION

W ¼ COR.

 CONDITION REPORT ONLY
 NOT FOUND
 X **RENEWED**
 UNRECORDED
 SURVEYED IN
 X **REFERENCED OUT**

PREVIOUS RENEWALS/SURVEYS ETC.

Originally surveyed by Thompson and others in 1869 under contract 131.

In 1939 Gould did a dependent resurvey.

In 2003 Edwards set a 5/8" by 30" iron rebar with a 2" alum. cap stamped as below from Goulds 1939 2 ½" brass cap witness corner 19.8' (30 links) to the East. See Co. Sur. #1695.

MONUMENTS AND ACCESSORIES FOUND: CONDITON AND SOURCE

Found a 2" alum. cap stamped as below.

Found Goulds 2 ½" Brass Cap witness corner which has been moved by, I assume, lawn landscaping. It was N 89° 33' E 19.80 feet from the ¼ cor. in 2003 and is now N 88° 32' E 17.55 feet.

MONUMENT DETAIL

T4N R26E
1/4
S3 | S2
2003
LS 951

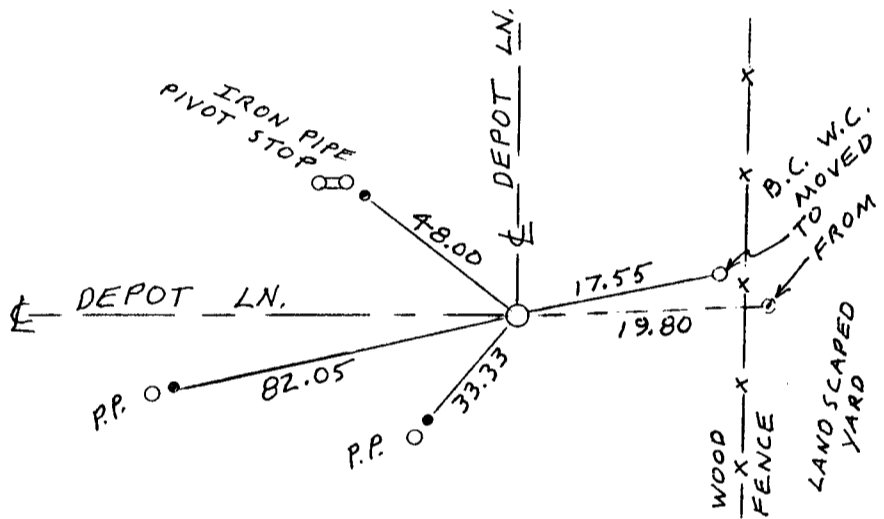

MONUMENT SET (PROCEDURES AND DESCRIPTION)

NEW ACCESSORIES FROM WHICH

A 5/8" x 30" Iron Rebar with plastic cap #951 bears N 44° 00' W 48.00'

A 5/8" x 30" Iron Rebar with plastic cap #951 bears S 35° 43' W 33.33'

A 5/8" x 30" Iron Rebar with plastic cap #951 bears S 74° 11' W 82.05'

Goulds moved 2 ½" Brass Cap bears N 88° 32' E 17.55'

LOCATION AND COMMENTS

From the intersection of Patterson Ferry Road with Depot Lane, go East on Depot Lane 1 mile to corner.

RECEIVED BY
Morrow County Surveyor
Date: 2-25-16
Rec'd By: S.K.H.
No.: 4/126 C17
Folder No.:

**FIRM: EDWARDS SURVEYING LLC
PO BOX 763 - HERMISTON OR 97838**

**PARTY CHIEF: G. EDWARDS
WITNESS: R. FRITZ**

SURVEYOR'S SEAL

REGISTERED
PROFESSIONAL
LAND SURVEYOR

G. Dennis Edwards

OREGON
JULY 16, 1971
G. DENNIS EDWARDS
951

RENEWS 12/31/15