

OREGON CORNER RESTORATION FORM

SECTION 23 TOWNSHIP 4 NORTH RANGE 24 EAST R-17

COUNTY : MORROW DATE 2-1998
FILED: 9-2005

CORNER DESIGNATION

SW COR.

— CONDITION REPORT ONLY
— NOT FOUND
— RENEWED
— UNCOVERED
— SURVEYED IN
X REFERENCED

PREVIOUS RENEWALS / SURVEYS, ETC.

ORIGINAL SURVEY BY THOMPSON ET AL UNDER CONTRACT #131 IN 1869.
IN 1965 ASCHER SET 3" I.D. IRON PIPE IN SURVEY FOR BOEING.

MONUMENTS AND ACCESSORIES FOUND: CONDITION AND SOURCE

3" I.D. IRON PIPE AT FENCE CORNER.

MONUMENT DETAIL

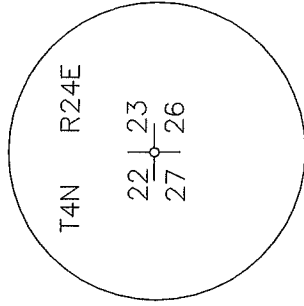

SKETCH

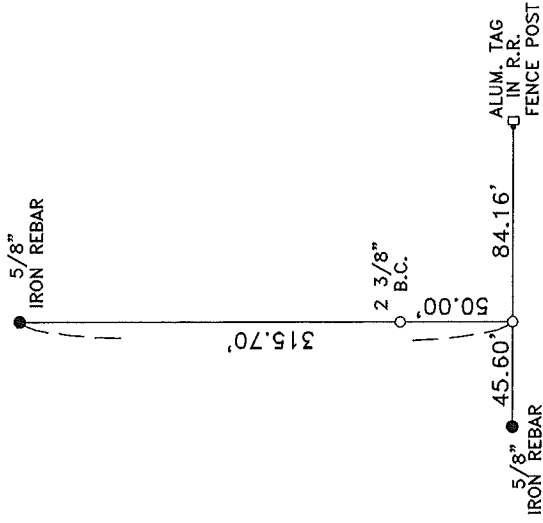

MONUMENT SET (PROCEDURES AND DESCRIPTION)

NEW ACCESSORIES FROM WHICH

A 5/8"X30" IRON REBAR WITH PLASTIC CAP #951 BEARS S 89°39'50" W 45.60 FEET.
A 5/8"X30" IRON REBAR WITH PLASTIC CAP #951 BEARS N 0°23'32" W 315.70 FEET.
A 1"X30" IRON PIPE WITH 2 3/8" BRASS CAP BEARS N 0°23'32" W 50.00 FEET.
AN ALUM. TAG #951 IN A R.R. TIE FENCE POST BEARS N 89°59'06" E 84.16 FEET.

LOCATION AND COMMENTS

FROM INTERSECTION OF TOM'S
CAMP RD. WITH KUNZE RD. GO
WEST ALONG KUNZE RD. 1 MILE
TO A FENCE COR. THEN GO
SOUTH ALONG FENCE 1 MILE
TO CORNER ON NORTH BOUNDARY
OF BOMBING RANGE.

COMPASS DEC.

FIRM/AGENCY
EDWARDS SURVEYING
P.O. BOX 763
HERMISTON, OREGON 97838

PARTY CHIEF

G. DENNIS EDWARDS

NOTES

WITNESS
JUD COPPOCK

SURVEYOR'S SEAL

REGISTERED
PROFESSIONAL
LAND SURVEYOR

OREGON
JULY 16, 1971
G. DENNIS EDWARDS
9 5 1

RENEWS 12/31/2005