

OREGON CORNER RESTORATION FORM

Section 32 Township 3S Range 29E
 County Morrow Date: August 3, 2005

Corner Designation: 3S29V7

Quarter corner to sections 29 and 32, T3S, R29E, W.M., Morrow County, Oregon.

Previous Renewals / Surveys, etc.

Corner originally set by George Williams under contract No. 176 dated July 20, 1872. His record reads: Set stone 21 x 7 x 3 for 1/4 sec. cor.

Monument and Accessories found: (condition and source)

None at the corner point. A 3/4" iron pipe in a rock jack bears S46°01'11"W, 340.3 feet. This jack is in an old east - west fence line. All that remains of the fence are the jacks.

DIAGRAM

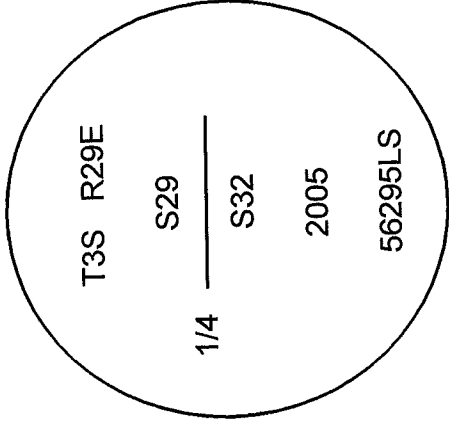

SKETCH

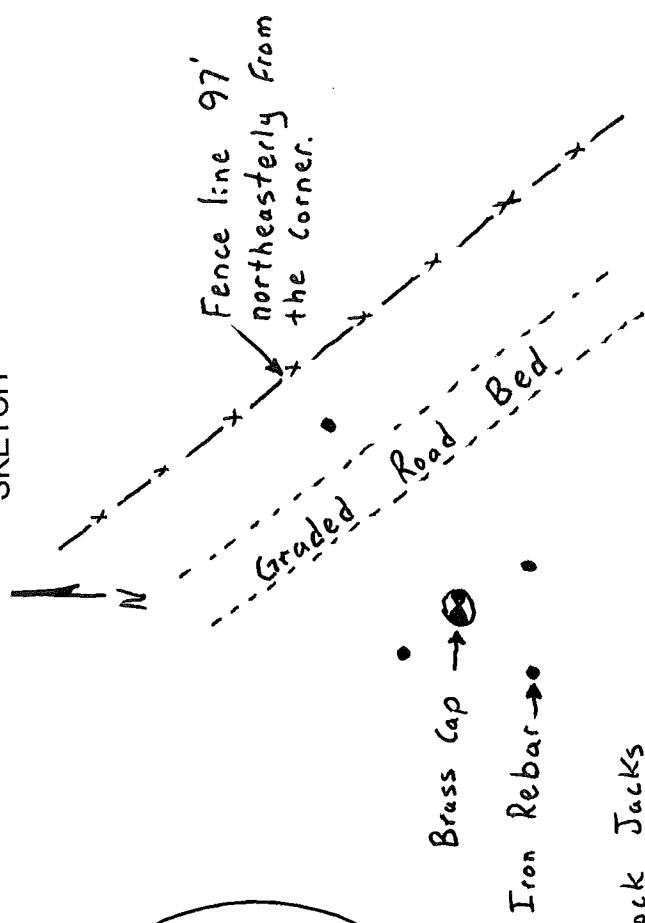

Line of old Rock Jacks

MONUMENT (S) AND ACCESSORIES SET (Procedures and Description)
 At the proportionate point I set a 1" x 24" Iron rebar with a 2" aluminum cap stamped as shown in the diagram above 18" in the ground to bedrock. I raised a mound of earth and stone 2' diameter to the top of the cap.

For references, I set four 5/8" by 18" rebars with 1 1/8" orange plastic caps stamped WTS and 56295LS to bedrock as described below:
 an iron rebar bears N54°35'10"W, 51.09 feet;
 an iron rebar bears S48°46'29"W, 51.96 feet;
 an iron rebar bears S46°42'44"E, 39.25 feet;
 an iron rebar bears N45°33'07"E, 79.34 feet;

The monument and references were tied using a Trimble R7/R8 RTK GPS.

Location and comments

Compass Declination

Surveyors Seal

**REGISTERED
 PROFESSIONAL
 LAND SURVEYOR**

Firm / Agency
 Witness Tree Surveying
 Address
 P.O. Box G
 Pilot Rock, Or. 97868
 Party Chief
 Stephen K, Haddock

RECEIVED BY:
 Morrow County Surveyor
 Date: AUG 30 2005
 Rec'd By: SKG
 No. _____

Stephen K. Haddock

OREGON
 JULY 9, 2001
 STEPHEN K. HADDOCK
 56295LS

RENEWAL DATE 6-30-07