

RECORD OF LAND CORNER MONUMENTATION

CORNER: NE Cor. Sec. 8, Twp. 3S., R.26E., W.M.

ORIGINAL SURVEY BY: George Williams, U.S. Deputy Surveyor

CONTRACT NUMBER: 176

CONTRACT DATE: July 20, 1872

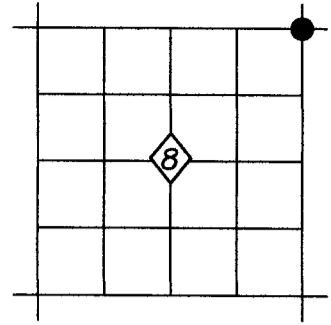

ORIGINAL G.L.O. DESCRIPTION: Set Stone 23x7x6 for corner to Sections 4, 5, 8, 9 on top of flat hill.

EVIDENCE FOUND: After a diligent search, I was unable to find original GLO evidence at this corner location. I did locate the shoulders and right of way fences for County Road No. 614 to the East and South of the search area for this corner.

I also searched the County Road Department file for County Road 614. The documentation for this road, including the original petition dated March 8, 1888, indicate that this section corner should be located at the centerline intersection of Stock Drive Road (County Road 614) as it transitions from an East-West Direction to a North-South direction. I found very little consistency in the width and alignment when using the shoulders of the existing road to determine a centerline intersection. I found that the right of way fences were a better indication of the actual location of the county road centerline. I held the midpoint between right of way fences as the centerline of the county road which is coincident with the east line of said Section 8. A North-South fence line to the West of this corner is within 2.5 feet of the GLO record distance to the N1/4 Corner. At the search point for the N1/4 Corner of Section 9, I found an East-West fence line 7 feet North. Also from the NE Corner of Section 8, the rock crib accepted by Wayne Harris is 4 feet South and 12 feet East of the GLO record for the NW Corner of Section 4.

DESCRIPTION OF MONUMENT AND ACCESSORIES SET:

At the centerline intersection of County Road 614 as determined above, I set a 5/8" X 30" iron pin with attached 2 1/2" aluminum cap, 30" in the ground. Cap is marked as shown below.

FROM WHICH, I set the following reference points:

A 5/8"x30" iron pin bears N.50°52'E., 44.67 ft., with attached yellow plastic cap marked BENCHMARK SURVEYING (set near East-West fence line)

A 5/8"x30" iron pin bears S.37°58'E., 44.50 ft., with attached yellow plastic cap marked BENCHMARK SURVEYING

A 5/8"x30" iron pin bears S.72°42'W., 28.46 ft., with attached yellow plastic cap marked BENCHMARK SURVEYING

A 5/8"x30" iron pin bears N.32°50'W., 33.35 ft., with attached yellow plastic cap marked BENCHMARK SURVEYING (set near East-West fence line)

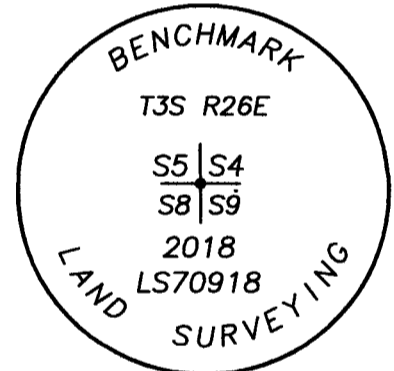

Used RTK GPS to measure RP's. Bearings to RP's are based on Geodetic North from a GPS observation taken near the Northeast Corner of Section 8, T3S., R.26E., W.M.

RESTORATION BY:

Michael C. Springer, PLS
217 N. Canyon Blvd.
John Day, OR, 97845
(541) 575-1251

Surveyed October 1, 2018

RECEIVED BY
Morrow County Surveyor

Date: 10-22-2018
Rec'd By: S.K.H.
No.: 3526E9
Folder No.: _____

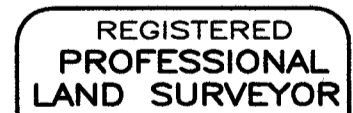

EXPIRES: 6/30/2020