

OREGON CORNER RESTORATION FORM

Section 10 Township 3S Range 25E  
County Morrow Date: January 14, 1999

Corner Designation: 3S25G13

Quarter corner common to sections 9 and 10,  
T3S, R25E, W.M.

Condition Report Only  
Not found   
Remonumented   
Unrecorded   
Surveied in   
Referenced out

Previous Renewals / Surveys, etc.

The corner was originally established by D. Thompson under contract No. 122 approved november 5, 1867. His record reads "Set stone 24x12x8 for 1/4 Sec. Cor. in a ravine which bears E. & W..

Monument and Accessories found: ( condition and source )

Found a record size unmarked stone in place approximately 2 feet north of a fence corner rock jack. Lines of rock jacks could be plainly seen running west and north. The wire was removed but there were still some wooden posts in the jacks.

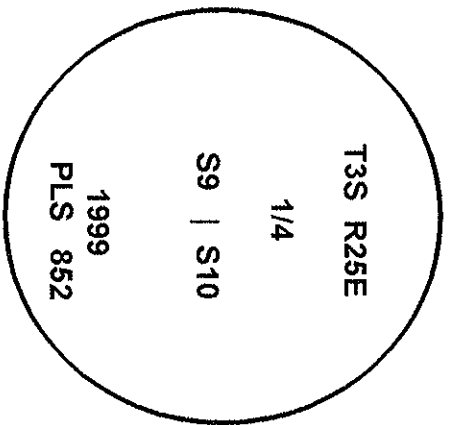

DIAGRAM

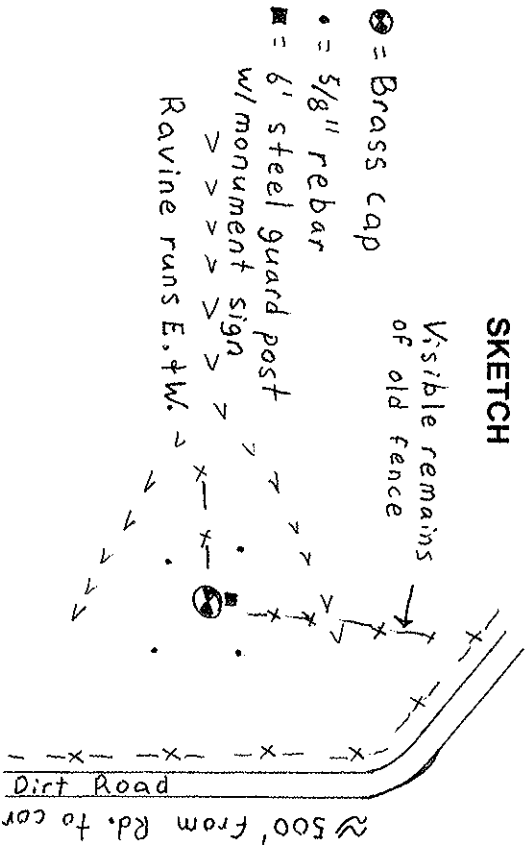

SKETCH

MONUMENT (S) AND ACCESSORIES SET (Procedures and Description)

Set a 2 1/4 inch brass cap on a 1 1/8" x 30" galvanized iron pipe stamped as shown in the diagram above 1 foot in the ground. Raised a mound of stone w/3" base and 18" around the cap. Burried the stone in the mound.

REFERENCES SET:

- A 5/8" x 24" rebar with a 1 1/8 inch red plastic cap stamped ORLS 852 and WALS 13922 bears N28°54'08"W a distance of 43.68 feet.
- A 5/8" x 24" rebar with a 1 1/8 inch red plastic cap stamped ORLS 852 and WALS 13922 bears N20°02'46"E a distance of 53.70 feet.
- A 5/8" x 24" rebar with a 1 1/8 inch red plastic cap stamped ORLS 852 and WALS 13922 bears S58°42'54"E a distance of 57.02 feet.
- A 5/8" x 24" rebar with a 1 1/8 inch red plastic cap stamped ORLS 852 and WALS 13922 bears S54°19'39"W a distance of 50.88 feet.

Location and comments  
Monument and references  
located using GPS.

Compass Declination

Surveyors Seal

RECEIVED BY:  
Morrow County Surveyor  
Date:  
Rec'd By:  
No.

Firm / Agency  
Haddock Surveying  
Address  
P.O. Box 1574  
Pendleton, Or. 97801  
Party Chief  
Stephen K, Haddock

