

OREGON CORNER RESTORATION FORM

CORNER DESIGNATION: T2S, R28E, R-13

SOUTHEAST CORNER OF SECTION 21, TOWNSHIP 2 SOUTH, RANGE 28 EAST, W.M., MORROW COUNTY, OREGON.

PREVIOUS RENEWALS / SURVEYS, ETC.:

T2S R28E WAS ORIGINALLY SUBDIVIDED BY U.S. DEPUTY SURVEYORS GEORGE WILLIAMS AND GEORGE S. PERSHIN UNDER CONTRACT NO. 154 DATED JUNE 6, 1871. THE NOTES READ, "SET A STONE 16X8X6 ON N.W. HILLSIDE FOR CORNER TO SEC. 21, 22, 27 AND 28".

MONUMENT AND ACCESSORIES FOUND:

FOUND RECORD STONE PLAINLY MARKED WITH AT LEAST 3 VISIBLE NOTCHES ON NORTH SIDE. STONE PLANTED VERTICALLY WITH APPROXIMATELY 6" EXPOSED ABOVE SURFACE. STONE IS IN UNDISTURBED AND IN VERY GOOD CONDITION.

MONUMENT AND ACCESSORIES SET:

AT LOCATION OF FOUND STONE, SET 2-3/8" BRASS CAP ON 2-3/8" O.D. X 30" GALVANIZED IRON PIPE, WITH CAP ± 4" ABOVE GRADE, MARKED AS SHOWN IN DETAIL BELOW. ESTABLISHED 4 REFERENCE MONUMENTS AS FURTHER DESCRIBED AND DETAILED BELOW. BURIED STONE AT NORTHWEST (DOWNHILL) SIDE OF CAP.

REFERENCES:

- (A) SET 5/8" X 30" STEEL REBAR WITH PINK PLASTIC CAP. CORNER BEARS S 62° W. 10.00'.
- (B) SET 5/8" X 30" STEEL REBAR WITH PINK PLASTIC CAP. CORNER BEARS S 26° E. 10.00'.
- (C) SET 5/8" X 30" STEEL REBAR WITH PINK PLASTIC CAP. CORNER BEARS N 53° E. 10.00'.
- (D) SET 5/8" X 30" STEEL REBAR WITH PINK PLASTIC CAP. CORNER BEARS N 25° W. 10.00'.

DIAGRAM:

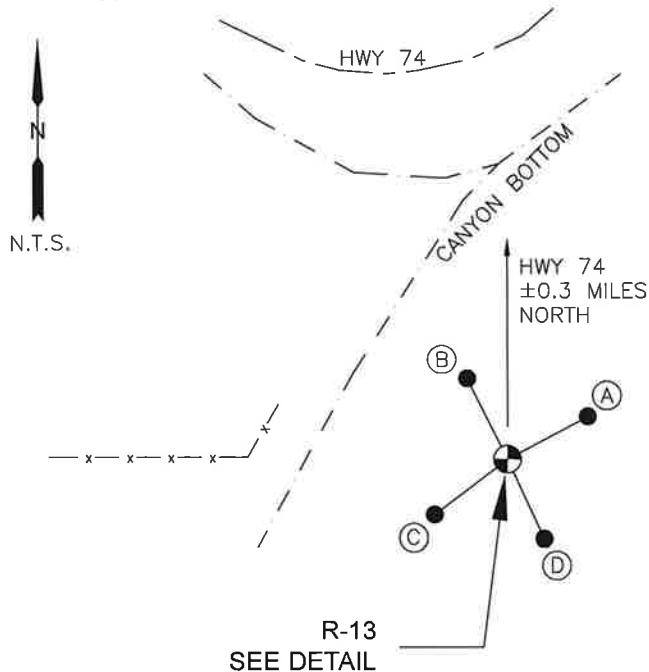

R-13 DETAIL:

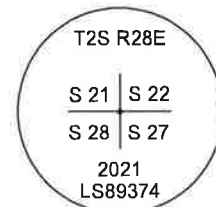

LOCATION AND COMMENTS:

CORNER IS APPROXIMATELY 0.3 MILES SOUTH OF HWY 74 ON NW HILLSIDE AND ON EASTERLY EXTENSION OF EXISTING FENCE LINE FROM THE WEST

**REGISTERED
PROFESSIONAL
LAND SURVEYOR**

Matthew Patrick Kenny

OREGON
JAN 12, 2016
MATTHEW PATRICK KENNY
89374PLS

RENEWALS: 6-30-21

FIRM/AGENCY:

KENNY LAND SURVEYING
P.O. BOX 447 HEPPNER,
OR 97836
PARTY CHIEF: MATT KENNY

BEARING BASE:

REPORTED BEARINGS ARE
HAND HELD COMPASS BEARINGS
TAKEN TO THE NEAREST DEGREE
DECLINATION = 15° E