

OREGON CORNER RESTORATION FORM

CORNER DESIGNATION: T2S, R28E, P-9

WEST QUARTER CORNER OF SECTION 21, TOWNSHIP 2 SOUTH, RANGE 28 EAST, W.M., MORROW COUNTY, OREGON.

PREVIOUS RENEWALS / SURVEYS, ETC.:

T2S R28E WAS ORIGINALLY SUBDIVIDED BY U.S. DEPUTY SURVEYORS GEORGE WILLIAMS AND GEORGE S. PERSHIN UNDER CONTRACT NO. 154 DATED JUNE 6, 1871. THE NOTES READ, "SET A STONE 16X10X4 ON W. HILLSIDE FOR 1/4 SEC. COR. OREGON STATE HIGHWAY DEPARTMENT (ODOT) MAP 1R-2-1123 DATED JANUARY, 1941 INDICATES STONE WAS FOUND. ODOT MAP 11B-5-8 DATED FEBRUARY 22, 2019 INDICATES THE STONE WAS FOUND IN 2009.

MONUMENT AND ACCESSORIES FOUND:

FOUND RECORD STONE PLAINLY MARKED 1/4 ON WEST FACE, PLANTED VERTICALLY WITH SCATTERED STONES AROUND. STONE IS LOCATED APPROXIMATELY 500 FEET SOUTHWEST OF, AND PERPENDICULAR TO, THE CENTERLINE OF HIGHWAY 74.

MONUMENT AND ACCESSORIES SET:

AT LOCATION OF FOUND STONE, SET 2-3/8" BRASS CAP ON 2-3/8" O.D. X 30" GALVANIZED IRON PIPE, WITH CAP ± 12" ABOVE GRADE, MARKED AS SHOWN IN DETAIL BELOW. ESTABLISHED 4 REFERENCE MONUMENTS AS FURTHER DESCRIBED AND DETAILED BELOW. REINFORCED EXPOSED PIPE WITH STONE AND EARTH TO CAP. SET STONE ALONGSIDE WEST SIDE OF BRASS CAP.

REFERENCES:

- (A) SET 5/8" X 30" STEEL REBAR WITH PINK PLASTIC CAP. CORNER BEARS S 42° W. 10.00'.
(B) SET 5/8" X 30" STEEL REBAR WITH PINK PLASTIC CAP. CORNER BEARS S 54° E. 10.00'.
(C) SET 5/8" X 30" STEEL REBAR WITH PINK PLASTIC CAP. CORNER BEARS N 44° E. 10.00'.
(D) SET 5/8" X 30" STEEL REBAR WITH PINK PLASTIC CAP. CORNER BEARS N 53° W. 10.00'.

DIAGRAM:

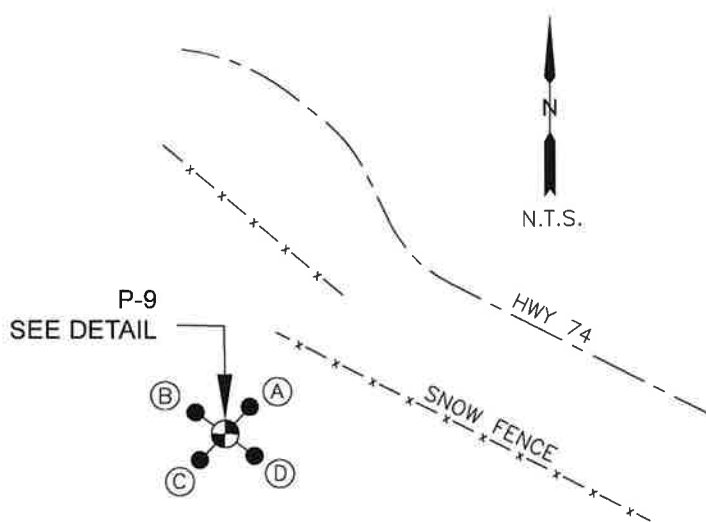

P-9 DETAIL:

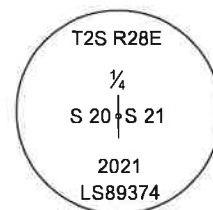

LOCATION AND COMMENTS:

CORNER IS APPROXIMATELY 500' SOUTHWESTERLY OF HIGHWAY 74 AND 200' SOUTHWESTERLY OF THE MOST SOUTHERLY SNOW FENCE ALONG HWY 74.

FIRM/AGENCY:

KENNY LAND SURVEYING
P.O. BOX 447 HEPPNER,
OR 97836
PARTY CHIEF: MATT KENNY

BEARING BASE:

REPORTED BEARINGS ARE
HAND HELD COMPASS BEARINGS
TAKEN TO THE NEAREST DEGREE
DECLINATION = 15° E

REGISTERED
PROFESSIONAL
LAND SURVEYOR

Handwritten signature of Matt Kenny

OREGON
JAN 12, 2016
MATTHEW PATRICK KENNY
89374PLS

RENEWS: 6-30-21

6-7-21

BY: MPK

NO: 2528 P9

SURVEY NO: 2021-1944C