

OREGON CORNER RESTORATION FORM

Section 4 Township 2S Range 27E
 County Morrow Date: September 20, 2018

Corner Designation: 2S27C9

Condition Report Only
 Not found
 Remonumented
 Unrecorded
 Surveyed in
 Referenced out

1/4 corner common to sections 4 and 5 T2S, R27E,
 W.M., Morrow County, Oregon.

Previous Renewals / Surveys, etc.

Corner was originally set by David P. Thompson under contract No. 122 Dated June 13, 1867. His record reads: Set a post as 1/4 Sec. Corner. In survey 1130A, County Surveyor Loy Turner reestablished the corner by single proportion. His record reads: Dug a hole 20 inches deep and poured in about 1/2 gallon of fine coal screenings. Set stone of triangular shape 26x14x5 with apex up marked 1/4 CS on east side. Drove two holes 2 inches square and 30 inches deep 10 links NE and SW and filled to top with fine coal screenings as witness corners.

Monument and Accessories found: (condition and source)

I found the stone set by Turner firmly set with the top projecting 4 inches above ground and plainly marked as described. The soil beneath the stone was discolored but not readily identifiable as coal. The point fell at the SW corner of a railroad tie fence corner post.

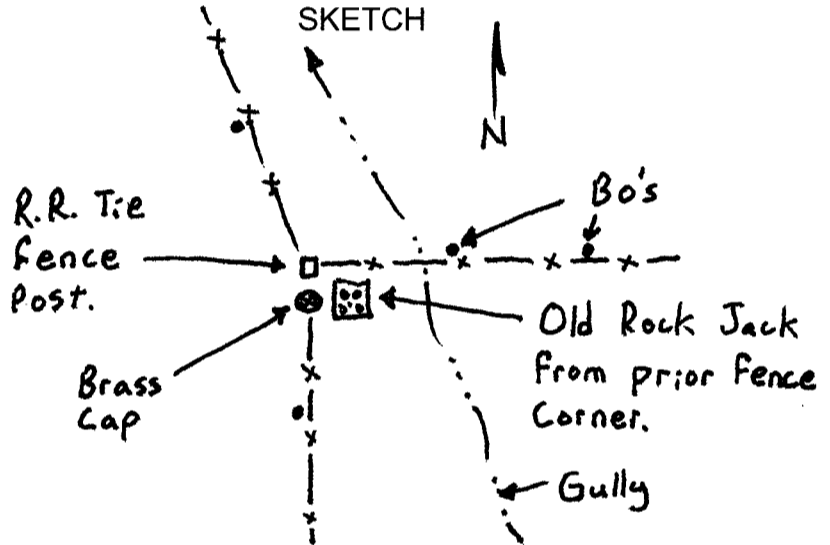
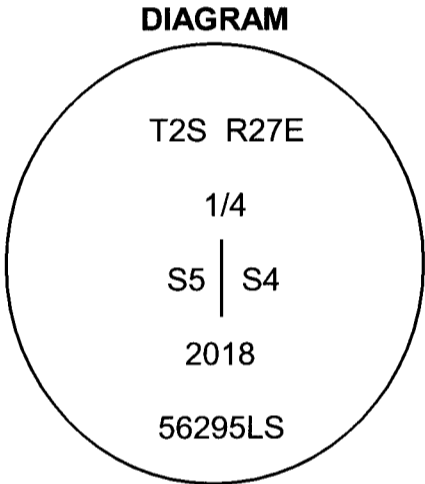

MONUMENT (S) AND ACCESSORIES SET (Procedures and Description)

At the position of the found stone I set a 2 1/2" brass cap on a 1 1/2" x 30" galvanized iron pipe 30 inches in the ground stamped as shown in the diagram above. I inverted the found stone and buried it along the south side of the brass cap.

For references, I set four 5/8" by 24" iron rebars with 1.25" orange plastic caps stamped WTS and 56295LS as described below:

- a rebar bears S02°04'01"E, 27.57 feet under the existing fence flush with the surface;
- a rebar bears N88°01'59"E, 26.91 feet under the existing fence flush with the surface;
- a rebar bears N89°44'14"E, 46.94 feet under the existing fence flush with the surface;
- a rebar bears N18°44'38"W, 28.56 feet under the existing fence flush with the surface;

Measurements to the cap and references were made with a Trimble RTK GPS system.

Location and comments
 Witnessed by:

Compass Declination

Surveyors Seal

RECEIVED BY:
Morrow County Surveyor
 Date: 9-30-2018
 Rec'd By: S.K.H.
 No. 2527C9
 Survey No. _____

Firm / Agency
Witness Tree Surveying
 Address
P.O. Box G
Pilot Rock, Or. 97868