

OREGON CORNER RESTORATION FORM

Section 36 Township 2S Range 26E
 County Morrow Date: September 7, 2017

Corner Designation: 2S26Z25

Condition Report Only
 Not found
 Remonumented
 Unrecorded
 Surveyed in
 Referenced out

Corner to section 31, T2S, R27E, section 36, T2S, R26E, section 1, T3S, R26E, and section 6, T3S, R27E, W.M., Morrow County, Oregon.

Previous Renewals / Surveys, etc.

Corner originally set by B.J. Pengra under contract No. 119 dated February 15, 1867. His record reads: Set a stone notched with six notches on each of four edges. In 1974 Wayne Harris found a stone marked "CR" in his survey for the Corps of Engineers Willow Creek Dam project. (See folder No. 1805.) In 1982 Gary Langlitz, on a survey for the USACE (see folder 794) provided coordinates for the corner point but did not identify the monument.

Monument and Accessories found: (condition and source)

At the corner point I found a small mound of stones built over the top of a basalt stone 12"x8"x3" set four inches in the ground and marked "CR" on the south face. This stone was set over the top of a bottle shaped stone 16"x6"x6" set vertically with an assortment of 22 nails and screws at the base of the stone approximately 20 inches below the surface of the ground.

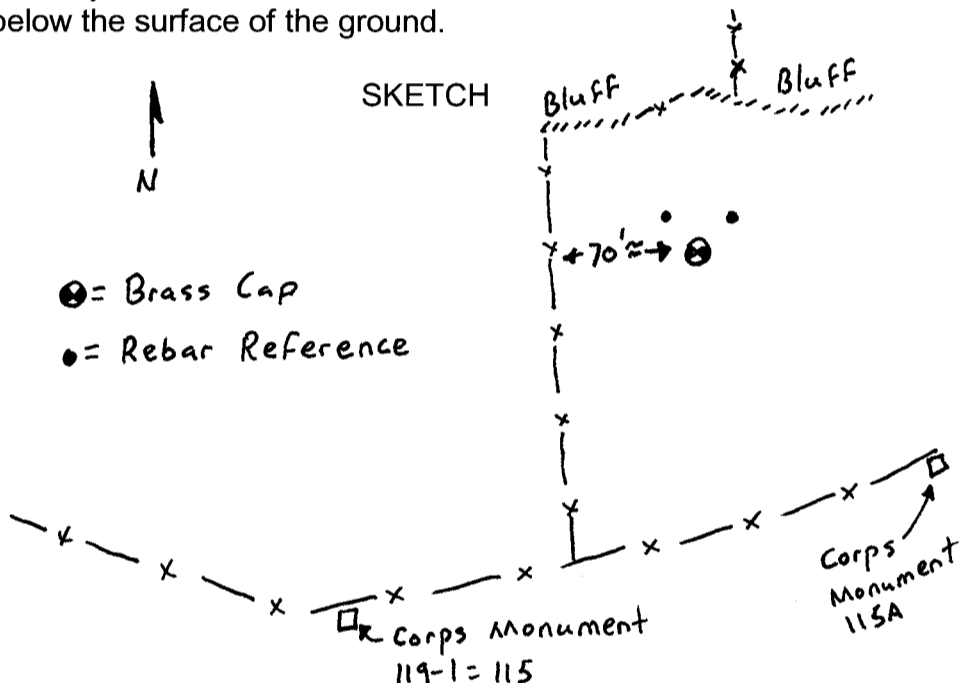
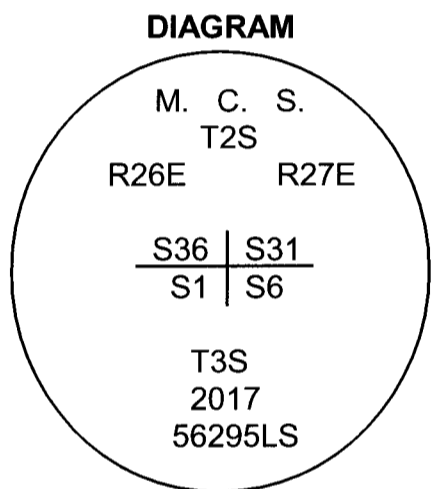

Monument and Accessories set:

At the position of the original stone I set a 1 1/2"x30" galvanized iron pipe with a 2 3/8" brass cap marked as shown in the diagram above flush with the surface of the ground. The original stone, nails and the stone marked "CR" were buried along side the pipe.

For references I set two 5/8"x24" iron rebars with orange plastic caps stamped WTS and 56295LS as follows:

A rebar bears N51°34'25"W a distance of 19.02 feet;

A rebar bears N46°20'41"E a distance of 23.04 feet;

Also two aluminum monuments from the Corps of Engineers survey (folder 794) are as follows:

Corps monument 119-1 = 115 bears S38°27'18"W a distance of 345.31 feet;

Corps monument 115A bears S43°55'42"E a distance of 274.62 feet.

The monument and references were tied using a Trimble R7/R8 RTK GPS SYSTEM.

Location and comments

Compass Declination

Surveyor's Seal

RECEIVED BY:
Morrow County Surveyor
 Date: 9-21-2017
 Rec'd By: S.K.H.
 No. 2526225
 Survey No. 2017-1806D

Firm / Agency
Witness Tree Surveying
 Address
P.O. Box G
Pilot Rock, Or. 97868

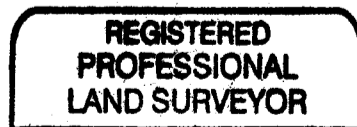

Stephen K. Haddock

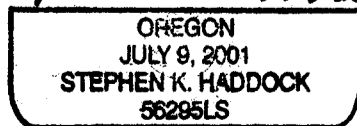

RENEWS: 6-30-19