

OREGON CORNER RESTORATION FORM

Section 34 Township 2S Range 26E
 County Morrow Date: August 3, 2017

Corner Designation: 2S26Z17

Corner common to sections 34 and 35, T2S, and sections 2 and 3, T3S, R26E, W.M., Morrow County, Oregon.

Condition Report Only
 Not found
 Remonumented
 Unrecorded
 Surveyed in
 Referenced out

Previous Renewals / Surveys, etc.

The corner was originally set by B.J. Pengra under contract 119 dated February 15, 1867. His record reads: Set corner to sections 2, 3, 34, and 35. Drove charred stake and raised mound. In 1912, D.V.S. Reid (see folder 1124) found the government stake and drove a 5/16"x12" iron rod in it. Against the south side of the iron rod Reid set several pieces of cast iron stove grate and a stone 14x8x7 inches. He made four references as follows: NE 5 links deposit of broken blue and brown glass; NW 5 links deposit of broken earthenware; SW 21 links several pieces of iron and a cast iron stove grate. SE 8 links deposit of fine stone coal. In 1984 Gary Langlitz (see folder 794) provided coordinates but did not identify the corner monument. In 1994 Denny Edwards (see folder 787) said "set nail at fence corner". In 1997 (see folder 924) Ron McKinnis calculated a point using the USACE coordinates. In 2007 Judson Coppock (see folder 1510) said "set 2 3/8" brass cap on 2" galvanized pipe at USACE coordinates.

Monument and Accessories found: (condition and source) There was no monument at the USACE (Langlitz) position. I found a nail at the Coppock position. He did not set a brass cap. I found another nail at the position by Edwards. I found the 5/16th iron Rod in the decayed original post, the marked stone 14"x9"x7" with broken cast iron pieces, and the cast iron stove grate reference to the SW, all by D.V.S. Reid.

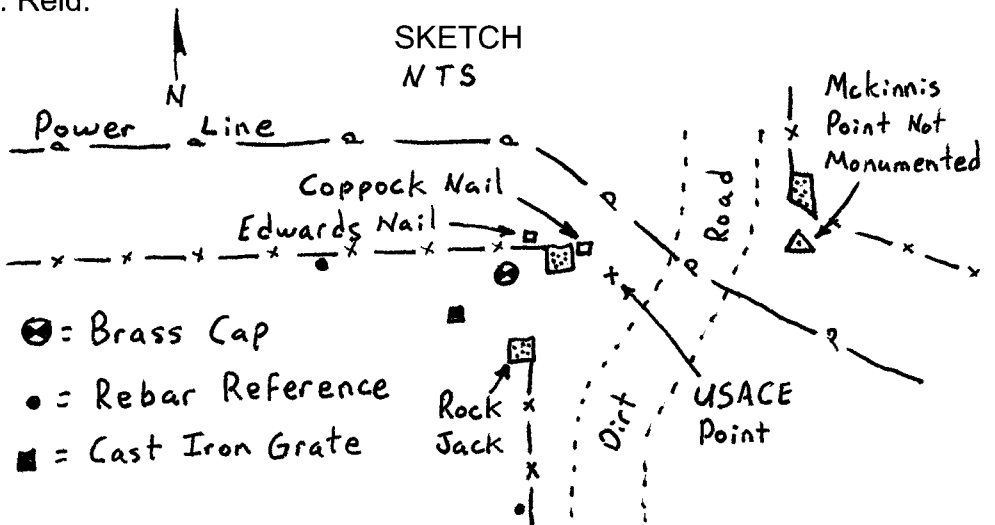
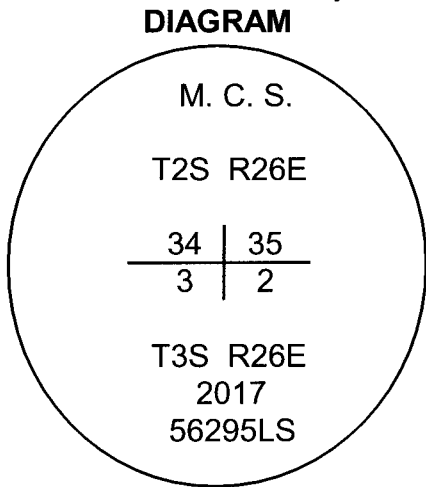

MONUMENT (S) AND ACCESSORIES SET (Procedures and Description)

I set a 2 3/8" brass cap on a 1 1/2" galvanized iron pipe over the top of the 5/16th iron rod by Reid flush with the ground and I buried the cast iron pieces and the stone along side.

For references, I set two 5/8" by 24" rebars with 1.25" orange plastic caps stamped WTS and 56295LS as described below:

- an iron rebar bears N88°48'28"W, 44.51 feet in the remains of an east - west fence;
- an iron rebar bears S02°09'20"W, 45.42 feet under the existing fence running south;
- the cast iron stove grate by Reid bears S42°46'01"W, 13.95';
- the nail by Edwards bears N36°22'12"E, 2.20 feet at the projected intersection of fences W. & S.;
- the nail by Coppock bears N87°33'13"E, 8.34 feet at the NE corner of a rock crib;

Measurements were made with a Trimble RTK GPS.

Location and comments

Compass Declination

Surveyor's Seal

RECEIVED BY:
 Morrow County Surveyor
 Date: 9-21-2017
 Rec'd By: S.K.H.
 No. 2526717
 Survey No. 2017-1806D

Firm / Agency
 Morrow County Surveyor
 Address
 P.O. Box G
 Pilot Rock, Or. 97868
 Party Chief

**REGISTERED
 PROFESSIONAL
 LAND SURVEYOR**

Stephen K. Haddock

OREGON
 JULY 9, 2001
 STEPHEN K. HADDOCK
 56295LS

RENEWS: 6-30-19