

**OREGON CORNER RESTORATION FORM**

Section 26 Township 2S Range 26E  
 County Morrow Date: August 11, 2017

Corner Designation: 2S26V19

Condition Report Only  
 Not found  
 Remonumented  
 Unrecorded  
 Surveyed in  
     x      Referenced out

Quarter corner common to sections 26 and 35, T2S, R26E,  
 W.M., Morrow County, Oregon.

Previous Renewals / Surveys, etc.

Corner originally set by B.J. Pengra under contract No. 119 dated February 15, 1867. His record reads: Set charred stake in raised mound as 1/4 section corner. In the plat of Barratt Park Addition J.C. Payne called for a 2 inch galvanized pipe.

Monument and Accessories found: ( condition and source )

I found the 2" iron pipe called for by J.C. Payne and all subsequent surveys.

**DIAGRAM**

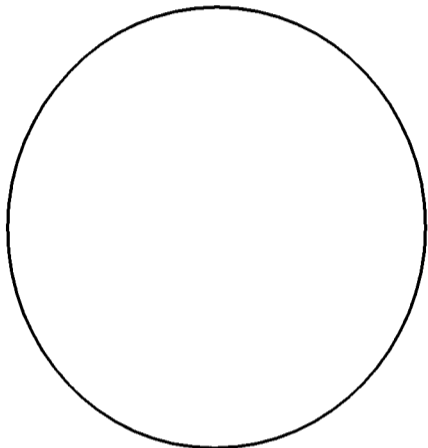

⊙ = 2" Iron pipe  
 • = Rebar Reference

**SKETCH**

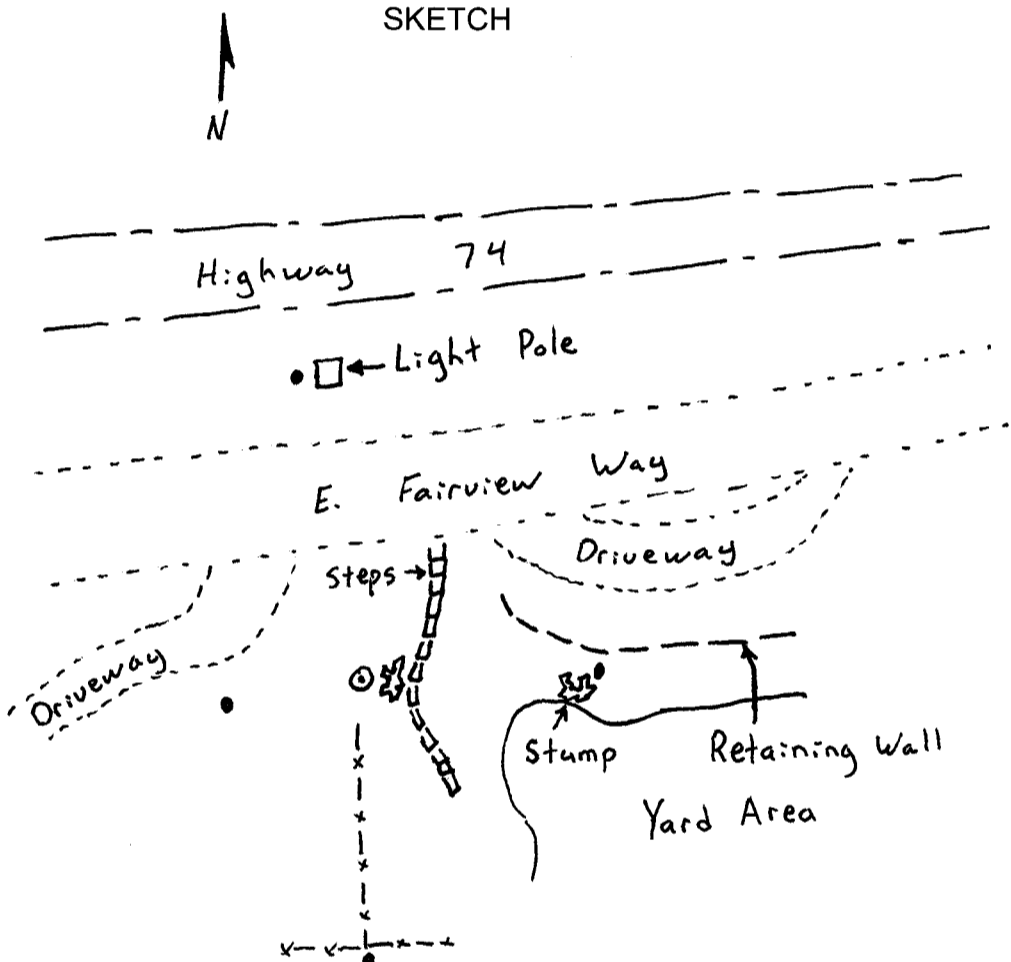

**MONUMENT (S) AND ACCESSORIES SET (Procedures and Description)**

I held the 2" galvanized iron pipe as monumenting the true corner point and left it in place.

For references, I set three 5/8" by 24" rebars with 1.25" orange plastic caps stamped WTS and 56295LS as described below:

- an iron rebar bears N13°06'30"W, 34.86 feet on the west side of a street light pole;
- an iron rebar bears S78°51'52"W, 12.84 feet;
- an iron rebar bears S87°12'53"E, 11.28 feet;
- an iron rebar (the initial point of Partition Plat 2017-1) bears S00°30'03"E, 110.34 feet;

The monument and references were tied using a Trimble R7/R8 RTK GPS.

Location and comments

Compass Declination

Surveyor's Seal

RECEIVED BY:  
Morrow County Surveyor  
 Date: 9-21-2017  
 Rec'd By: S.K.H.  
 No. 2S26V19  
 Survey No. 2017-1806D

Firm / Agency  
Witness Tree Surveying  
 Address  
P.O. Box G  
Pilot Rock, Or. 97868

**REGISTERED  
 PROFESSIONAL  
 LAND SURVEYOR**

*Stephen K. Haddock*

OREGON  
 JULY 9, 2001  
**STEPHEN K. HADDOCK**  
 56295LS

RENEWS: 6-30-19