

**OREGON CORNER RESTORATION FORM**

Section 26 Township 2S Range 26E  
 County Morrow Date: August 7, 2017

Corner Designation: 2S26V17

Corner to sections 26, 27, 34, and 35, T2S, R26E,  
 W.M., Morrow County, Oregon.

Condition Report Only  
 Not found  
 Remonumented  
 Unrecorded  
 Surveyed in  
     x      Referenced out

Previous Renewals / Surveys, etc.

Corner originally set by B.J. Pengra under contract No. 119 dated February 15, 1867. His record reads: Drove charred stake in raised mound for section corner to 26, 27, 34 & 35. In 1972 Donald Staebler reported finding a wagon axle. (See folder 285.) In 1980 Dave Krumbein set witness brass caps to the north and east. (See folder 429.) Various surveys "post 1972" called for a "found I.P."

Monument and Accessories found: ( condition and source )

Found the wagon axle firmly set with the top 4 inches below the surface on the east side of the fence in the back yard of Lot 2, Block 13, Stansbury's Addition to Heppner. I found a 2" iron pipe (brass cap was missing) 6 inches below the surface of Church Street to the north. The brass capped witness monument to the east in Gale Street had been paved over. The metal detector indicates that the Gale St. witness monument is still in place but I did not dig it out.

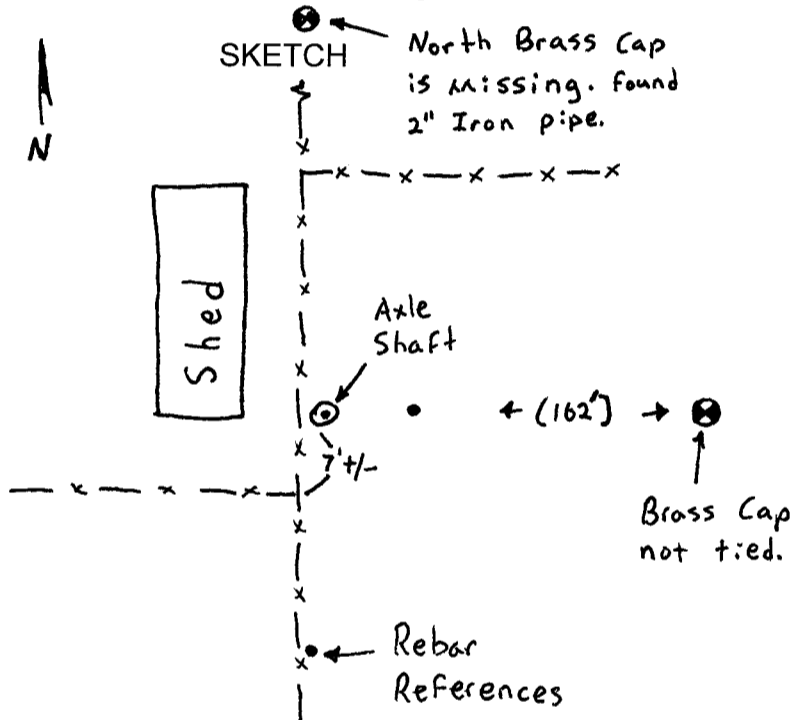
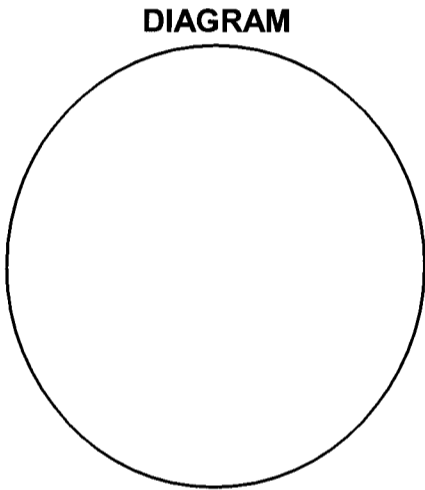

**MONUMENT (S) AND ACCESSORIES SET (Procedures and Description)**

I confirmed the location of the wagon axle by survey ties to various monuments and held its position as the true corner point.

For references, I set two 5/8" by 24" rebars with 1 1/8" orange plastic caps attached, stamped WTS and 56295LS as described below:

- an iron rebar bears N86°34'21"E, 10.51feet;
- an iron rebar bears S03°21'43"W, 12.79 feet;
- the 2" iron pipe in Church Street bears N00°01'37"E, 114.95 feet. (Record is 115.00');

The monument and references were tied using a Trimble R7/R8 RTK GPS.

Location and comments

Compass Declination

RECEIVED BY:  
Morrow County Surveyor  
 Date: 9-21-2017  
 Rec'd By: S.K.H.  
 No. 2S26V17  
 Survey No. 2017-1806D

Firm / Agency  
Witness Tree Surveying  
 Address  
P.O. Box G  
Pilot Rock, Or. 97868

Surveyor's Seal

**REGISTERED  
 PROFESSIONAL  
 LAND SURVEYOR**

*Stephen K. Haddock*

OREGON  
 JULY 9, 2001  
**STEPHEN K. HADDOCK**  
 56295LS

RENEWS: 6-30-19