

T-21

OREGON CORNER RESTORATION FORM

Section 26 Township 2S Range 26E
County Morrow Date: April 25, 2008

Corner Designation: 2S26T21

Common quarter corner to sections 25 and 26, T2S, R26E,
W.M., Morrow County, Oregon.

Previous Renewals / Surveys, etc.

Corner originally set by David P. Thompson under contract No. 119 dated February 15, 1867.
His record reads: Set stone, 14 x 10 x 8 as 1/4 section corner.

Monument and Accessories found: (condition and source)

A basalt stone that I believe to be the original, of record dimensions, lying loose on the ground about 3 feet from the proportioned point. There is little other stone of any size nearby and this stone has the same type of thin crumbly surface as the stone at the E. 1/4 of section 23.

DIAGRAM

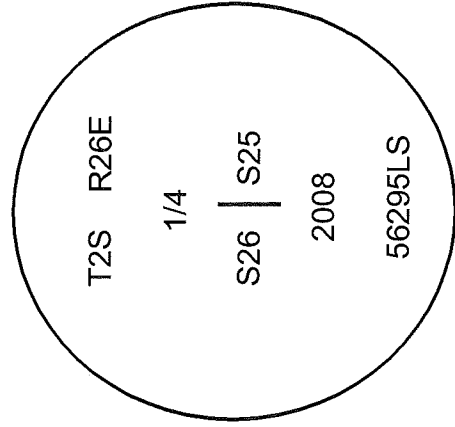

- = Brass Cap
- = Rebar Reference

SKETCH

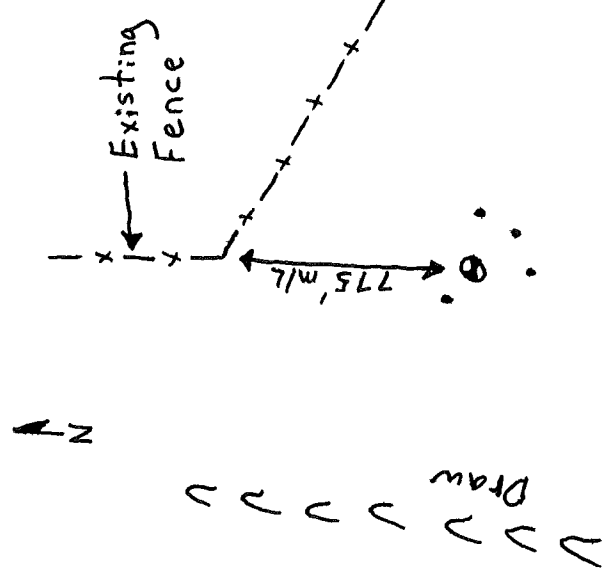

MONUMENT (S) AND ACCESSORIES SET (Procedures and Description)

I set a 1 1/2" x 30" galvanized iron pipe with a 2 1/4" brass cap stamped as shown in the diagram above at the proportioned point, 20" in the ground to bedrock. I built a mound of stone around the monument placing the original stone in the mound.

For references, I set four 5/8" by 24" rebars with 1.25" orange plastic caps stamped WTS and 56295LS as described below:

- an iron rebar bears N27°50'10"W, 34.56 feet;
- an iron rebar bears S02°35'23"W, 86.19 feet;
- an iron rebar bears S34°35'48"E, 84.73 feet;
- an iron rebar bears S81°44'23"E, 86.95 feet;

The monument and references were tied using a Trimble R7/R8 RTK GPS system.

Location and comments

Compass Declination

Surveyors Seal

RECEIVED BY:

Morrow County Surveyor

Date: MAY 28 2008

Rec'd By: SRB

No. T-21

Firm / Agency
 Witness Tree Surveying
 Address
 P.O. Box G
 Pilot Rock, OR 97868
 Party Chief
 Stephen K, Haddock

REGISTERED
 PROFESSIONAL
 LAND SURVEYOR

Stephen K. Haddock

OREGON
 JULY 9, 2001
 STEPHEN K. HADDOCK
 56295LS

RENEWAL DATE 6-30-09

OREGON CORNER RESTORATION FORM

T-19

Section 26 Township 2S Range 26E
County Morrow Date: May 24, 2008

Corner Designation: 2S26T19

Center 1/4 corner to Section 26, T2S, R26E W.M.
Morrow County, Oregon.

Condition Report Only
Not found
Remonumented
Unrecorded
Surveyed in
Referenced out

Previous Renewals / Surveys, etc.

I found no record of any previous establishment of a monument at this corner point.

Monument and Accessories found: (condition and source)
None.

DIAGRAM

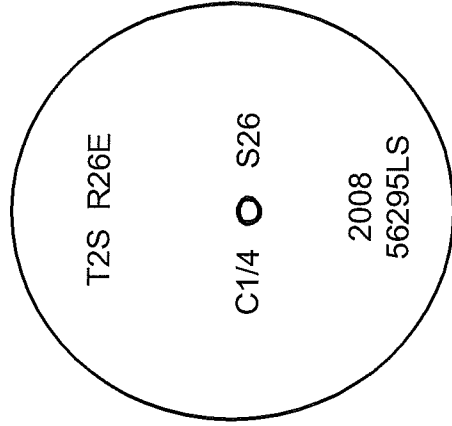

SKETCH

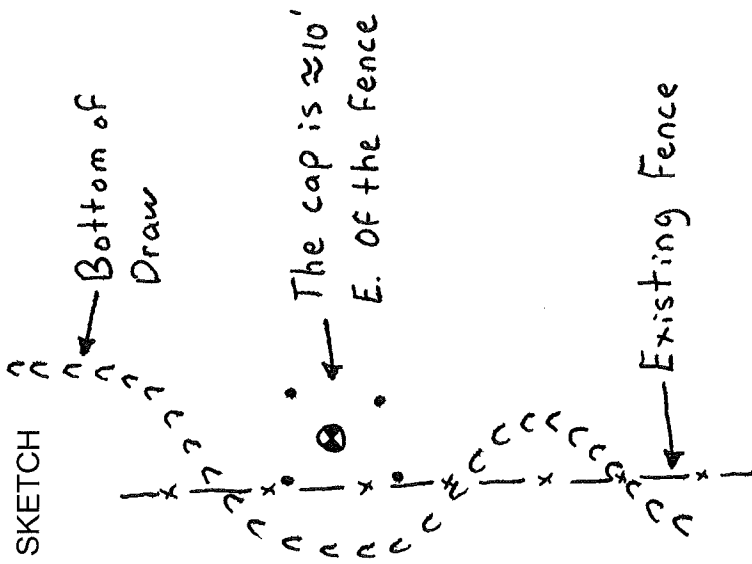

⊙ = Al. Cap

• = Rebar Reference

MONUMENT (S) AND ACCESSORIES SET (Procedures and Description)

I set a 1" x 24" iron rebar with a 2" aluminum Cap stamped as shown above flush with the surface of the ground at the calculated center 1/4 location.

For references, I set four 5/8" by 24" iron rebars with 1 1/8" orange plastic caps stamped WTS and 56295LS as described below:
a rebar bears N59°08'03"E, 35.11 feet;
a rebar bears N18°19'47"W, 36.43 feet under the existing fence;
a rebar bears S14°51'19"W, 40.37 feet under the existing fence;
a rebar bears S34°31'10"E, 37.59 feet;

The monument was set and references tied using a Trimble R7/R8 RTK GPS.

Location and comments

Compass Declination

Surveyors Seal

RECEIVED BY:

Morrow County Surveyor
Date: MAY 28 2008
Rec'd By: SKB
No. T-19

Firm / Agency
Witness Tree Surveying
Address
P.O. Box G
Pilot Rock, Or. 97868
Party Chief
Stephen K, Haddock

**REGISTERED
PROFESSIONAL
LAND SURVEYOR**

Stephen K. Haddock

OREGON
JULY 9, 2001
STEPHEN K. HADDOCK
56295LS

RENEWAL DATE 6-30-09

R-21

OREGON CORNER RESTORATION FORM

Section 26 Township 2S Range 26E
County Morrow Date: April 25, 2008

Corner Designation: 2S26R21

Corner to sections 23, 24, 25, and 26, T2S, R26E,
W.M., Morrow County, Oregon.

Previous Renewals / Surveys, etc.

Corner originally set by David P. Thompson under contract No. 119 dated February 15, 1867. His record reads: Set charred stake in raised mound as corner to sections 23, 24, 25 & 26. Morrow County Partition Plat 2005-6 calls for "computed location only".

Monument and Accessories found: (condition and source)
A long standing north-south fence line running along the section line.

DIAGRAM

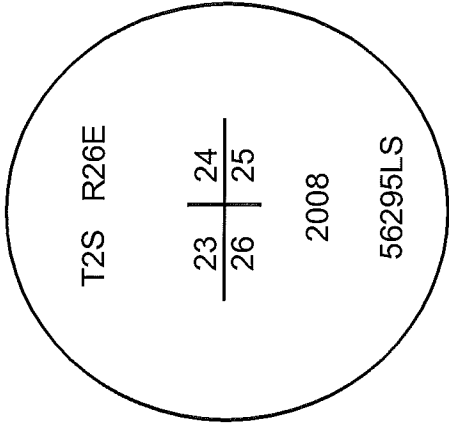

SKETCH

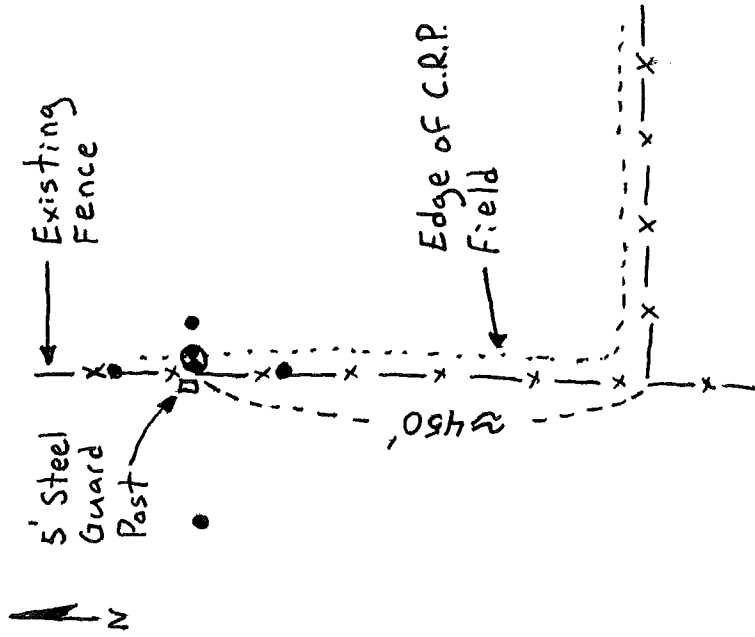

⊗ = Brass Cap

● = Rebar Reference

MONUMENT (S) AND ACCESSORIES SET (Procedures and Description)
I proportioned the latitude and held the long standing fence for the departure. At the corner point I set a 1 1/2" x 30" galvanized iron pipe with a 2 1/4" brass cap stamped as shown in the diagram above.

For references, I set four, 5/8" by 24" rebars with 1 1/8" orange plastic caps attached, stamped WTS and 56295LS approximately 6" below the surface as described below:
an iron rebar bears N00°26'12"E, 34.77 feet under the existing fence;
an iron rebar bears S01°35'30"W, 31.09 feet under the existing fence;
an iron rebar bears S88°02'11"E, 8.62 feet 2, feet below the surface;
an iron rebar bears S87°04'36"W, 45.21 feet;

The monument was set and the references were tied using a Trimble R7/R8 RTK GPS.

Location and comments

Compass Declination

Surveyors Seal

RECEIVED BY:

Morrow County Surveyor

Date: MAY 28 2008

Rec'd By: S KB

No. R-21

Firm / Agency
Witness Tree Surveying
Address

P.O. Box G
Pilot Rock, Or. 97868
Party Chief
Stephen K, Haddock

REGISTERED
PROFESSIONAL
LAND SURVEYOR

Stephen K. Haddock

OREGON
JULY 9, 2001
STEPHEN K. HADDOCK
56295LS

RENEWAL DATE 6-30-09

R-19

OREGON CORNER RESTORATION FORM

Section 26 Township 2S Range 26E
County Morrow Date: April 25, 2008

Corner Designation: 2S26R19

Quarter corner common to sections 23 and 26, T2S, R26E,
W.M., Morrow County, Oregon.

Previous Renewals / Surveys, etc.

Corner originally set by David P. Thompson under contract No. 119 dated February 15, 1867. His record reads: Set charred stake in raised mound as 1/4 section corner.

Monument and Accessories found: (condition and source)

A long term fence line running north-south through the center of sections 23 and 26. A corner of this same fence was held as the north 1/4 of Section 23 under Morrow County Survey C-97-K.

DIAGRAM

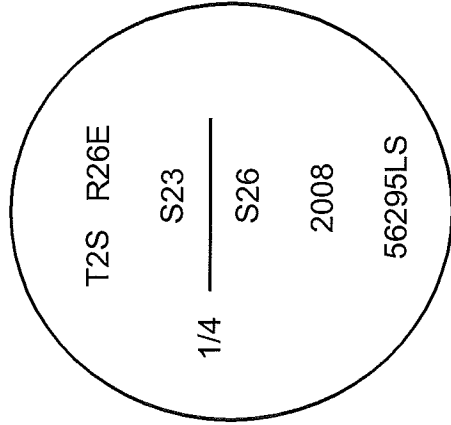

SKETCH

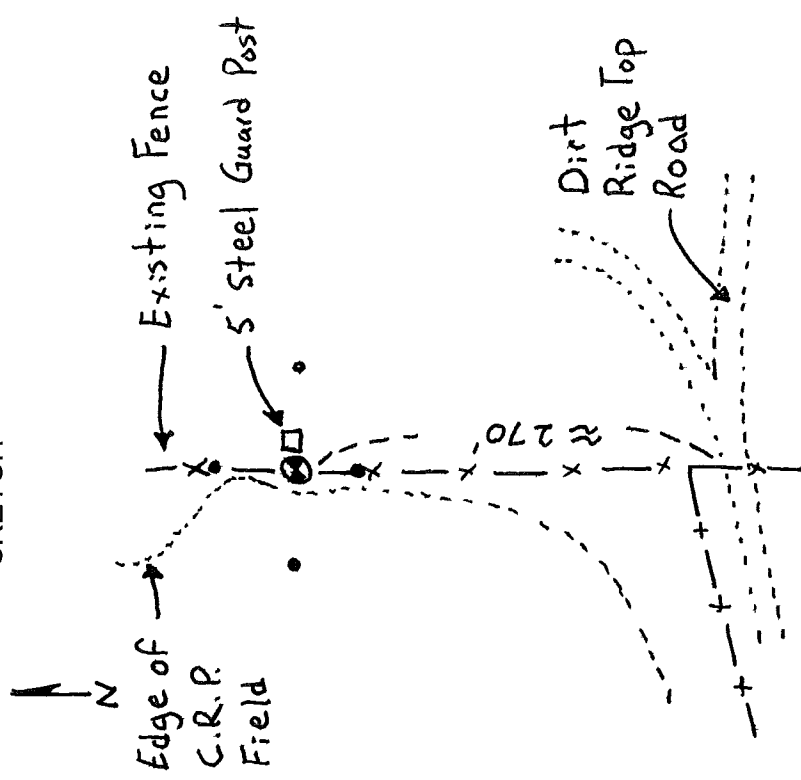

● = Brass Cap

● = Rebar Reference

MONUMENT (S) AND ACCESSORIES SET (Procedures and Description)

I proportioned the latitude and held the fence for departure and at the corner point I set a 1 1/2" x 30" galvanized iron pipe with a 2 1/4" brass cap attached stamped as shown in the diagram above.

For references, I set four 5/8" by 24" rebars with 1.25" orange plastic caps stamped WTS and 56295LS as described below:

an iron rebar bears N00°06'26"W, 24.36 feet under the existing fence;

an iron rebar bears S00°33'20"E, 21.34 feet under the existing fence;

an iron rebar bears S84°55'42"W, 30.77 feet, 2 feet below the surface;

an iron rebar bears S83°42'17"E, 26.19 feet;

The monument was set and the references were tied using a Trimble R7/R8 RTK GPS.

Location and comments

Compass Declination

Surveyors Seal

RECEIVED BY:

Morrow County Surveyor

Date: MAY 28 2008

Rec'd By: SKB

No. R-19

Firm / Agency

Witness Tree Surveying

Address

P.O. Box G

Pilot Rock, Or. 97868

Party Chief

Stephen K, Haddock

REGISTERED
PROFESSIONAL
LAND SURVEYOR

Stephen K. Haddock

OREGON
JULY 9, 2001
STEPHEN K. HADDOCK
56295LS

RENEWAL DATE 6-30-09

R-17

OREGON CORNER RESTORATION FORM

Section 26 Township 2S Range 26E
County Morrow Date: May 24, 2008

Corner Designation: 2S26R17

Corner to sections 22, 23, 26, and 27, T2S, R26E,
W.M., Morrow County, Oregon.

Previous Renewals / Surveys, etc.

Corner originally set by David P. Thompson under contract No. 119 dated February 15, 1867. His record reads: Set stone 14x12x6 as corner to sections 22, 23, 26 & 27. Dave Krumbein, in survey C-97-K established a position for this corner by proportion but set no monument. His position has subsequently been used in surveys C-146-K, C-221-K, the Plat of Ployhar Estates and Partition Plat 2005-06.

Monument and Accessories found: (condition and source)
None.

DIAGRAM

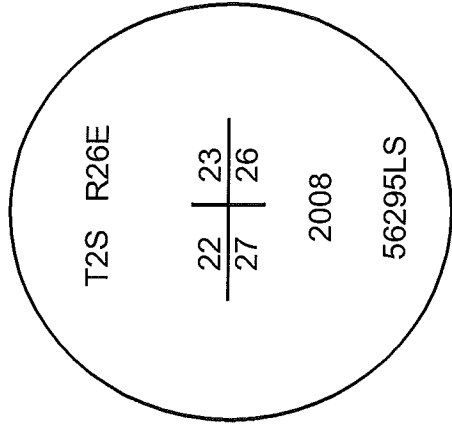

SKETCH

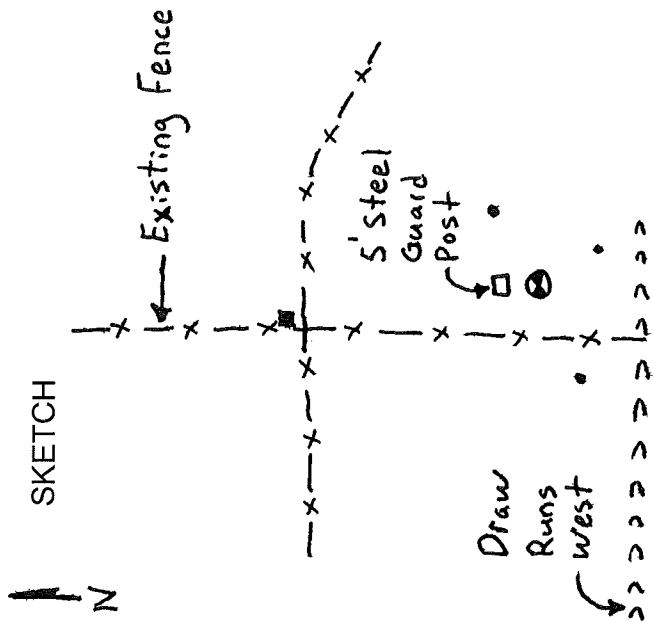

MONUMENT (S) AND ACCESSORIES SET (Procedures and Description)

I computed the corner location from ties to the monuments set under the surveys described above and at the corner point I set a 5/8"x24" iron rebar 24" in the ground. Over this I set a 1 1/2" by 30" galvanized iron pipe with a 2 1/4" brass cap stamped as shown in the diagram above flush with the surface of the ground and made a small collar of stone around the cap. I set a 5' steel guard post with a Morrow County monument sign approximately 1 foot north of the cap.

For references, I set three, 5/8" by 24" rebars with 1 1/8" orange plastic caps attached, stamped WTS and 56295LS as described below:

- an iron rebar bears N41°30'19"E, 41.64 feet;
- an iron rebar bears S48°29'56"E, 31.49 feet;
- an iron rebar bears S44°34'19"W, 47.91 feet;
- a 5/8" iron rebar of unknown origin bears N02°45'30"W 213.96 feet on the north side of a four way; fence intersection.

The monument was set and the references were tied using a Trimble R7/R8 RTK GPS.

Location and comments

Compass Declination

Surveyors Seal

RECEIVED BY:

Morrow County Surveyor
Date: MAY 28 2008
Rec'd By: SKB
No. R-17

Firm / Agency
Witness Tree Surveying
Address
P.O. Box G
Pilot Rock, Or. 97868
Party Chief
Stephen K, Haddock

REGISTERED
PROFESSIONAL
LAND SURVEYOR

Stephen K. Haddock

OREGON
JULY 9, 2001
STEPHEN K. HADDOCK
56295LS

RENEWAL DATE 6-30-09

P. 21

OREGON CORNER RESTORATION FORM

Section 23 Township 2S Range 26E
County Morrow Date: April 25, 2008

Corner Designation: 2S26P21

Condition Report Only
Not found _____
Remonumented x
Unrecorded _____
Surveyed in _____
Referenced out x

Common quarter corner to sections 23 and 24, T2S, R26E, W.M., Morrow County, Oregon.

Previous Renewals / Surveys, etc.

Corner originally set by David P. Thompson under contract No. 119 dated February 15, 1867. His record reads: Set stone, 14 x 12 x 8 as 1/4 section corner. Morrow County Partition Plat 2005-6 shows "computed location only"

Monument and Accessories found: (condition and source)

The original stone, in place but tipped to one side, appears to have a part of the "4" on the side and an "x" on top. This stone is 9 feet from the "computed location" shown on the partition plat. The surface (about 1/16th" thick) of the basalt stone is fairly crumbly and scrubbed off when cleaned with the wire brush.

DIAGRAM

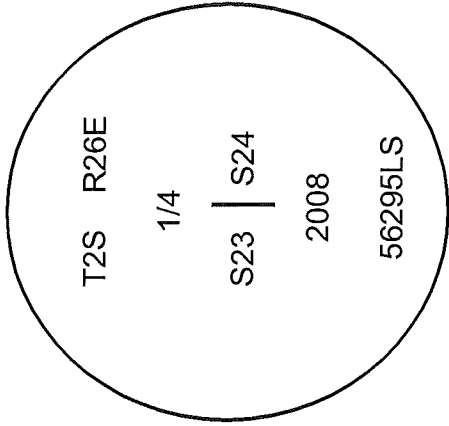

SKETCH

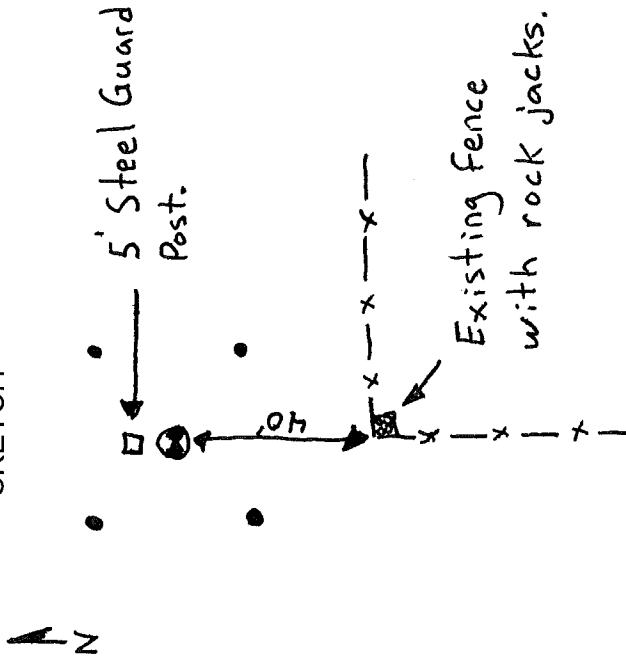

- ⊗ = Brass Cap
- = Rebar Reference

MONUMENT (S) AND ACCESSORIES SET (Procedures and Description)

I set a 1 1/2" x 30" galvanized iron pipe with a 2 1/4" brass cap stamped as shown in the diagram above at the position of the original stone. I buried the stone along side NE from the pipe.

For references, I set four 5/8" by 24" rebars with 1.25" orange plastic caps stamped WTS and 56295LS as described below:

- an iron rebar bears N47°58'45"E, 31.24 feet;
- an iron rebar bears N38°29'48"W, 25.93 feet;
- an iron rebar bears S49°19'41"W, 28.72 feet;
- an iron rebar bears S51°00'06"E, 29.16 feet;

The monument and references were tied using a Trimble R7/R8 RTK GPS system.

Location and comments

Compass Declination

Surveyors Seal

RECEIVED BY:

Morrow County Surveyor
Date: May 28 2008
Rec'd By: SKB
No. P-21

Firm / Agency
Witness Tree Surveying
Address
P.O. Box G
Pilot Rock, OR 97868
Party Chief
Stephen K, Haddock

REGISTERED
PROFESSIONAL
LAND SURVEYOR

Stephen K. Haddock

OREGON
JULY 9, 2001
STEPHEN K. HADDOCK
56295LS

RENEWAL DATE 6-30-09

P.9

OREGON CORNER RESTORATION FORM

Section 21 Township 2S Range 24E
County Morrow Date: October 25, 2010

Corner Designation: 2S24N9

Condition Report Only
Not found _____
Remonumented x _____
Unrecorded _____
Surveyed in _____
Referenced out x _____

Corner to sections 16, 17, 20, and 21, T2S, R24E, W.M., Morrow County, Oregon.

Previous Renewals / Surveys, etc.

Corner originally set by David P. Thompson under contract #119 dated February 15, 1867. His record reads: Set post for corner to secs. 16, 17, 20 & 21, in mound of earth with charred stake, pits, &c. as per instructions. The road survey associated with Morrow County Road petition No. 94 says, to the corner.

Monument and Accessories found: (condition and source)

None. The position falls at the intersection of roads to the west and south and is on line with possessory lines to the north.

DIAGRAM

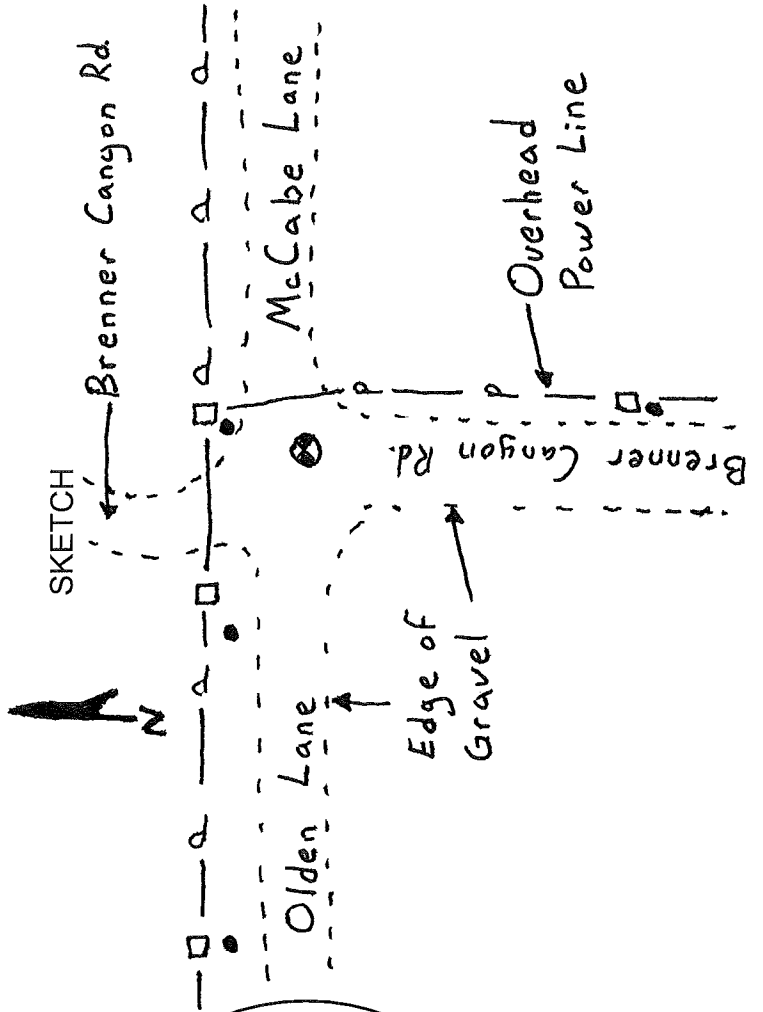
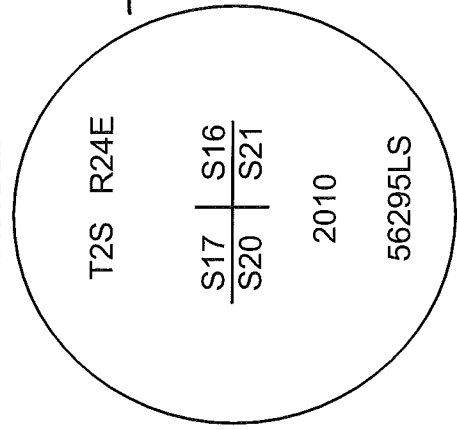

- = Brass Cap
- = Iron Rebar Reference
- = Power Pole

MONUMENT (S) AND ACCESSORIES SET (Procedures and Description)

At the intersection of road centerlines and the possessory line as described above, I set a 1 1/2" x 30" galvanized iron pipe with a 2 1/4" brass cap stamped as shown in the diagram above. The cap is 6" below the surface of a gravel road.

For references, I set four, 5/8" by 24" iron rebars with 1.25" orange plastic caps stamped WTS and 56295LS as described below:
an iron rebar bears N85°24'25"W, 279.21 feet on the south side of a power pole;
an iron rebar bears N49°50'33"W, 41.67 feet;
an iron rebar bears N25°27'44"E, 28.53 feet on the south side of a power pole;
an iron rebar bears S04°10'31"E, 208.75 feet on the south side of a power pole;

The monument and references were tied using a Trimble R7/R8 RTK GPS.

Location and comments

Compass Declination

Surveyors Seal

RECEIVED BY:

Morrow County Surveyor

Date: _____

Rec'd By: _____

No. _____

Firm / Agency
Witness Tree Surveying
Address

P.O. Box G
Pilot Rock, OR 97868
Party Chief
Stephen K, Haddock

REGISTERED
PROFESSIONAL
LAND SURVEYOR

Stephen K. Haddock

OREGON
JULY 9, 2001
STEPHEN K. HADDOCK
56295LS

RENEWAL DATE 6-30-11

2-14-10