

R-19

**OREGON CORNER RESTORATION FORM**

Section 26 Township 2S Range 26E  
County Morrow Date: April 25, 2008

Corner Designation: 2S26R19

Condition Report Only  
Not found  
Remonumented  
Unrecorded  
Surveyed in    x     
Referenced out    x   

Quarter corner common to sections 23 and 26, T2S, R26E,  
W.M., Morrow County, Oregon.

Previous Renewals / Surveys, etc.

Corner originally set by David P. Thompson under contract No. 119 dated February 15, 1867. His record reads: Set charred stake in raised mound as 1/4 section corner.

Monument and Accessories found: ( condition and source )

A long term fence line running north-south through the center of sections 23 and 26. A corner of this same fence was held as the north 1/4 of Section 23 under Morrow County Survey C-97-K.

**DIAGRAM**

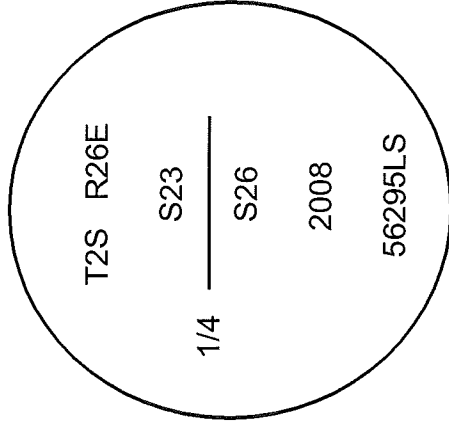

**SKETCH**

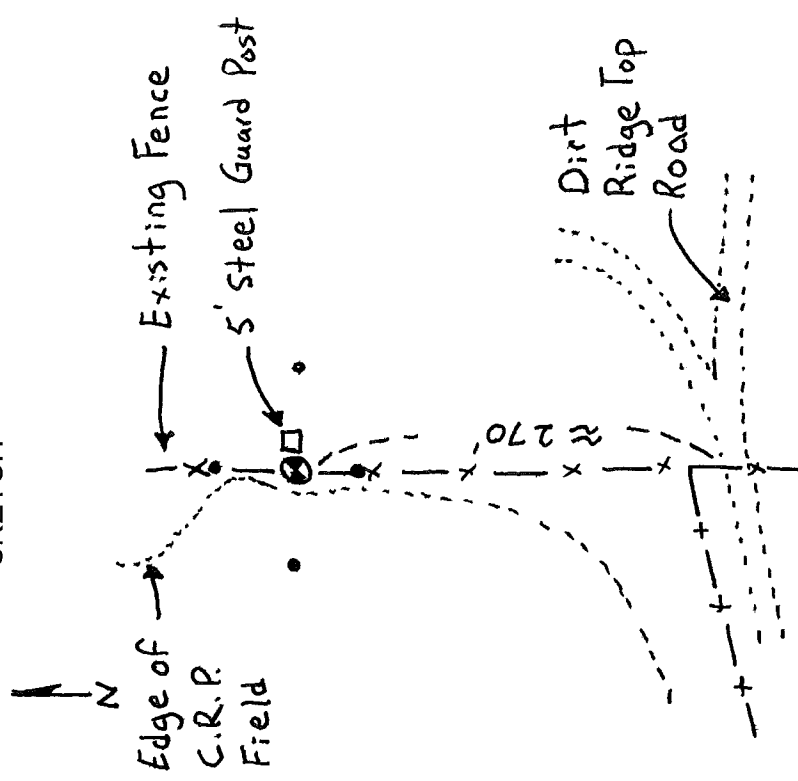

- = Brass Cap
- = Rebar Reference

**MONUMENT (S) AND ACCESSORIES SET (Procedures and Description)**

I proportioned the latitude and held the fence for departure and at the corner point I set a 1 1/2" x 30" galvanized iron pipe with a 2 1/4" brass cap attached stamped as shown in the diagram above.

For references, I set four 5/8" by 24" rebars with 1.25" orange plastic caps stamped WTS and 56295LS as described below:

- an iron rebar bears N00°06'26"W, 24.36 feet under the existing fence;
- an iron rebar bears S00°33'20"E, 21.34 feet under the existing fence;
- an iron rebar bears S84°55'42"W, 30.77 feet, 2 feet below the surface;
- an iron rebar bears S83°42'17"E, 26.19 feet;

The monument was set and the references were tied using a Trimble R7/R8 RTK GPS.

Location and comments

Compass Declination

Surveyors Seal

RECEIVED BY:  
Morrow County Surveyor  
Date: MAY 28 2008  
Rec'd By: SKB  
No. R-19

Firm / Agency  
Witness Tree Surveying  
Address  
P.O. Box G  
Pilot Rock, Or. 97868  
Party Chief  
Stephen K, Haddock

REGISTERED  
PROFESSIONAL  
LAND SURVEYOR

*Stephen K. Haddock*

OREGON  
JULY 9, 2001  
STEPHEN K. HADDOCK  
56295LS

RENEWAL DATE 6-30-09