

**OREGON CORNER RESTORATION FORM**

Section 27 Township 2S Range 26E  
 County Morrow Date: August 10, 2017

Corner Designation: 2S26R15

Condition Report Only  
 Not found  
 Remonumented  
 Unrecorded  
 Surveyed in  
 Referenced out

Quarter corner common to sections 22 and 27, T2S, R26E, W.M., Morrow County, Oregon.

Previous Renewals / Surveys, etc.

Corner originally set by B.J. Pengra under contract No. 119 dated February 15, 1867. His record reads: Set charred stake in raised mound as 1/4 section corner. In 1912 D.V.S. Reid set a stone 14x5x2 in. marked C.S. at the position of the original corner. Reid also made four references as follows: NE 15 links, deposit of finely broken clear glass; NW - distance not given, fine stone coal; SW 15 links, piece of cast iron; SE 15 links, deposit of broken earthen ware. In 1976 Dave Krumbein established a point by single proportion but did not monument it. (See folder 329.)

Monument and Accessories found: ( condition and source )

I found the southwest reference by Reid, a broken cast iron gear with a 1/2"x6" long shaft. I also found Reid's southeast reference, pieces of broken white pottery.

**DIAGRAM**

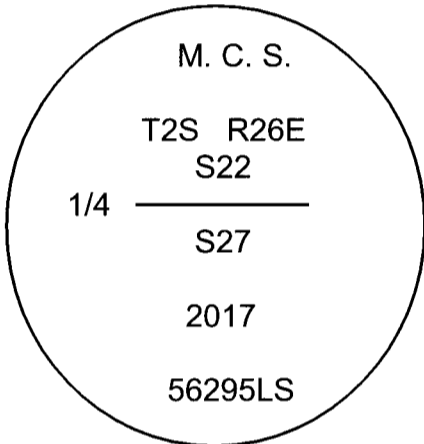

- ⊗ = Brass Cap
- = Rebar Reference
- ▣ = Reid's Bearing Object

**SKETCH**

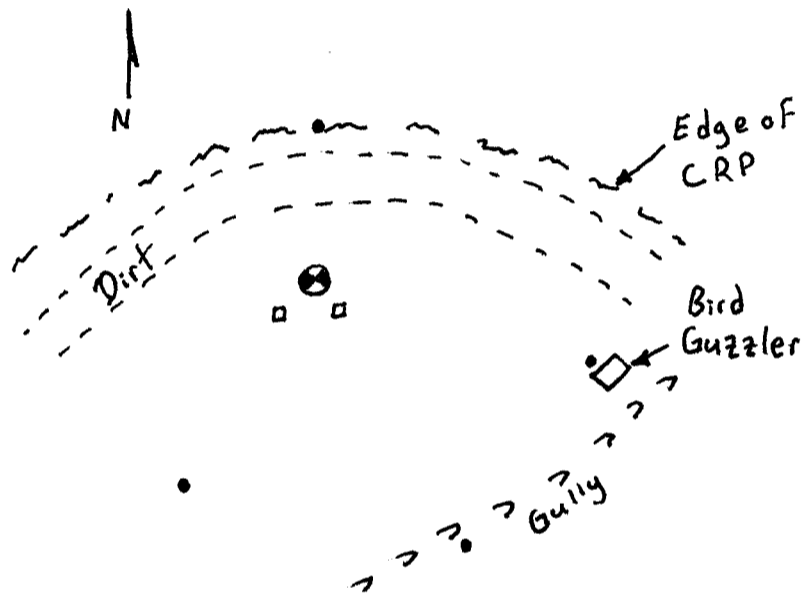

**MONUMENT (S) AND ACCESSORIES SET (Procedures and Description)**

At the original corner point identified by Reid's found references I set a 2 3/8" brass cap on a 1 1/2" x 30" galvanized iron pipe stamped as shown in the diagram above 20 inches in the ground to bedrock set in concrete.

For references, I set four 5/8" by 24" rebars with 1.25" orange plastic caps stamped WTS and 56295LS as described below:

- an iron rebar bears N01°46'53"W, 83.11 feet in the exterior berm of a CRP field;
- an iron rebar bears S75°27'08"E, 231.67 feet adjacent to the roof support of a bird guzzler.
- an iron rebar bears S27°08'48"E, 136.49 feet in the edge of a CRP field;
- an iron rebar bears S46°48'21"W, 146.20 feet flush with the surface of the ground;
- Reid's earthen ware deposit bears S42°30'57"E, 9.90 feet;
- Reid's cast iron gear bears S45°44'04"W, 9.90 feet;
- the unmonumented point from folders 329 and 429 bears N36°08'27"W 13.35 feet, more or less;

The monument and references were tied using a Trimble R7/R8 RTK GPS.

Location and comments

Compass Declination

Surveyor's Seal

RECEIVED BY:  
 Morrow County Surveyor  
 Date: 9-21-2017  
 Rec'd By: S.K.H.  
 No. 2S26R15  
 Survey No. 2017-1806D

Firm / Agency  
 Witness Tree Surveying  
 Address  
 P.O. Box G  
 Pilot Rock, Or. 97868

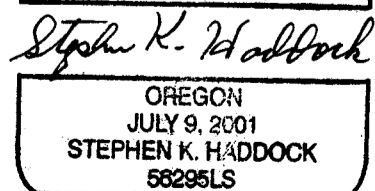
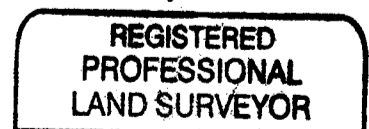

RENEWS: 6-30-19