

**OREGON CORNER RESTORATION FORM**

Section 27 Township 2S Range 26E  
 County Morrow Date: August 11, 2017

Corner Designation: 2S26R13

Corner to sections 21, 22, 27, and 28, T2S, R26E,  
 W.M., Morrow County, Oregon.

Condition Report Only  
 Not found  
 Remonumented  
 Unrecorded  
 Surveyed in  
 Referenced out

Previous Renewals / Surveys, etc.

Corner originally set by B.J. Pengra under contract No. 119 dated February 15, 1867. His record reads: Set a stone 20x12x10 inches as corner to sections 21, 22, 27 & 28. In 1914 Loy Turner set a stone 16x10x8 with two notches on the south and three notches on the east and the letters C.S. on the SE face and dug pits as per instructions. In 1974 Stephen Anderson stated "found marked stone and 1" iron pin". (See folder 375.) In 1978 David Krumbein stated "found pin". (See folder 581.) In 1980 David Krumbein remonumented this corner and set a brass cap. (See folder 429.)

Monument and Accessories found: ( condition and source )  
 The brass cap set in 1980 by David Krumbein.

**DIAGRAM**

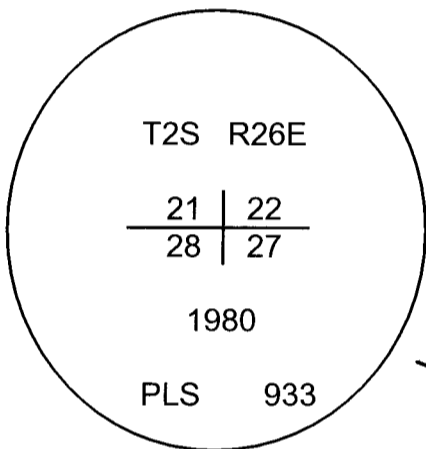

• = Rebar Reference  
 ⊙ = Brass Cap

**SKETCH  
 NTS**

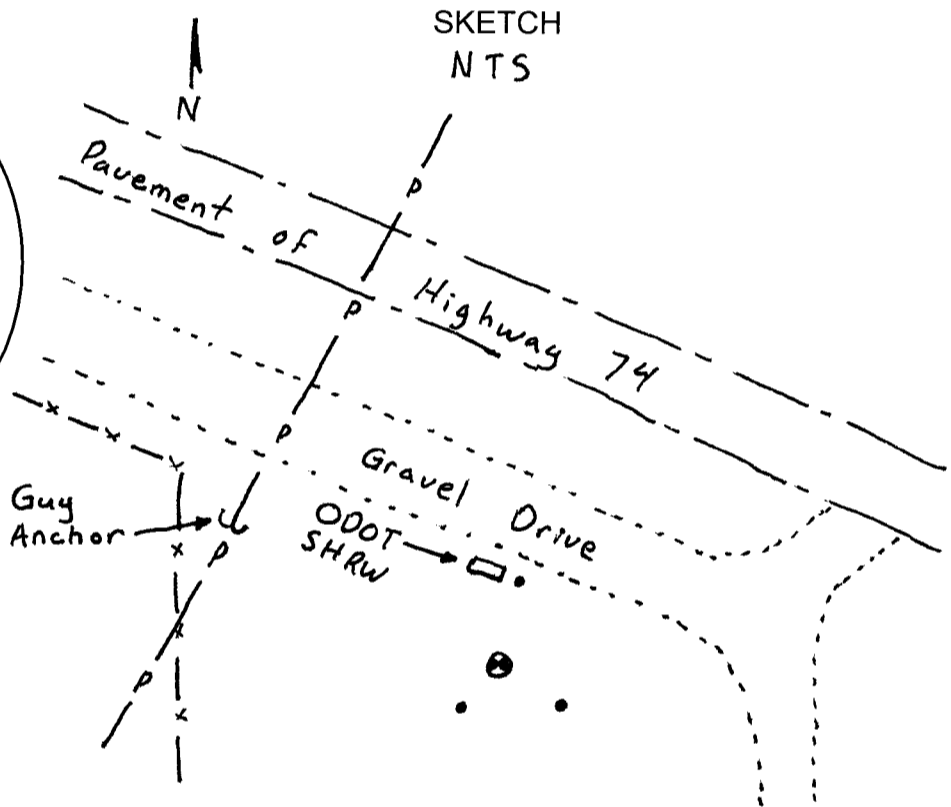

MONUMENT (S) AND ACCESSORIES SET (Procedures and Description)  
 I held the brass cap by Krumbein.

For references, I set two 5/8" by 24" rebars with 1 1/8" orange plastic caps stamped WTS and 56295LS as follows:  
 an iron rebar bears S79°22'27"E, 28.59 feet;  
 an iron rebar bears S17°06'43"W, 21.88 feet;  
 the top center of a guy anchor bears N56°13'49"W, 80.83 feet;  
 a 5/8" iron rebar on the southwesterly right of way line of Highway 74 at ODOT station 1896+37.17 PT bears N15°17'53"E, 27.64 feet;

The monument and references were tied using a Trimble R7/R8 RTK GPS.

Location and comments

Compass Declination

Surveyor's Seal

RECEIVED BY:  
 Morrow County Surveyor  
 Date: 9-21-2017  
 Rec'd By: S.K.H.  
 No. 2526 R13  
 Survey No. 2017-1806D

Firm / Agency  
 Witness Tree Surveying  
 Address  
 P.O. Box G  
 Pilot Rock, Or. 97868

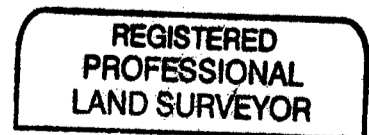

*Stephen K. Haddock*

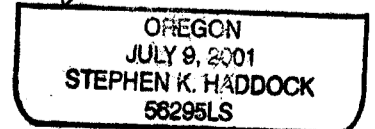

RENEWS: 6-30-19