

OREGON CORNER RESTORATION FORM

CORNER DESIGNATION: T2S, R25E, E-7

SOUTH QUARTER CORNER OF SECTION 5, TOWNSHIP 2 SOUTH, RANGE 25 EAST, W.M., MORROW COUNTY, OREGON.

PREVIOUS RENEWALS / SURVEYS, ETC.:

T2S R25E WAS ORIGINALLY SURVEYED BY U.S. DEPUTY SURVEYOR B.J. PENGRA UNDER CONTRACT NO. 119 DATED FEBRUARY 15, 1867. THE NOTES READ, "SET CHARRED STAKE IN RAISED MOUND AS 1/4 SEC. CORNER".

MONUMENT AND ACCESSORIES FOUND:

FIELD INTERSECTION N-S-E-W LEAVES UNDISTURBED DIAMOND SHAPE AREA OF LAND. AT APPARENT INTERSECTION OF FIELD LINES, DUG AND FOUND DECAYED WOOD POST LYING ON ITS SIDE. ALSO FIND GROUP OF SMALL STONES, BUNDLE OF RUSTED HARVESTER BLADES AND BITS OF BARBED WIRE. CONTINUE TO DIG AND FIND THE END OF THE POST WHERE GOING VERTICAL INTO THE GROUND. UNCOVER 2" X 2" CHARRED WOOD TIP $\pm 16"$ BELOW SURFACE WHICH I ACCEPT AS EVIDENCE OF THE ORIGINAL CHARRED WOOD POST.

MONUMENT AND ACCESSORIES SET:

OVER REMAINS OF CHARRED WOOD POST, SET 2-3/8" BRASS CAP ON 2-3/8" O.D. X 20" GALVANIZED IRON PIPE, $\pm 12"$ BELOW GRADE, MARKED AS SHOWN IN DETAIL BELOW. ESTABLISHED 4 REFERENCE MONUMENTS AS FURTHER DESCRIBED AND DETAILED BELOW.

REFERENCES:

- (A) SET 5/8" x 24" STEEL REBAR WITH 1-1/4" PINK PLASTIC CAP MARKED KENNY LS89374, $\pm 16"$ BELOW SURFACE. QUARTER CORNER BEARS S46°26'24"W, 11.19'.
- (B) SET 5/8" x 24" STEEL REBAR WITH 1-1/4" PINK PLASTIC CAP MARKED KENNY LS89374, $\pm 16"$ BELOW SURFACE. QUARTER CORNER BEARS S49°02'08"E, 9.69'.
- (C) SET 5/8" x 24" STEEL REBAR WITH 1-1/4" PINK PLASTIC CAP MARKED KENNY LS89374, $\pm 16"$ BELOW SURFACE. QUARTER CORNER BEARS N28°48'25"E, 8.79'.
- (D) SET 5/8" x 24" STEEL REBAR WITH 1-1/4" PINK PLASTIC CAP MARKED KENNY LS89374, $\pm 16"$ BELOW SURFACE. QUARTER CORNER BEARS N46°52'02"W, 10.83'.

DIAGRAM:

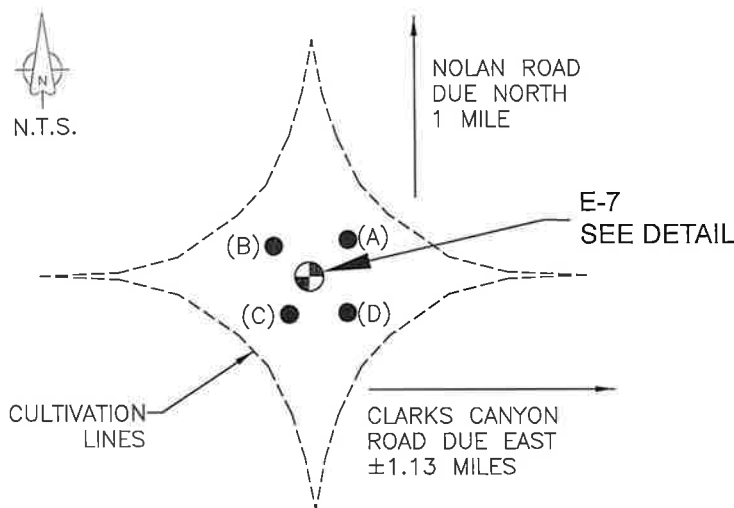

E-7 DETAIL:

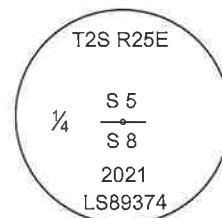

FIRM/AGENCY:

KENNY LAND SURVEYING
P.O. BOX 447 HEPPNER,
OR 97836
PARTY CHIEF: MATT KENNY

LOCATION AND COMMENTS:

CORNER IS APPROXIMATELY 1 MILE SOUTH OF NOLAN ROAD, 1.13 MILES WEST OF CLARKS CANYON ROAD, AND 1.2 MILES NORTH OF THE INT. OF SOCIAL RIDGE LANE. AND BERGE ROAD. LOCATED AT 4-WAY WHEAT FIELD INTERSECTION.

BEARING BASE:

REPORTED BEARINGS ARE GRID. NAD 83(11) OREGON NORTH STATE PLANE

REGISTERED
PROFESSIONAL
LAND SURVEYOR

OREGON
JAN 12, 2016
MATTHEW PATRICK KENNY
89374PLS

RENEWS: 6-30-21

4-27-21 BY: MPK NO: 2S 25 E7 SURV. NO: 2021-1932C