

P-9

**OREGON CORNER RESTORATION FORM**

Section 21 Township 2S Range 24E  
County Morrow Date: October 25, 2010

Corner Designation: 2S24N9

Corner to sections 16, 17, 20, and 21, T2S, R24E,  
W.M., Morrow County, Oregon.

Previous Renewals / Surveys, etc.

Corner originally set by David P. Thompson under contract #119 dated February 15, 1867.  
His record reads: Set post for corner to secs. 16, 17, 20 & 21, in mound of earth with charred stake, pits, &c. as per instructions. The road survey associated with Morrow County Road petition No. 94 says, to the corner.

Condition Report Only  
Not found \_\_\_\_\_  
Remonumented x \_\_\_\_\_  
Unrecorded \_\_\_\_\_  
Surveyed in \_\_\_\_\_  
Referenced out x \_\_\_\_\_

Monument and Accessories found: ( condition and source )

None. The position falls at the intersection of roads to the west and south and is on line with possessory lines to the north.

**DIAGRAM**

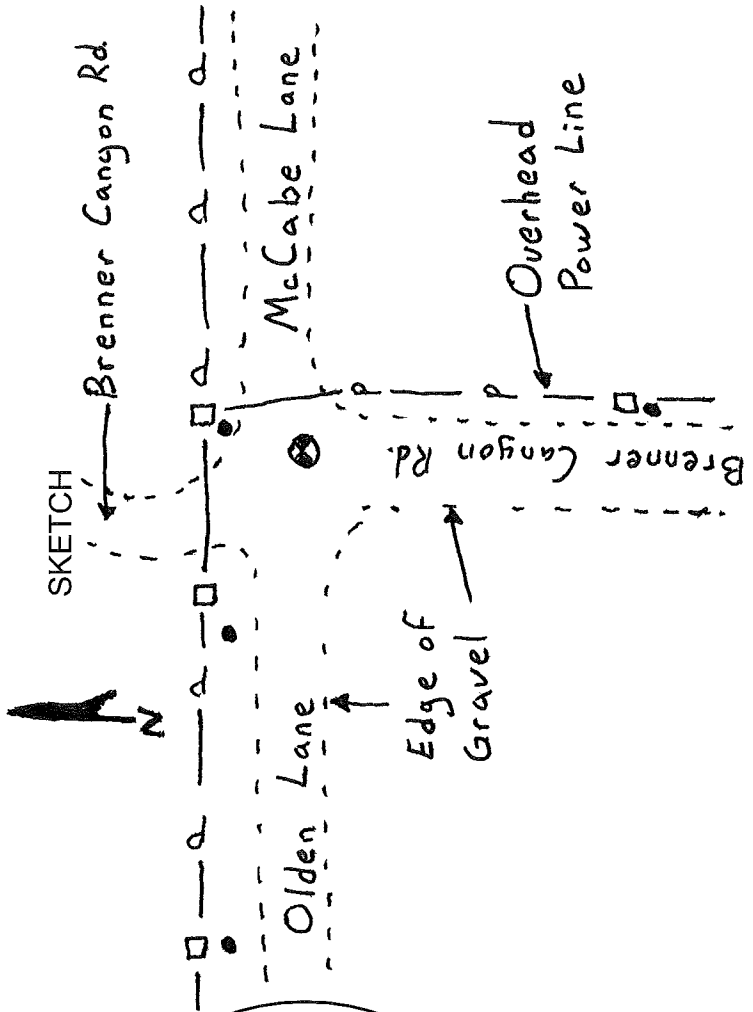
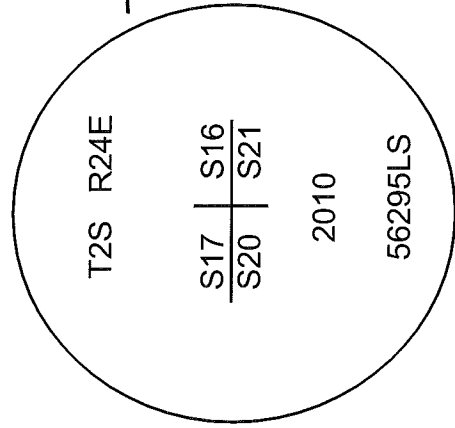

- = Brass Cap
- = Iron Rebar Reference
- = Power Pole

**MONUMENT (S) AND ACCESSORIES SET (Procedures and Description)**

At the intersection of road centerlines and the possessory line as described above, I set a 1 1/2" x 30" galvanized iron pipe with a 2 1/4" brass cap stamped as shown in the diagram above. The cap is 6" below the surface of a gravel road.

For references, I set four, 5/8" by 24" iron rebars with 1.25" orange plastic caps stamped WTS and 56295LS as described below:  
an iron rebar bears N85°24'25"W, 279.21 feet on the south side of a power pole;  
an iron rebar bears N49°50'33"W, 41.67 feet;  
an iron rebar bears N25°27'44"E, 28.53 feet on the south side of a power pole;  
an iron rebar bears S04°10'31"E, 208.75 feet on the south side of a power pole;

The monument and references were tied using a Trimble R7/R8 RTK GPS.

Location and comments

Compass Declination

Surveyors Seal

RECEIVED BY: \_\_\_\_\_  
Morrow County Surveyor  
Date: \_\_\_\_\_  
Rec'd By: \_\_\_\_\_  
No. \_\_\_\_\_

Firm / Agency  
Witness Tree Surveying  
Address  
P.O. Box G  
Pilot Rock, OR 97868  
Party Chief  
Stephen K, Haddock

REGISTERED  
PROFESSIONAL  
LAND SURVEYOR

*Stephen K. Haddock*

OREGON  
JULY 9, 2001  
STEPHEN K. HADDOCK  
56295LS

RENEWAL DATE 6-30-11

2-14-10