

# OREGON CORNER RESTORATION FORM

T2N R28E Z5

Section 31, Township 2N, Range 28E,  
County Umatilla, Date February 10, 2005.

—	Condition Report
—	Not Found
<u>X</u>	Re-monumented
—	Unrecorded
<u>X</u>	Surveyed in
<u>X</u>	Referenced out

Corner common to Sections 5 & 6, T1N and Sections 31 & 32, T2N, R28E, W.M., Umatilla County, Oregon.

Previous Renewals / Surveys, etc.

The corner was originally set by David P. Thompson under Contract No. 83 dated July 22, 1859. His record Reads: Set post for corner to Secs. 5, 6, 31, and 32, in mound of earth and c. as per instructions.

Monument and accessories found: (Condition and source)

A point with 3 decayed posts and some charcoal approximately 9 feet west of the current fence corner location. This point was identified as the corner by Mr. George Luciani who has owned this land since 1964.

DIAGRAM

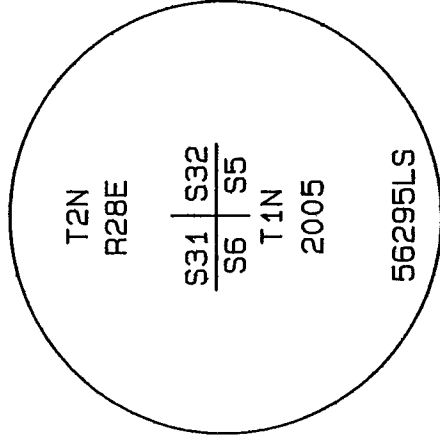

SKETCH

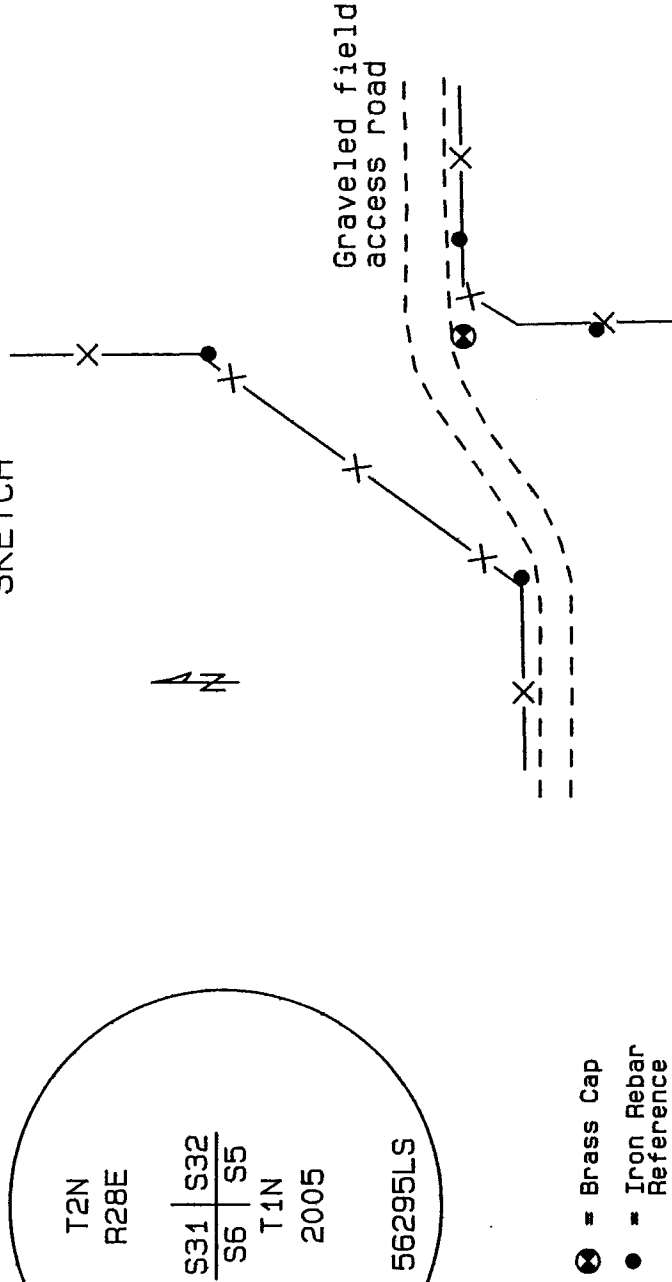

⊗ = Brass Cap  
 ● = Iron Rebar Reference

Monument and accessories set: (Procedures and description)

I set a 2 3/8" brass cap on a 30" x 2 3/8" O.D. galvanized iron pipe 12" below the surface of the ground. The cap was stamped as shown in the diagram above.

For references I set four 5/8" x 24" iron rebars with 1.25" orange plastic caps stamped WTS and 56295LS:

- an iron rebar bears N03°58'10"W 99.08 feet;
- an iron rebar bears N87°30'28"E 38.35 feet;
- an iron rebar bears S02°58'04"E 52.53 feet;
- an iron rebar bears S76°30'50"W 97.61 feet;

The monument and references were set and tied using a Trimble R7/R8 GPS system and static surveying methods. Bearings and distances are Grid.

Location and Comments  
 SPC Oregon North, NAD 83-91  
 Northing = 707,953.95 ift  
 Easting = 8,495,897.76 ift

Compass Declination

Surveyor's Seal

REGISTERED  
 PROFESSIONAL  
 LAND SURVEYOR

*Stephen K. Haddock*

OREGON  
 JULY 9, 2001  
 STEPHEN K. HADDOCK  
 56295LS

RENEWAL DATE 6-30-05

Firm / Agency  
 Witness Tree Surveying  
 P.O. Box G  
 Pilot Rock, OR 97868  
 Party Chief  
 Stephen K. Haddock, PLS

Witnessed By:

RECEIVED BY:  
Umatilla County Surveyor

Date: 5-05

Rec'd By: KR

No. 05-111-C