

OREGON CORNER RESTORATION FORM

T2N R28E Z1

Section 31, Township 2N, Range 28E,
County Umatilla, Date March 30, 2005.

—	Condition Report
—	Not Found
—	Re monumented
—	Unrecorded
<u>X</u>	Surveyed in
<u>X</u>	Referenced out

Township corner common to Townships 1 and 2 North
Ranges 27 and 28 East, W.M., Umatilla County, Oregon.

Previous Renewals / Surveys, etc.

The corner was originally set by David P. Thompson under Contract No. 83 dated
July 22, 1859. His record Reads: Set post for corner to Townships Nos. 1 and 2
North of Ranges 27 and 28 East in mound of earth &c as per instructions.

Monument and accessories found: (Condition and source)
None.

DIAGRAM

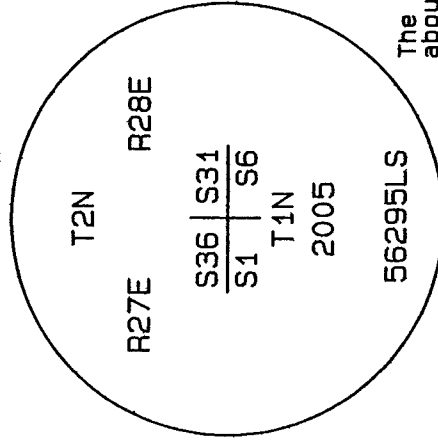

SKETCH

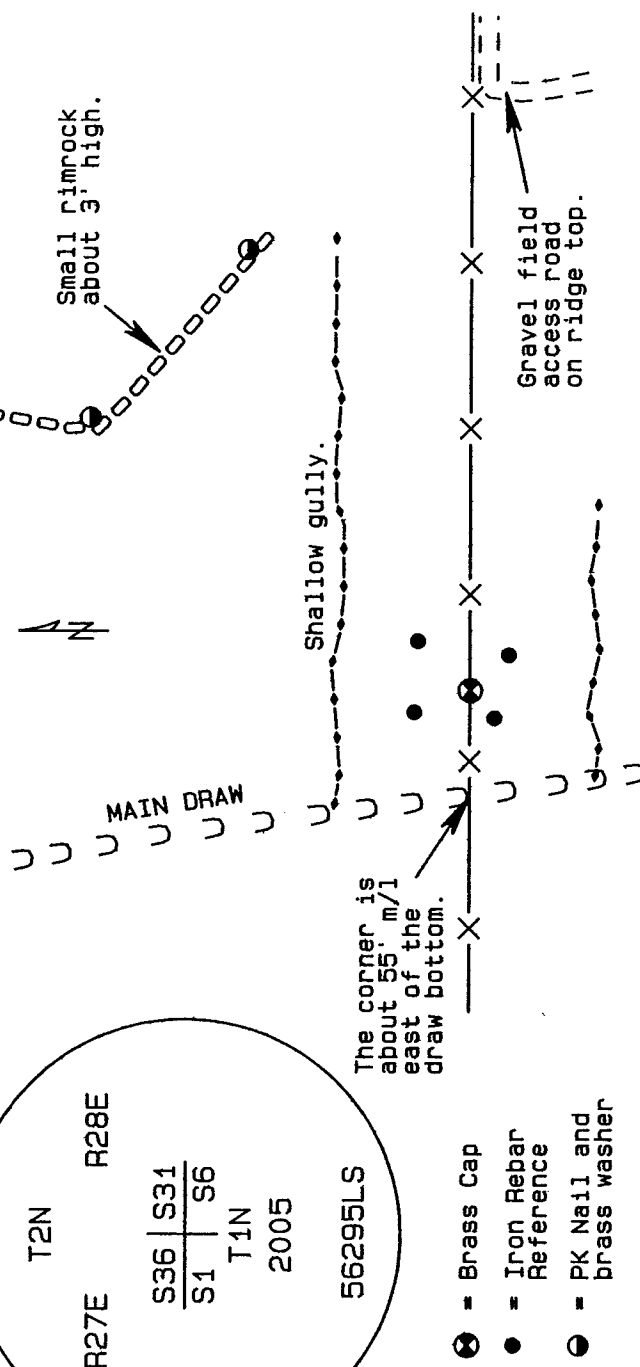

Monument and accessories set: (Procedures and description)

At the proportionate point I set 2 3/8" x 30" galvanized iron pipe with a 2 3/8" brass cap stamped as shown above 30" in the ground with a 24" collar of stone. This point falls under the existing fence. I drove a 6' steel post approximately 1 foot west with a County Monument sign attached.

For references I set four 5/8" x 24" green coated iron rebar with 1.25" orange plastic caps attached stamped WTS and 56295LS. I also set two pk nails with 1 1/2" brass washers stamped WTS and 59295LS attached under a mound of stone on top of a small rimrock that is approximately 3 feet high:
an iron rebar bears N43°15'26"E 37.56 feet approximately 18" below the surface;
an iron rebar bears N21°28'12"W 31.30 feet approximately 18" below the surface;
an iron rebar bears S49°10'05"W 19.04 feet approximately 18" below the surface;
an iron rebar bears S42°45'33"E 27.18 feet approximately 18" below the surface;
a pk nail with brass washer bears N19°30'28"E 426.58 feet;
a pk nail with brass washer bears N45°37'14"E 413.35 feet;

Control was established with a Trimble R7/R8 GPS system using static methods. The monument was set with a Trimble 5601 Robotic Total Station. Bearings and distances are grid.

Location and Comments
SPC Oregon North, NAD 83-91
Northing = 707,914.45 ift
Easting = 8,490,644.84 ift

Compass Declination

Surveyor's Seal

Witnessed By:

RECEIVED BY:
Umatilla County Surveyor

Date: 5-05

Rec'd By: AK

No. 05-111-C

Firm / Agency

Witness Tree Surveying
P.O. Box G
Pilot Rock, OR 97868
Party Chief
Stephen K. Haddock, PLS

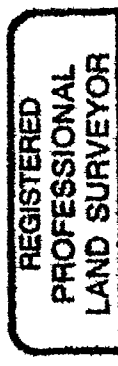

Stephen K. Haddock

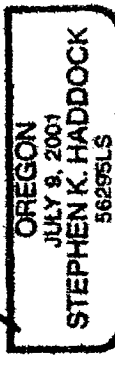

RENEWAL DATE 6-30-05