

OREGON CORNER RESTORATION FORM

SECTION 30 TOWNSHIP 2 N RANGE 25 E CORNER LOCATION CODE R-1

COUNTY MORROW DATE: 1995

CORNER DESIGNATION

NW CORNER OF SECTION 30, T 2 N,
R 25 E, W.M.

CONDITION REPORT ONLY

- NOT FOUND
- RENEWED
- UNRECORDED
- SURVEYED IN
- REFERENCED OUT

PREVIOUS RENEWALS/SURVEYS, ETC.

ORIGINAL SURVEY BY THOMPSON IN 1867, CONTRACT NO. 122.
SURVEY BY HAYES FOR BOEING IN 1965.

MONUMENTS & ACCESSORIES FOUND: Condition and Source

FOUND A 2" SHAFT WITH GEAR 0.75" BELOW SURFACE
OF ROAD SET BY HAYES IN 1965.

MONUMENT DETAIL

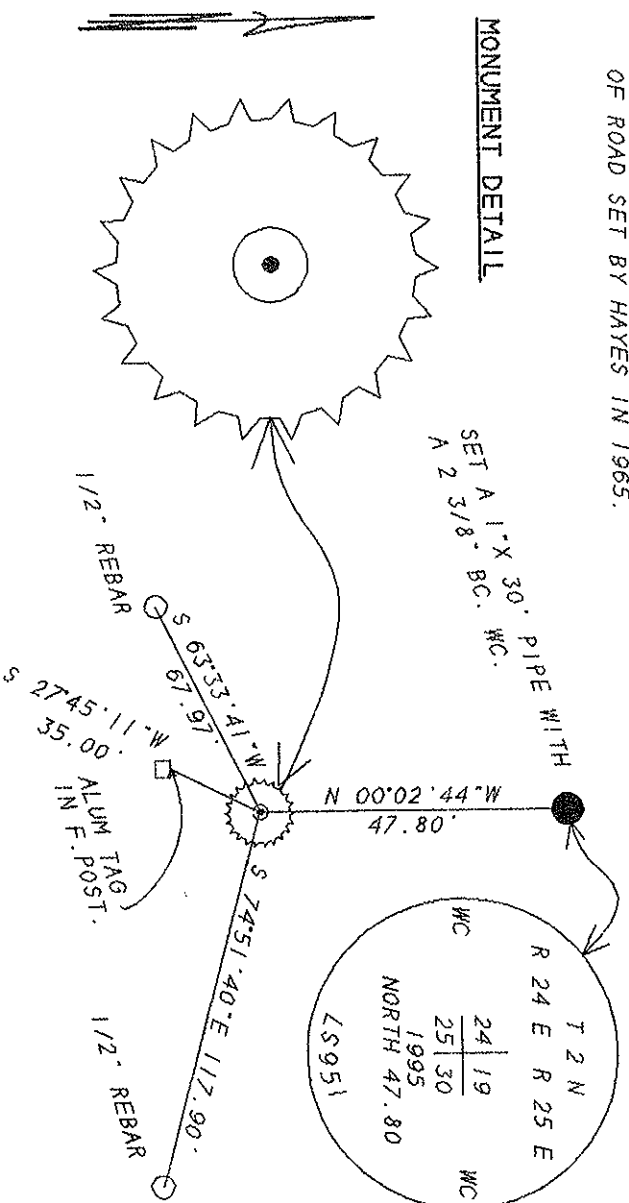

MONUMENT SET (Procedures and Description)

DID NOT SET NEW MONUMENT AT CORNER LOCATION.

NEW ACCESSORIES

SET A 1" X 30" GALVANIZED PIPE WITH A 2 3/8" BC. WC. N 0°02'44" W 47.80 FEET.
 AN ALUM TAG #951 IN A F. POST BEARS S 27°45'11" W 35.00 FEET.
 FOUND 1/2" REBAR BEARS S 63°33'41" W 67.97 FEET. (HAYES 1965) (68.00') (S 65°W)
 FOUND 1/2" REBAR BEARS S 74°51'40" E 117.90 FEET. (HAYES 1965) (118.00') (S 75° E)

LOCATION & COMMENTS

FROM THE INTERSECTION OF
WELL SPRINGS ROAD AND
IMMIGRANT ROAD GO WEST
ALONG IMMIGRANT ROAD 2 1/2
MILES TO CORNER.

SURVEYOR'S SEAL

COMPASS DEC _____
 FIRM EDWARDS SURVEYING
 P.O. BOX 763
 HERMISTON, OR. 97838
 PARTY CHIEF D. EDWARDS
 NOTES J. COPPOCK
 WITNESS J. COPPOCK

REGISTERED
 PROFESSIONAL
 LAND SURVEYOR

J. Dennis Edwards

OREGON
 JAN 16, 1871
 G. DENNIS EDWARDS
 951

RENEWALS 12/31/95

RECEIVED BY

Morrow County Surveyor

Date 2/95

Rec'd By DE

No. R-1