

CERTIFIED RECORD OF LAND CORNER MONUMENTATION

HISTORY OF ORIGINAL CORNER ESTABLISHMENT

Original corner established by David P. Thompson, Deputy Surveyor, under joint General Land Office Contract No. 122, dated June 13, 1867. Surveyor General's Records state: North between Sec.'s 7 & 8. 40.00 Set stone 18" x 7" x 7" for 1/4 Sec corner.

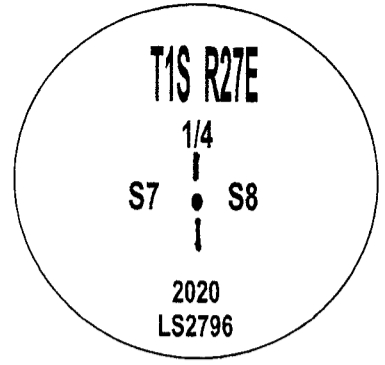

DESCRIPTION OF CORNER EVIDENCE

At assumed corner location found basalt stone 13" x 7" x 7" firmly set in ground in center of stone mound 2 feet in diameter consisting of approximately 12 stones. Stone marked with clearly visible "1/4" in upper left side of west face of stone.

CORNER MONUMENTATION

At position of found original stone, set a 5/8" x 30" long iron rod with 2" O.D. aluminum cap stamped as shown. Deposited original stone East and adjacent to cap. Raised a 2 feet diameter stone mound to cap.

SET REFERENCES

A 5/8" x 30" long iron rod with 2" O.D. aluminum cap marked "RM 1 2020 LS2796" bears North 06°37'10" East a distance of 43.00 feet; A 5/8" x 30" long iron rod with 2" O.D. aluminum cap marked "RM 2 2020 LS2796" bears North 50°07'01" West a distance of 56.17 feet; A 5/8" x 30" long iron rod with 2" O.D. aluminum cap marked "RM 3 2020 LS2796" bears South 22°59'36" West a distance of 32.35 feet; A 5/8" x 30" long iron rod with 2" O.D. aluminum cap marked "RM 4 2020 LS2796" bears South 63°51'44" East a distance of 24.46 feet. Bearings are based on GPS survey measurements and a local Transverse Mercator mapping projection.

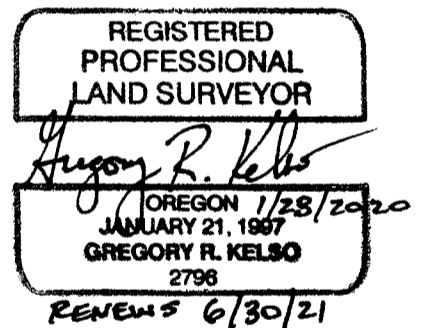

I hereby certify that the above corner monument was re-established as herein described on January 25, 2020.

Witnesses: Greg Kelso, PLS
Lisa Kelso
Cliff Dougherty

Office of Surveyor, County of Morrow, State of Oregon, I hereby certify that the within instrument was filed in this office on the 7th day of February, 2020.

Steph K. Haddock by _____
COUNTY OFFICIAL DEPUTY

1S27G5