

OREGON CORNER RESTORATION FORM

Section 33 Township 1S Range 26E
 County Morrow Date: January 3, 2020

Corner Designation: 1S26X13

Condition Report Only
 Not found

1/4 corner common to sections 33 and 34 T1S, R26E,
 W.M., Morrow County, Oregon.

Remonumented
 Unrecorded
 Surveyed in
 Referenced out

Previous Renewals / Surveys, etc.

Corner was originally set by B.J. Pengra under contract No. 119 Dated February 16, 1867.
 His record reads: Set a stone 12x8x6 inches as 1/4 Section Corner.

Monument and Accessories found: (condition and source)

A long standing fence and occupation line with fence lines and field berms north, south and east.

DIAGRAM

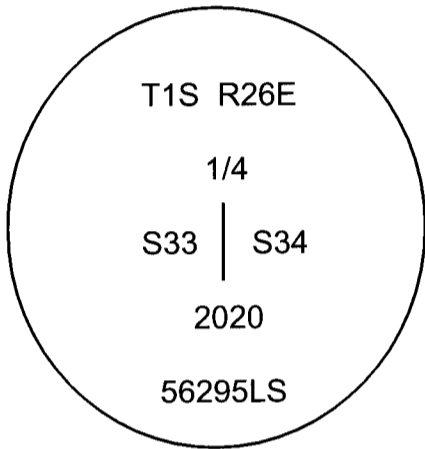

- = Rebar reference.
- ⊗ = 1" Iron Rebar w/ 2" Aluminum cap.

SKETCH
 N. T. S.

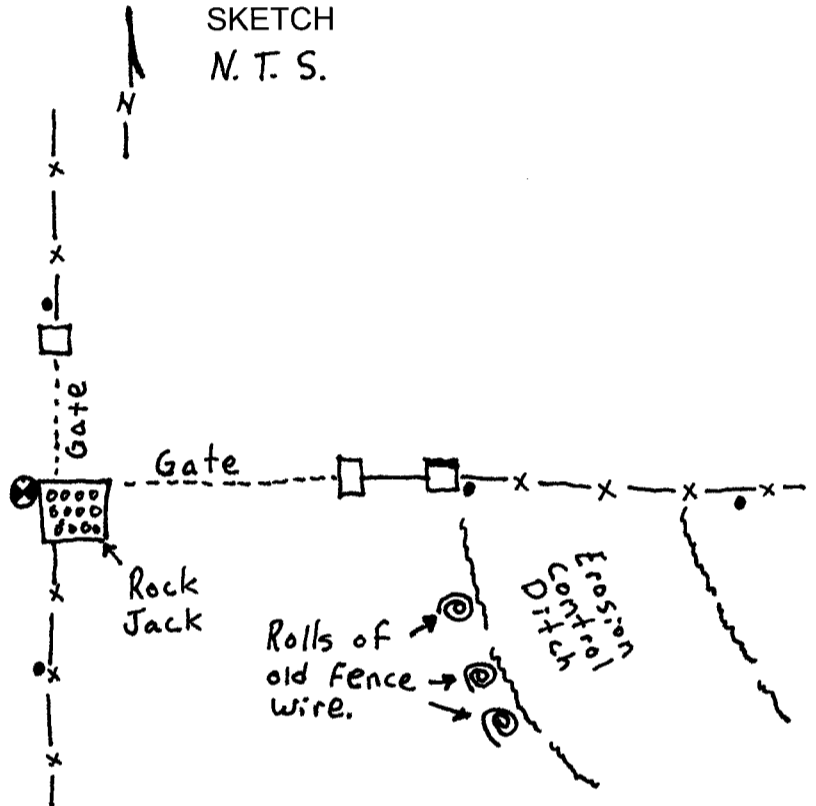

MONUMENT (S) AND ACCESSORIES SET (Procedures and Description)

At the fence corner as identified above I set a 1" x 24" iron rebar flush with the surface of the ground and attached a 2" aluminum cap stamped as shown in the diagram above.

For references, I set four 5/8" by 24" rebars with 1.25" orange plastic caps stamped WTS and 56295LS as described below:

- a rebar bears N00°11'15"W, 16.86 feet on the west side of the fence;
- a rebar bears S01°04'38"W, 27.91 feet on the west side of the fence;
- a rebar bears S88°28'10"E, 32.05 feet on the south side of the fence;
- a rebar bears S89°30'20"E, 75.03 feet on the south side of the fence;

Measurements to the cap and references were made with a Trimble RTK GPS system.

Location and comments
 Witnessed by:

Compass Declination

Surveyors Seal

RECEIVED BY:
Morrow County Surveyor
 Date: 1-4-2020
 Rec'd By: S.K.H.
 No. 1526 X 13
 Survey No. 1880

Firm / Agency
 Witness Tree Surveying
 Address
 P.O. Box G
 Pilot Rock, Or. 97868
 Party Chief
 Stephen K. Haddock, PLS

REGISTERED
 PROFESSIONAL
 LAND SURVEYOR

Stephen K. Haddock

OREGON
 JULY 9, 2001
 STEPHEN K. HADDOCK
 56295LS

RENEWS: 6-30-21