

OREGON CORNER RESTORATION FORM

Section 10 Township 1S Range 26E
 County Morrow Date: June 2, 2018

Corner Designation: 1S26E17

Condition Report Only

Not found
 Remonumented
 Unrecorded
 Surveyed in
 Referenced out

Corner common to sections 2, 3, 10, and 11, T1S, R26E, W.M., Morrow County, Oregon.

Previous Renewals / Surveys, etc.

The corner was originally set by B.J. Pengra under contract 119 dated February 18, 1867. His record reads: Set charred stake and raised mound as corner to sections 2, 3, 10, & 11.

Monument and Accessories found: (condition and source)

A long term east - west plow berm and scattered stones indicating an old fence corner.

DIAGRAM

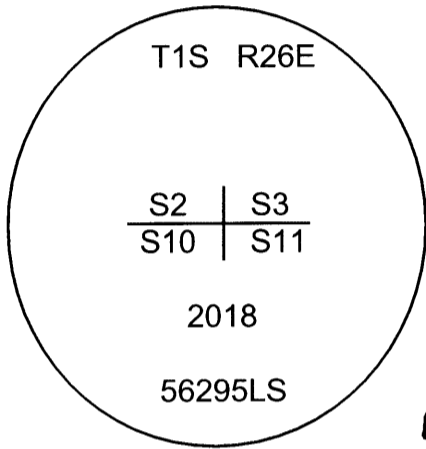

SKETCH

N.T.S.

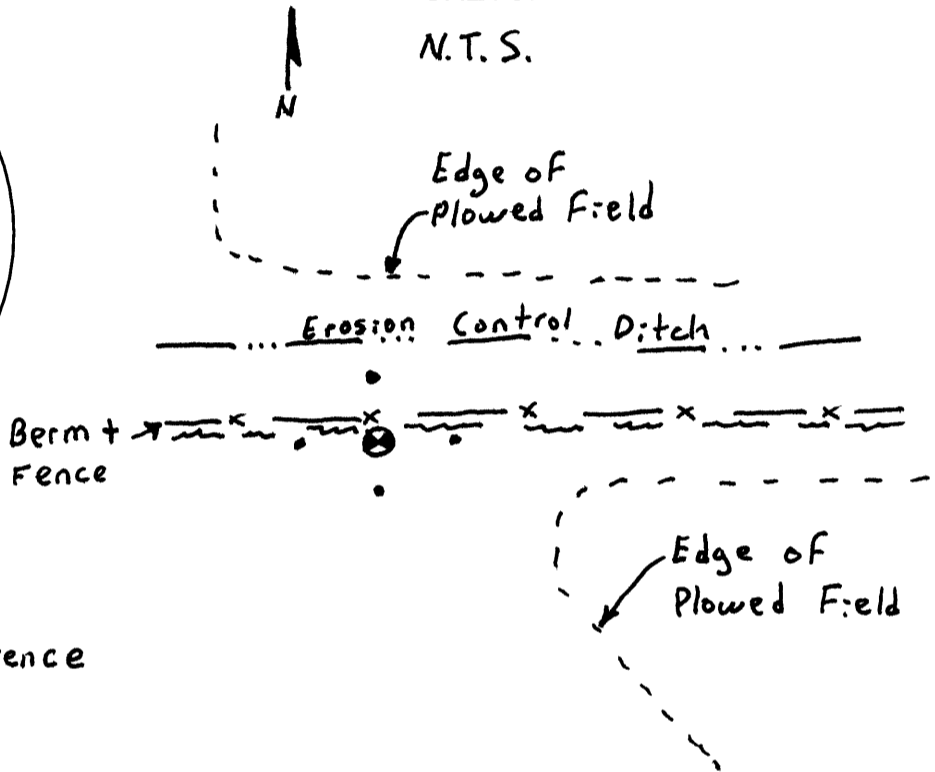

- ⊗ = Set Brass Cap
- = Set Rebar Reference

MONUMENT (S) AND ACCESSORIES SET (Procedures and Description)

I held the existing fence and plow berm for latitude and proportioned the departure.

For references, I set four, 5/8" by 24" rebars with 1.25" orange plastic caps stamped WTS and 56295LS as described below:

- an iron rebar bears N00°04'28"W, 23.20 feet 12 inches below the surface;
- an iron rebar bears N86°36'17"W, 24.58 feet;
- an iron rebar bears N86°59'35"E, 27.19 feet;
- an iron rebar bears S01°37'08"W, 24.51 feet 12 inches below the surface;

Measurements were made with a Trimble RTK GPS.

Location and comments

Witnessed by:

Compass Declination

Surveyors Seal

RECEIVED BY:

Morrow County Surveyor
 Date: 6-5-2018
 Rec'd By: S.K.H.
 No. 1S26E17
 Survey No. 2018-1829C

Firm / Agency
 Witness Tree Surveying
 Address
 P.O. Box G
 Pilot Rock, Or. 97868
 Party Chief

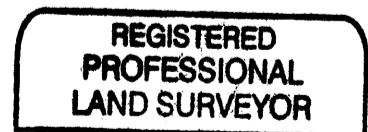

Stephen K. Haddock

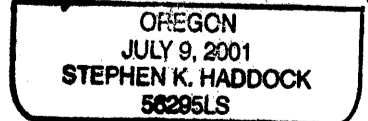

RENEWS: 6-30-19