

OREGON CORNER RESTORATION FORM

Section 28 Township 1S Range 25E
County Morrow Date: September 3, 2015

Corner Designation: 1S25V11

Condition Report Only
Not found _____
Remonumented X
Unrecorded _____
Surveyed in _____
Referenced out X

Quarter corner common to sections 28 and 33, T1S, R25E, W.M., Morrow County, Oregon.

Previous Renewals / Surveys, etc.

Corner originally set by B.J. Pengra under contract No. 119 dated February 15, 1867. His record reads: Drove charred stake and raised mound as 1/4 Sec. Corner. In survey 1451, Jud Coppock said: Set brass cap from evidence although, his data indicate it was by proportion.

Monument and Accessories found: (condition and source)
A fence corner with fences running west and south and a scattered stone mound.

DIAGRAM

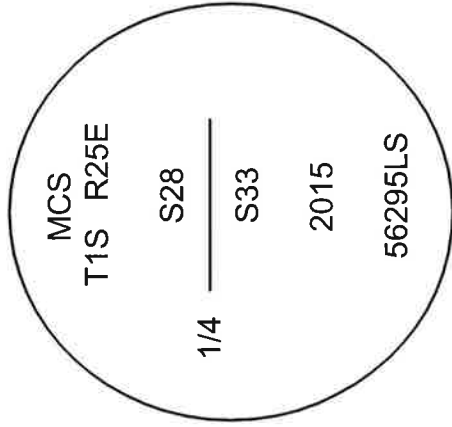

- = Brass Cap
- = Rebar Reference

SKETCH

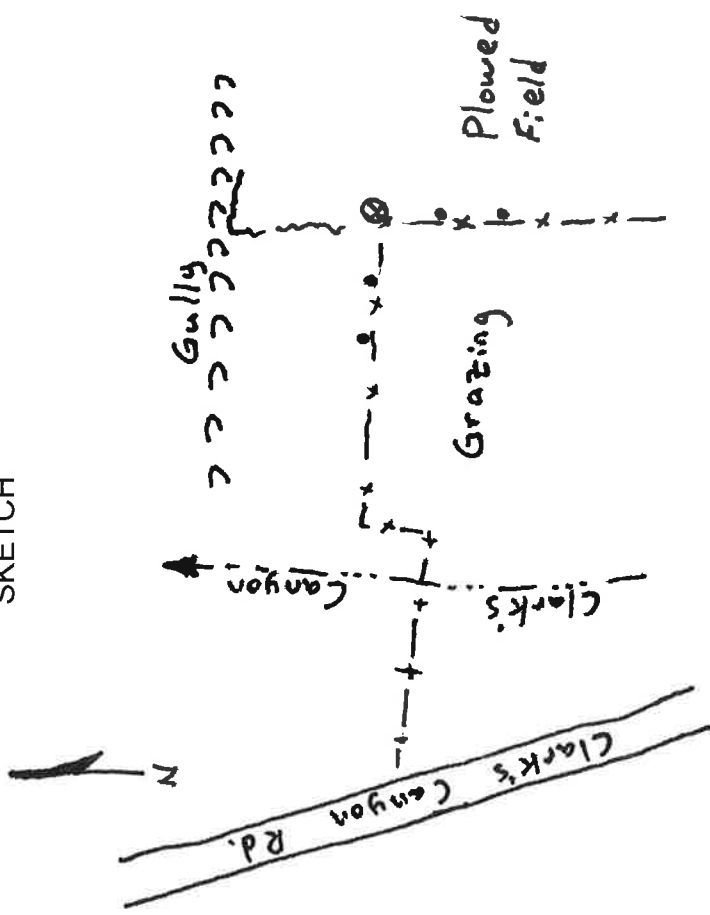

MONUMENT (S) AND ACCESSORIES SET (Procedures and Description)

At the fence corner I set a 2 1/2" brass cap on a 1 1/2" x 30" galvanized iron pipe 30 inches in the ground stamped as shown in the diagram above.

For references I set four, 5/8" by 24" rebars with 1 1/8" orange plastic caps attached, stamped WTS and 56295LS as described below:
an iron rebar bears S89°10'33"W, 80.42 feet under the existing fence;
an iron rebar bears S89°10'45"W, 39.30 feet under the existing fence;
an iron rebar bears S0°46'21"W, 33.99 feet under the existing fence;
an iron rebar bears S0°20'29"W, 69.84 feet under the existing fence;

The monument and references were tied using a Trimble R7/R8 RTK GPS.

Location and comments

Witnessed By:
David Quittschreiber

Compass Declination

Surveyors Seal

RECEIVED BY:

Morrow County Surveyor

Date: 9-28-2015

Rec'd By: S.K.H.

No. 1S25V11

Survey No. 2015-1748C

Firm / Agency
Morrow County Surveyor

Address
P.O. Box G

Pilot Rock, Or. 97868

Party Chief
Kristina Powell

**REGISTERED
PROFESSIONAL
LAND SURVEYOR**

Stephen K. Haddock

OREGON
JULY 9, 2001
STEPHEN K. HADDOCK
56295LS

RENEWS: 6-30-17