

OREGON CORNER RESTORATION FORM

Section 27 Township 1S Range 25E
County Morrow Date: September 2, 2015

Corner Designation: 1S25T15

Condition Report Only
Not found
Remonumented
Unrecorded
Surveyed in
Referenced out
X

Center quarter corner to section 27, T1S, R25E,
W.M., Morrow County, Oregon.

Previous Renewals / Surveys, etc.

Corner originally set by David Krumbein in survey D-623-K-624. His record reads: Brass cap set.

Monument and Accessories found: (condition and source)
The brass cap set by Krumbein in good condition.

DIAGRAM

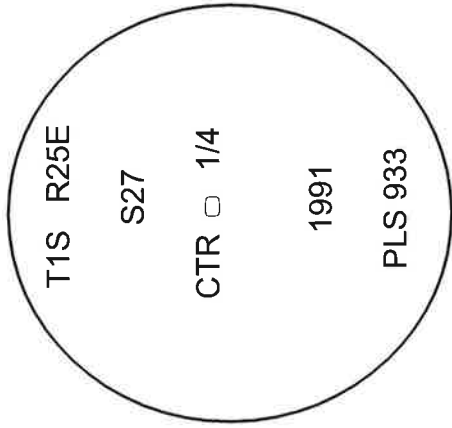

⊗ = Brass Cap
● = Rebar References

SKETCH

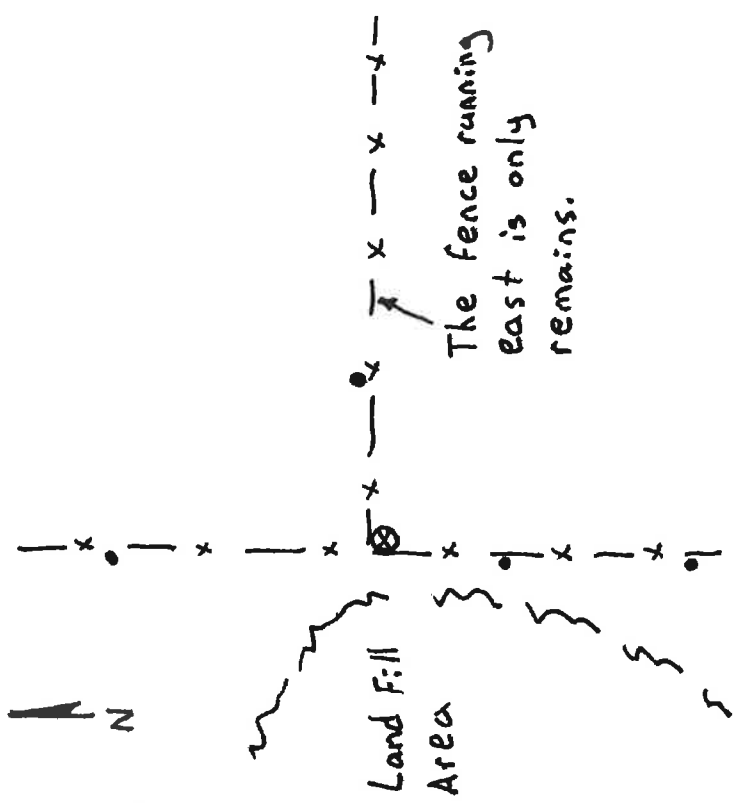

MONUMENT (S) AND ACCESSORIES SET (Procedures and Description)
I held the brass cap set by Krumbein.

For references I set four, 5/8" by 24" rebars with 1 1/8" orange plastic caps attached, stamped WTS and 56295LS as described below:
an iron rebar bears S0°34'04"E, 65.25 feet;
an iron rebar bears S2°06'30"W, 22.32 feet;
an iron rebar bears N0°25'20"E, 95.81 feet;
an iron rebar bears N89°45'24"E, 38.02 feet;

The monument and references were tied using a Trimble R7/R8 RTK GPS.

Location and comments

Witnessed By:

Brenda Johnson

David Quittschreiber

Compass Declination

Firm / Agency

Morrow County Surveyor

Date: 9-28-15

Rec'd By: S.K.H.

No. 1S25T15

Survey No. 2015-1748C

Morrow County Surveyor

Address

P.O. Box G

Pilot Rock, Or. 97868

Party Chief

Kristina Powell

Surveyors Seal

REGISTERED
PROFESSIONAL
LAND SURVEYOR
Stephen K. Haddock
OREGON
JULY 9, 2001
STEPHEN K. HADDOCK
56295LS
RENEWS: 6-30-17