

OREGON CORNER RESTORATION FORM

Section 22 Township 1S Range 25E
County Morrow Date: September 3, 2015

Corner Designation: 1S25P17

Condition Report Only
Not found _____
Remonumented x
Unrecorded _____
Surveyed in _____
Referenced out x

1/4 corner common to sections 22 and 23 T1S, R25E,
W.M., Morrow County, Oregon.

Previous Renewals / Surveys, etc.

Corner was originally set by B.J. Pengra under contract No. 119 Dated February 16, 1867.
His record reads: Drove charred stake and raised mound as per instructions for 1/4 Sec. Corner.

Monument and Accessories found: (condition and source)

Held the intersection of the north south centerline of Highway 207 and a plow berm running east.

DIAGRAM

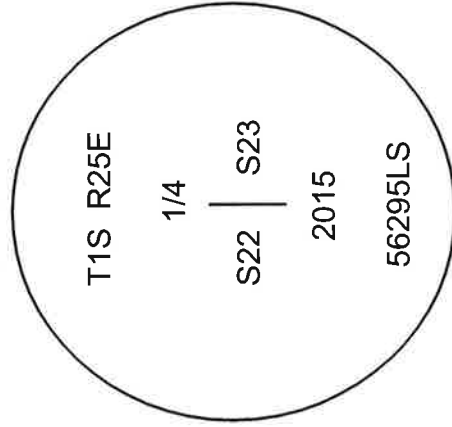

SKETCH

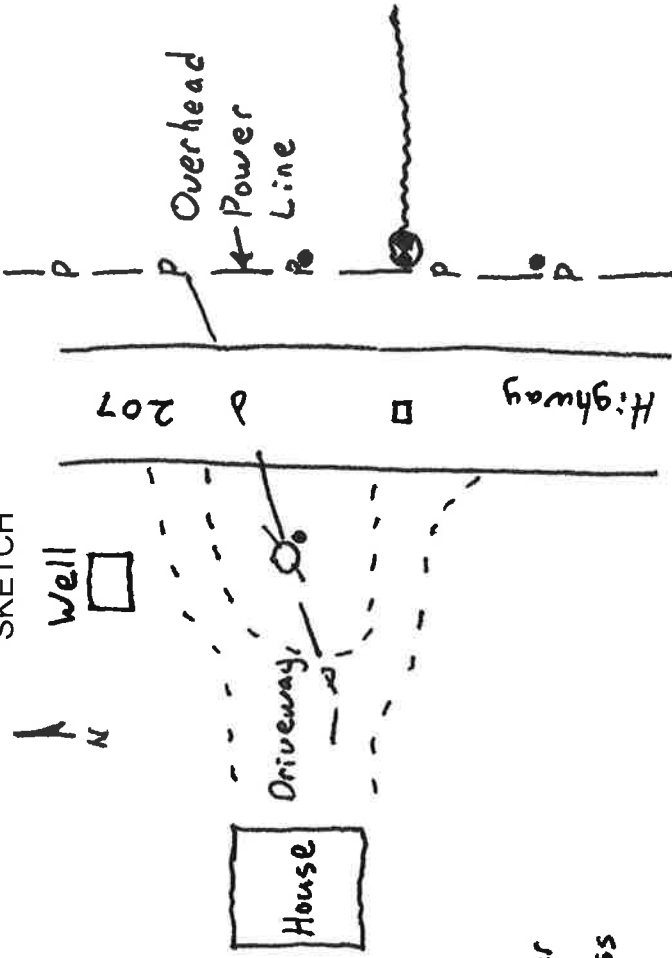

- = PK Nail and Stainless steel washer
- = Brass Capped Witness Monument.
- = Rebar Reference

MONUMENT (S) AND ACCESSORIES SET (Procedures and Description)

At the position determined as stated above I set a PK nail with a 2" stainless steel washer stamped as shown in the diagram above.

For references, I set three 5/8" by 24" rebars with 1.25" orange plastic caps stamped WTS and 56295LS as described below:

- a rebar bears N37°27'10"W, 54.01 feet at the base of a power pole;
- a rebar bears N37°58'22"E, 48.17 feet;
- a rebar bears S46°49'44"E, 40.25 feet;

I also set a 2 1/2" brass cap on a 1 1/2"x30" galvanized iron pipe flush with the surface as a witness monument to the corner. The brass cap bears N89°56'30"E 30.00 feet.

Measurements to the cap and references were made with a Trimble RTK GPS system.

Location and comments
Witnessed by:
David Quittschreiber

Compass Declination

Surveyors Seal

RECEIVED BY:

Morrow County Surveyor

Date: 9-28-2015

Rec'd By: S.K.H.

No. 1S25P17

Survey No. 2015-1748C

Firm / Agency
Morrow County Surveyor
Address
P.O. Box G
Pilot Rock, Or. 97868
Party Chief
Kristina Powell

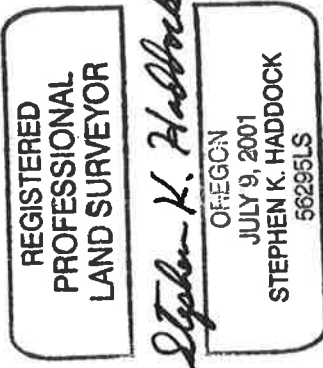

RENEWALS: 6-30-17