

OREGON CORNER RESTORATION FORM

SECTION 10

TOWNSHIP 1 SOUTH

RANGE 24 EAST

COUNTY: MORROW

DATE: 7/07/2022

CORNER DESIGNATION: J-17

PREVIOUS RENEWALS / SURVEYS, etc.

1865: ORIGINAL GLO SURVEY, U.S. DEPUTY SURVEYOR DAVID P. THOMPSON SET A STONE 18x10x10 FOR CORNER OF SECTIONS 10, 11, 14 & 15.

1979: MORROW COUNTY SURVEY 2015-1744C, W.E. GILLESPIE FOUND "STONE MON"

MONUMENT and ACCESSORIES FOUND: (CONDITION AND SOURCE)

2022: FOUND 16"x10"x8" STONE ±7" IN THE GROUND ON EAST FACING SLOPE IN MOUND OF STONE

(SEE MORROW COUNTY SURVEY 2022-1994C)

DIAGRAM:

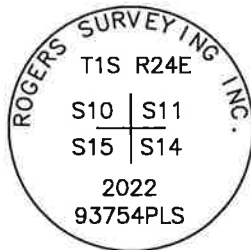

MONUMENT and ACCESSORIES SET (PROCEDURES and DESCRIPTION)

REMONUMENTED STONE WITH A 3-1/4" ALUMINUM CAP ON 2-1/4"x30" ALUMINUM PIPE, SET ±22" IN THE GROUND STAMPED AS SHOWN ABOVE. BURIED STONE ±1' NORTH, SET CARSONITE ±1' WEST

(SEE MORROW COUNTY SURVEY 2022-1994C)

REFERENCES SET:

RP-1 SET 5/8"x24" REBAR WITH RED PLASTIC CAP STAMPED "RSI CONTROL" N7°31'31"E 10.91 FEET
RP-2 SET 5/8"x24" REBAR WITH RED PLASTIC CAP STAMPED "RSI CONTROL" S54°34'53"E 31.34 FEET
RP-3 SET 5/8"x24" REBAR WITH RED PLASTIC CAP STAMPED "RSI CONTROL" S21°36'33"E 28.55 FEET
RP-4 SET 5/8"x24" REBAR WITH RED PLASTIC CAP STAMPED "RSI CONTROL" N88°22'17"W 8.62 FEET

LOCATION and COMMENTS

CORNER IS LOCATED APPROXIMATELY 15 FEET NORTHWEST OF BOTTOM OF RAVINE AND 100 FEET SOUTHEAST OF EDGE OF FIELD

SURVEYORS SEAL

REGISTERED
PROFESSIONAL
LAND SURVEYOR

OREGON
MARCH 09, 2021
BRENTON A. GRIFFIN
93754PLS

RENEWS: 06/30/2023

7/7/22

RECEIVED BY:

MORROW COUNTY SURVEYOR

DATE 8-11-2022

REC'D BY: MPK

NO. 1524517

FIRM / AGENCY

ROGERS SURVEYING, Inc., P.S.
1455 COLUMBIA PARK TRAIL, #201
RICHLAND, WA 99352
(509) 783-4141