

# CORNER RESTORATION FORM

Township 1 SOUTH Range 24 EAST Section 4 County MORROW

State OREGON Date 02/07/03 Number C-12

Corner Designation : CE1/16 CORNER SEC. 4

- Condition Report Only
- Not Found
- Renewed
- Surveyed In
- Referenced

Previous Renewals \_\_\_\_\_

Monument (s) Found: (Condition and Source)

ORIGINAL CORNER WAS ESTABLISHED BY D.P. THOMPSON IN  
1865 UNDER CONTRACT No. 109, WHICH WAS A STANDARD  
LOCATION BY SURVEY, NO MONUMENT WAS SET.

### MONUMENT DETAIL

Found  Set

Accessories Found:

NONE

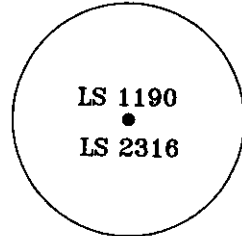

SET 5/8"  $\phi$  X 30" REBAR WITH YELLOW PLASTIC CAP.

Monument & Accessories Set (Procedure and Description)

SET 5/8" X 30" REBAR AND CAP 0.60' ABOVE GROUND BY SURVEY.

SET PK NAIL IN FENCE POST 9.76 FEET WEST OF CORNER.

SET PK NAIL IN FENCE CORNER POST 23.72 FEET SOUTHWEST OF CORNER.

### Sketch of Monument, Accessories and General Area

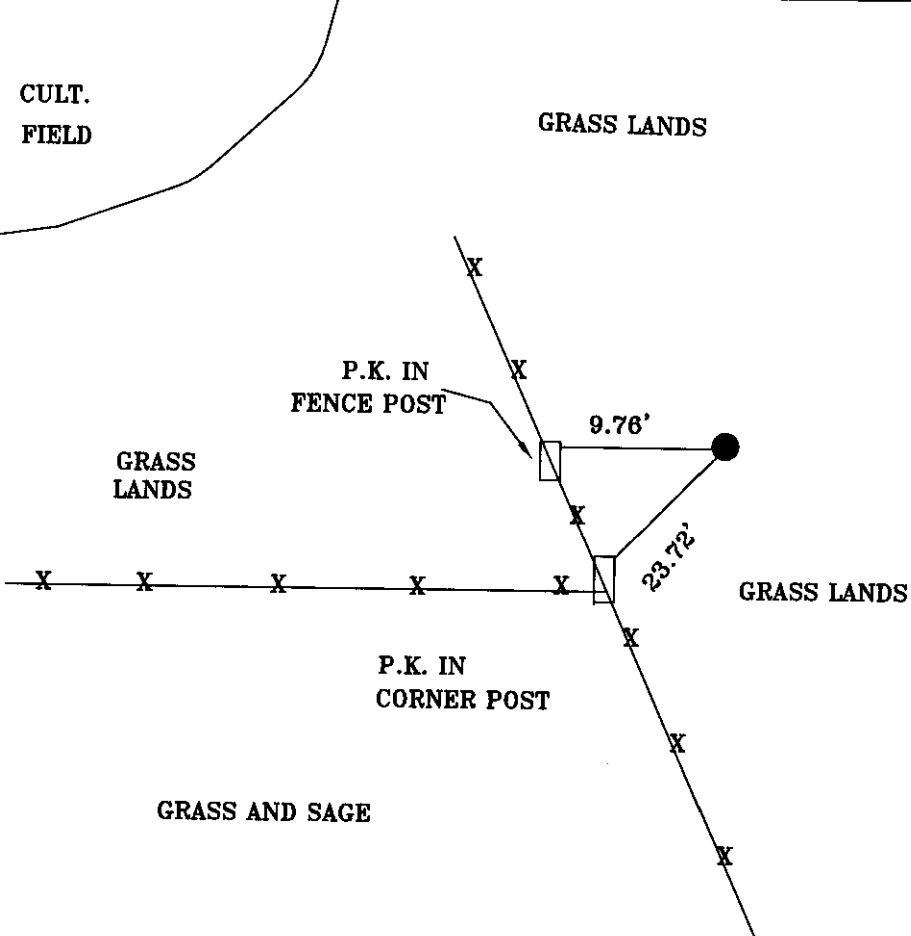

**REGISTERED PROFESSIONAL LAND SURVEYOR**

*Danny K. Cummings*

**OREGON**  
**JAN. 21, 1988**  
**DANNY K. CUMMINGS**  
**2316**

**RENEWS: 12/31/2015**

Agency: CK3, LLC  
368 SW 5TH AVE  
ONTARIO, OR

Party Chief DAN CUMMINGS

Notekeeper L. KING

Witness(s) LANCE KING

Field Book 0-199

Client MONTY CRUM

Job # S0-02020

**COUNTY SURVEYOR RECORDING INFO**

Received \_\_\_\_\_

Filed \_\_\_\_\_

Survey No. \_\_\_\_\_

Index No. C-12