

OREGON CORNER RESTORATION FORM

COUNTY: Morrow DATE: 05/08/2018

CORNER DESIGNATION: V-15, The South Quarter Corner of Section 27, Township 1 South, Range 23 East, Willamette Meridian.

PREVIOUS RENEWALS/SURVEYS ETC.: Original corner set by D. P. Thompson under General Land Office Contract No. 109, dated January 30, 1865. The notes state; set a stone 15x15x5 for 1/4 Section Corner.

MONUMENT AND ACCESSORIES FOUND: Found 15"x15"x8" irregular shaped and very porous stone laying flat, buried 4" below ground level, 1.0 foot East of the buried end of an old locust H-Brace fence corner post. No visible marks could be located on the stone, however it is of correct size and it is the only stone in the area of the corner. The fence corner posts' top is leaning Westerly with H-Braces extending North and East. A farmed field berm extends North and East from the fence corner post.

MONUMENT MARKING DETAIL:

T1S R23E
1 S27
4 S34
2018
OPLS 54657

RECEIVED BY
Morrow County Surveyor
Date: 5-22-2018
Rec'd By: S.K.H.
No.: 1523V15
Folder No.: _____

MONUMENT SET: At the center point of the found stone, set a 2 3/8" diameter brass cap on a 1 1/4"x30" galvanized iron pipe with the top of the cap flush with the ground surface. Buried the found stone on the West side of the brass cap monument next to the locust fence corner post. Monument marked as shown in "Monument Marking Detail".

From which:

A 5/8"x30" iron rebar with 1 1/4" diameter blue plastic cap marked "Wells Surveying PLS 54657" with the top buried 22" below ground level in a CRP field bears: North 59°45' East a distance of 25.5 feet.

A 5/8"x30" iron rebar with 1 1/4" diameter blue plastic cap marked "Wells Surveying PLS 54657" with the top buried 22" below ground level in a farmed field bears: South 39°21' East a distance of 29.8 feet.

A 5/8"x30" iron rebar with 1 1/4" diameter blue plastic cap marked "Wells Surveying PLS 54657" with the top buried 22" below ground level in a farmed field bears: South 59°18' West a distance of 36.4 feet.

A 5/8"x30" iron rebar with 1 1/4" diameter blue plastic cap marked "Wells Surveying PLS 54657" with the top buried 22" below ground level in a farmed field bears: North 50°09' West a distance of 38.0 feet.

Wired Bearing Objects signs to all buried rebar. Nailed Witness Post sign to the locust post 1.0 foot West of the brass cap monument.

LOCATION AND COMMENTS: Corner is located at a fence corner post in a farmed field.

APPROXIMATE SEARCH COORDINATES: (NAD 83/91, Oregon North Zone).

NORTH = 648621, EAST = 8347549

FIRM: Wells Surveying
P.O. Box 1696
Pendleton, OR 97801

COMPASS DECLINATION: 18° East

/1S23EV15

Surveyor's Seal

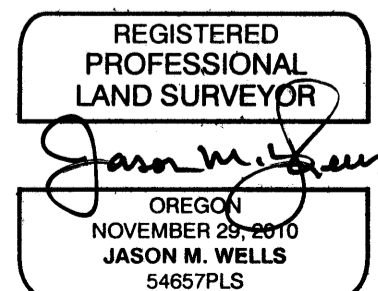

RENEWS: 6:30:18