

OREGON CORNER RESTORATION FORM

Section 10 Township 1S Range 23E
 County Morrow Date: April 16, 2019

Corner Designation: 1S23G17

1/4 corner common to sections 10 and 11 T1S, R23E,
 W.M., Morrow County, Oregon.

Condition Report Only
 Not found
 Remonumented
 Unrecorded
 Surveyed in
 Referenced out

Previous Renewals / Surveys, etc.

Corner was originally set by David P. Thompson under contract No. 109 Dated January 30, 1865. His record reads: Set post for 1/4 section corner in mound of earth with charred stake, pits & c. as per instructions.

Monument and Accessories found: (condition and source)

Found a corner in the field lines with plow lines running north and west with remains of fences.

DIAGRAM

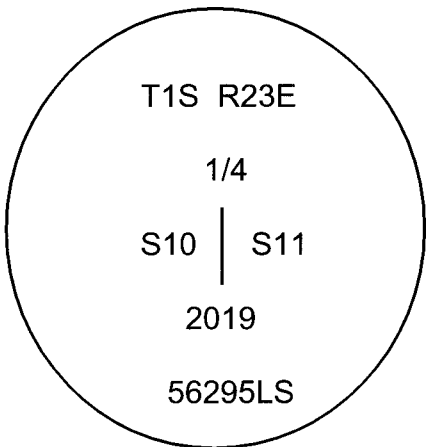

- = Fence post.
- = Bearing object.
- ⊙ = Set Brass cap.

SKETCH

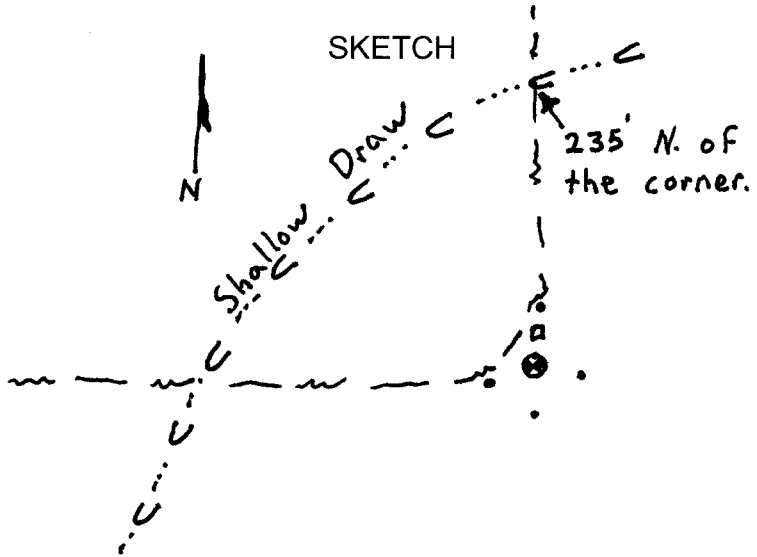

MONUMENT (S) AND ACCESSORIES SET (Procedures and Description)

At the corner point I set a 2 3/8" brass cap on a 1 1/2"x30" galvanized iron pipe 30 inches in the ground. The cap was stamped as shown in the diagram above. I set a fence post 12" diameter by 8 feet long 3 feet in the ground on the north side of the cap with a Morrow County monument sign attached.

For references, I set four 5/8" by 24" rebars with 1.25" orange plastic caps stamped WTS and 56295LS as described below:

- a rebar bears N1°30'46"W, 24.26 feet, 20 inches below the surface;
- a rebar bears N83°28'32"E, 27.20 feet, 20 inches below the surface;
- a rebar bears S0°20'19"E, 27.27 feet, 20 inches below the surface;
- a rebar bears S84°16'29"W, 26.15 feet, 20 inches below the surface;

Measurements to the cap and references were made with a Trimble RTK GPS system.

Location and comments

Witnessed by:

RECEIVED BY:

Morrow County Surveyor

Date: 5-27-2019

Rec'd By: S.K.H.

No. 1S23G17

Survey No. _____

Compass Declination

Firm / Agency

Witness Tree Surveying

Address

P.O. Box G

Pilot Rock, Or. 97868

Party Chief

Stephen K. Haddock

Surveyors Seal

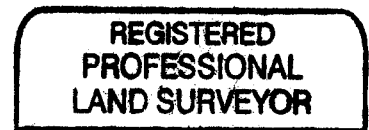

Stephen K. Haddock



RENEWS: 6-30-21